

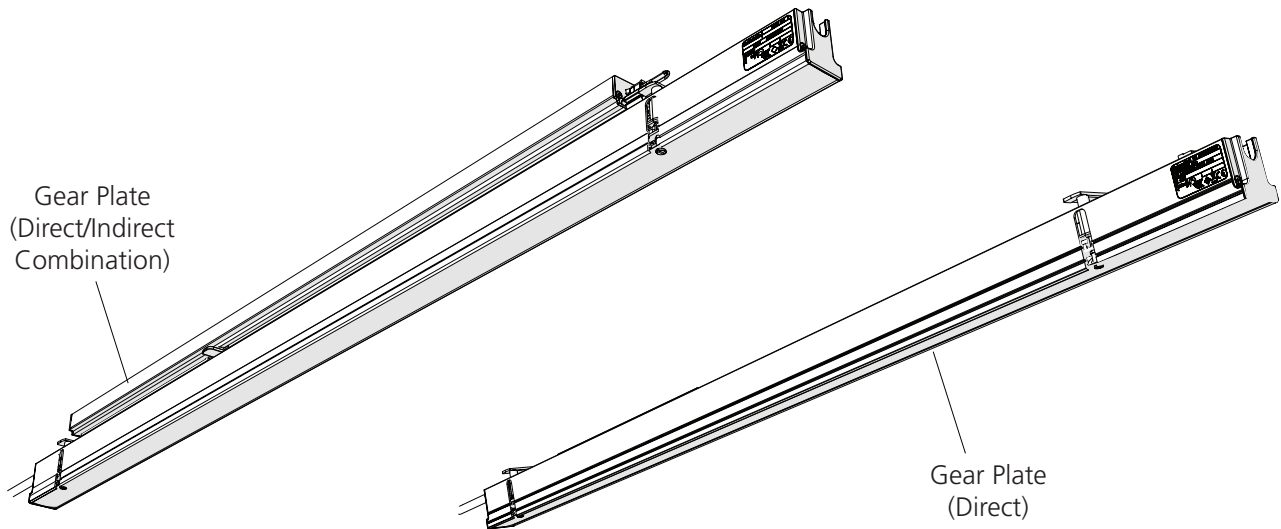

Attention: Read and understand these instructions before installing fixture. This fixture is intended for installation in accordance with National Electric Code and local regulation: To assure full compliance with local codes and regulations, check with your local electrical inspector before installation. This equipment is guaranteed only when used as indicated in these instructions; therefore they should be kept for future reference. To prevent electrical shock, turn off power supply before carrying out any connection or maintenance operations.

The following instructions allow you to install the gear plates on all algoritmo system configuration; your installation process may vary.



NOTE 1

The electrical feed is rated at 6A maximum, make sure the sum of gear plates on the same circuit does not exceed it. Consult the gear plate datasheets to find the values.

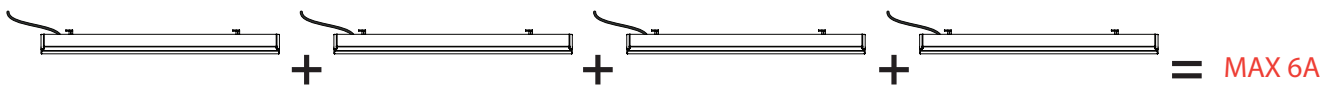

NOTE 2

The electrical wiring contained in the Gear plate is not capped; it is mandatory to disconnect the circuit to avoid electrical shock before making connections.

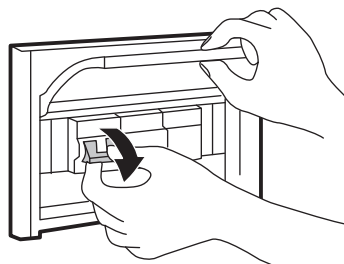



STEP 1

DIRECT GEAR PLATE INSTALLATION

Make the connections from the feed housing to the first gear plate, and connect the wire harness to the other end. Refer to the table below for connections.

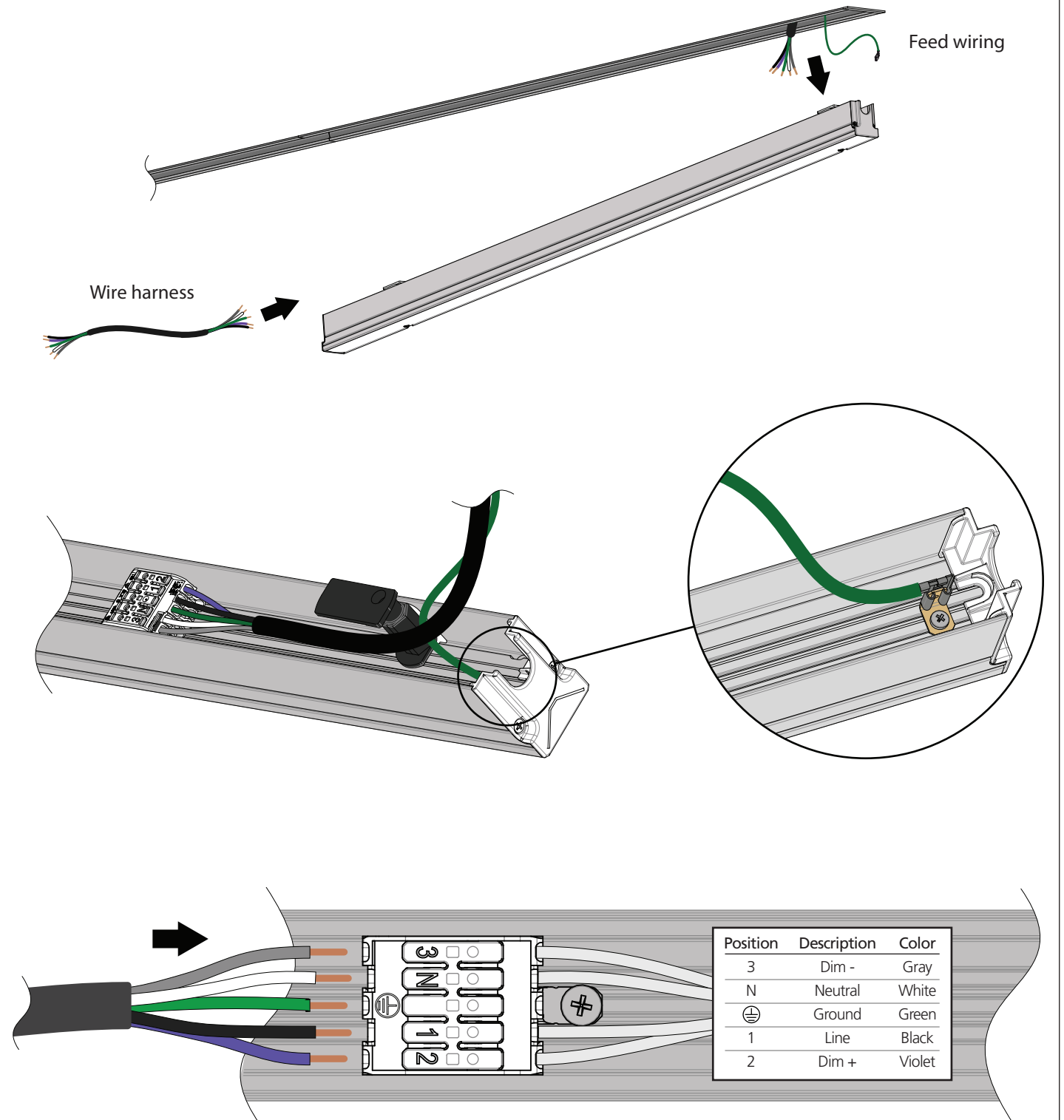



STEP 1 (cont.)

Lock in the gear plate by turning both brass screws perpendicular to its length. Be careful to route the wiring carefully as the gear plate may not lock properly into place. DO NOT turn the pins by force as they will not lock. Continue wiring and locking in the remaining gear plates. The last gear plate will not need the wiring harness.

For Optics Installation, see Installation document Y503-12078.

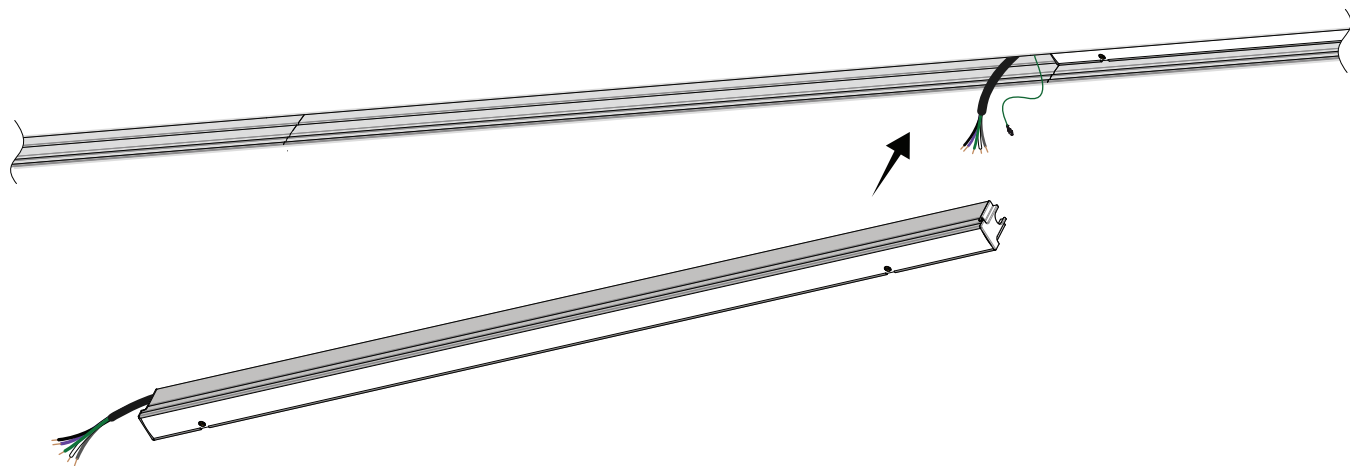
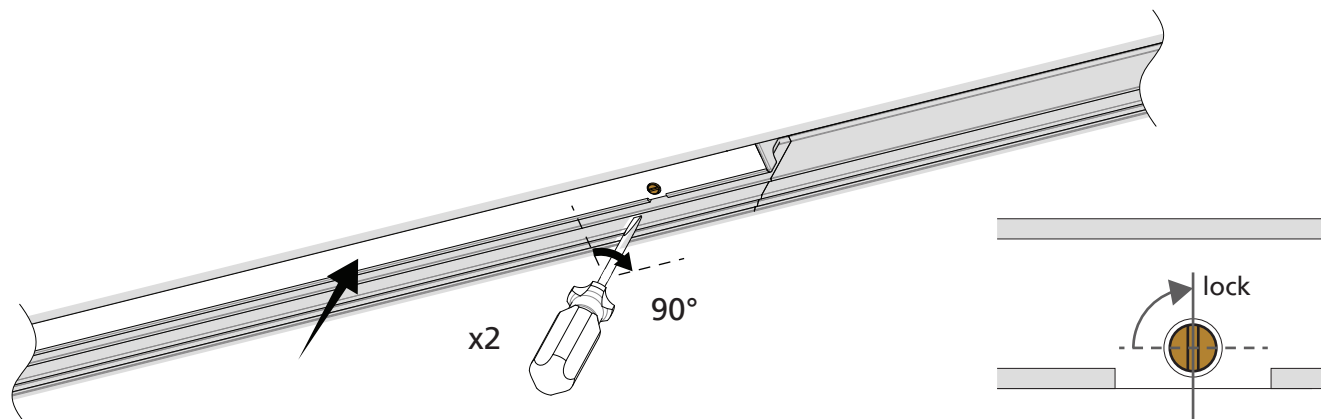

NOTE 3

Do not connect a wire harness coming out of the last unit in the configuration to prevent short circuit and/or shock.

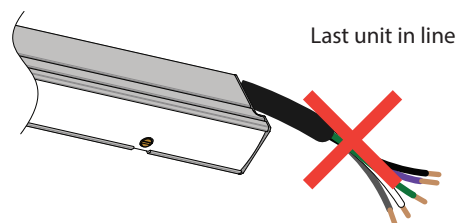



**STEP 2
(IF EQUIPPED)**

INDIRECT GEAR PLATE INSTALLATION

Insert and lock in the indirect gear plate by turning the brass screw perpendicular to it's length. **DO NOT** turn the pins by force as they will not lock. Plug in electrical connector coming out of body into the indirect gear plate.

NOTE : Indirect gear plate does not require any additional optics.

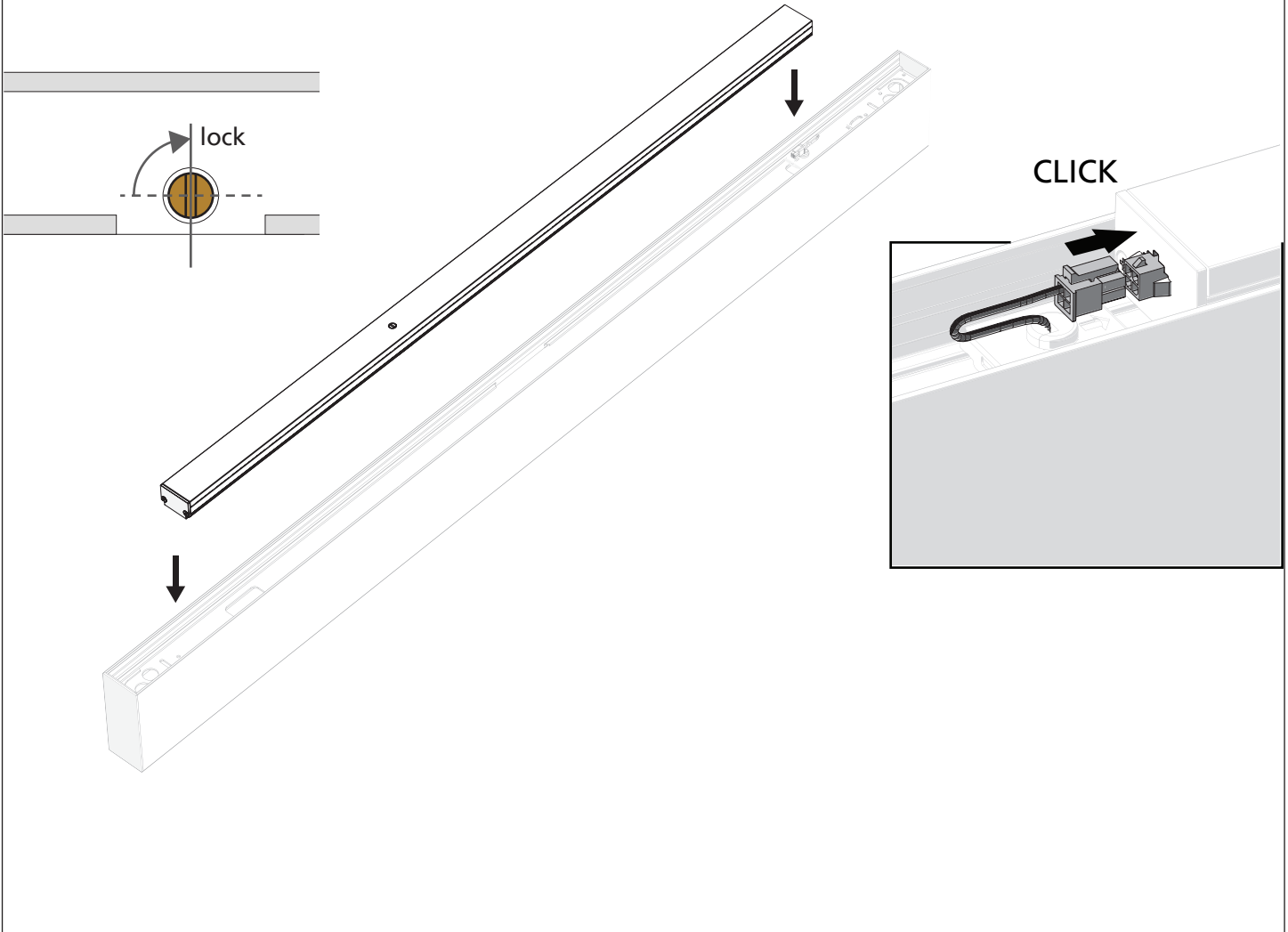



Attention: Read and understand these instructions before installing fixture. This fixture is intended for installation in accordance with National Electric Code and local regulation: To assure full compliance with local codes and regulations, check with your local electrical inspector before installation. This equipment is guaranteed only when used as indicated in these instructions; therefore they should be kept for future reference. To prevent electrical shock, turn off power supply before carrying out any connection or maintenance operations.

The following instructions allow you to install the different optics available, your installation process may vary.

Linear optics (Diffused or Prismoptic)
4ft, 8ft or 12ft

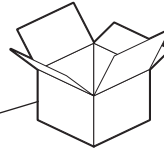
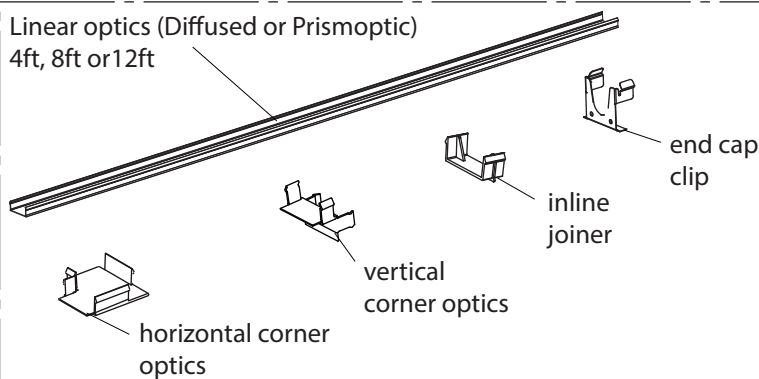

or

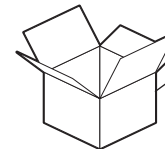

Controlled emission
diffuser (pack of 4 or 8)

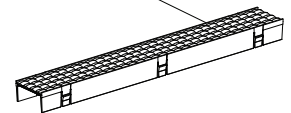

STEP 1A

For controlled emission optics :
1.1 install optics sections in body by pushing in.

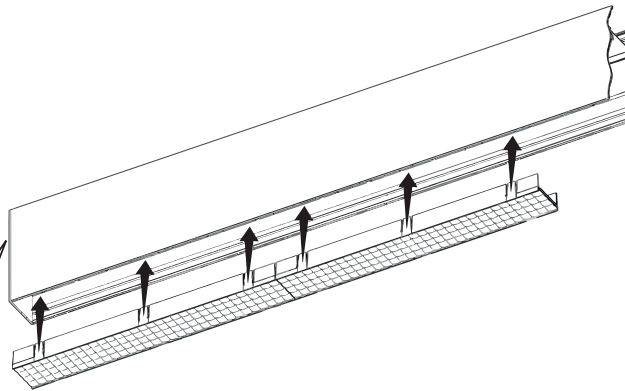
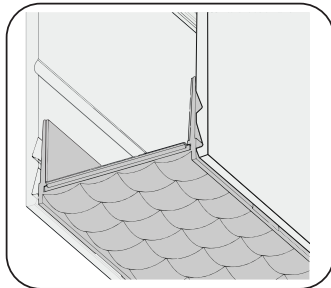

For maintenance :

Remove optics from the edge using a small tool and by gently twisting while pulling.

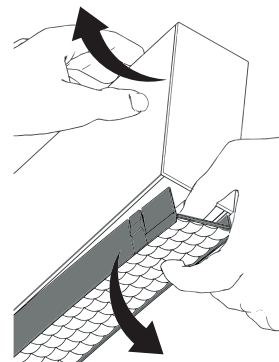
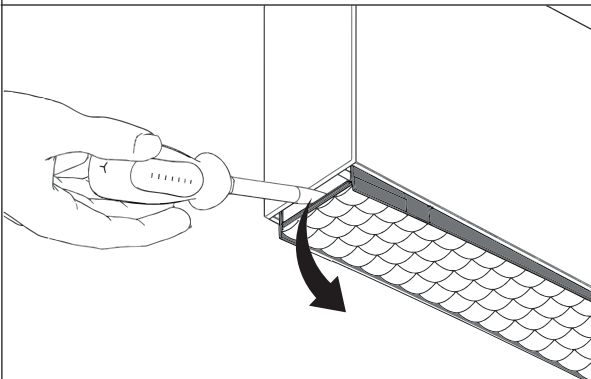



STEP 1B

For Prismoptic or Diffused optics installation :

- 1.1 install optics in body by pushing in. For linear configurations, clip inline joiner into first optics and then slide the following one in.
- 1.2 For the ends of each configuration, insert end cap clip at the same time as the optics.
- 1.3 For horizontal & vertical corner optics, clip them into the linear optics before installation into fixture.

1.2

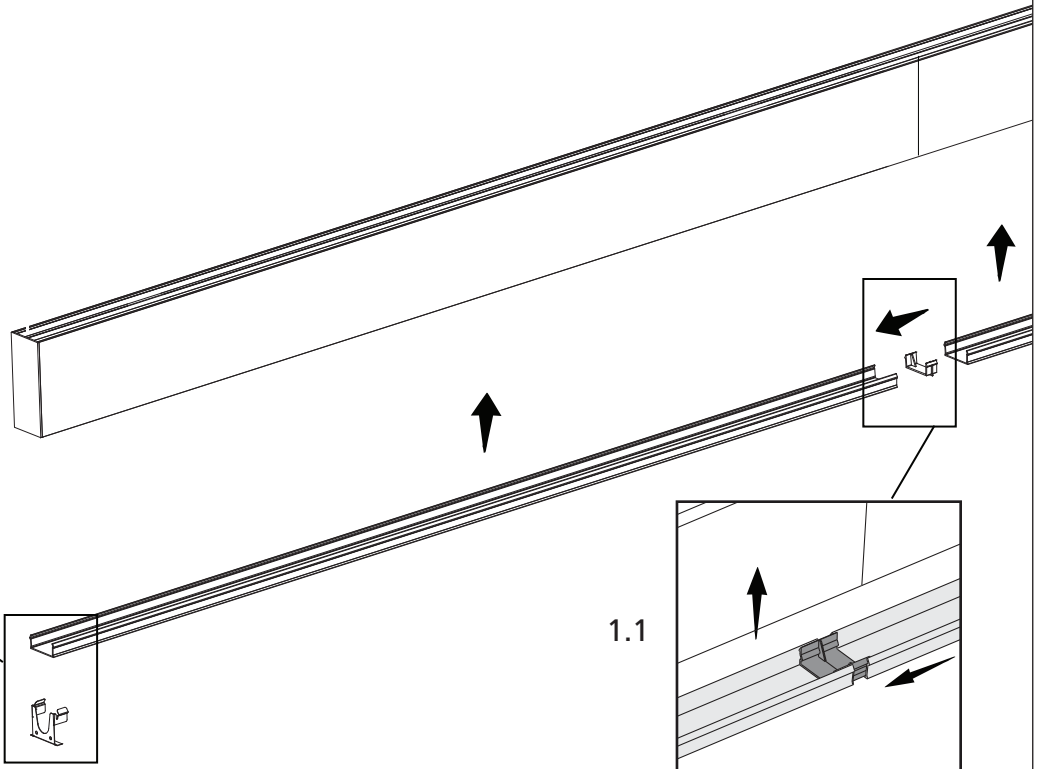
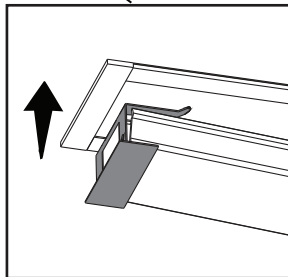
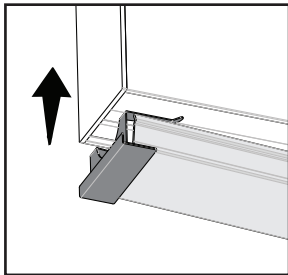

1.1

1.3

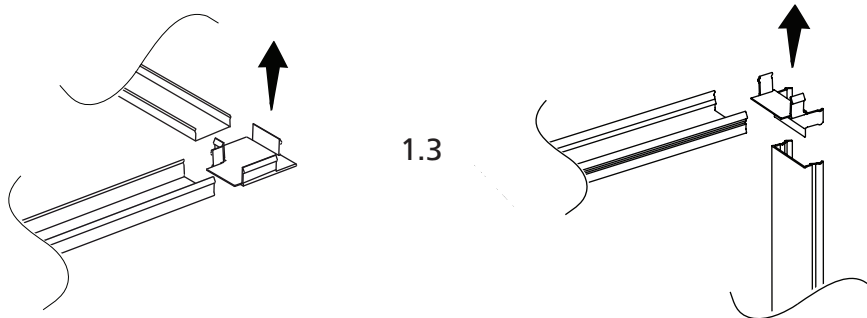



Attention: Read and understand these instructions before installing fixture. This fixture is intended for installation in accordance with National Electric Code and local regulation: To assure full compliance with local codes and regulations, check with your local electrical inspector before installation. This equipment is guaranteed only when used as indicated in these instructions; therefore they should be kept for future reference. To prevent electrical shock, turn off power supply before carrying out any connection or maintenance operations.

The following instructions allow you to install a suspension mount system configuration with accessories; your installation process may vary.

Suspension body

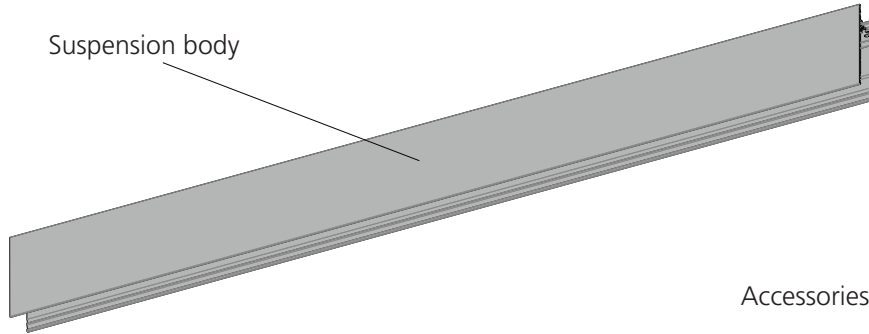

Accessories

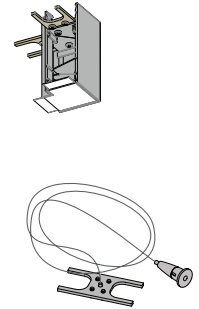

NOTE 1

The available Suspension Cable Kits mount differently; The Suspension Cable Kit (fig. 1) used on module ends have a slight adjustment for fine tuning. To simplify documentation, a 4" (102mm) position has been chosen. The Suspension Joiner Cable Kit (Fig. 2) used between modules cannot be adjusted.

Fig. 1

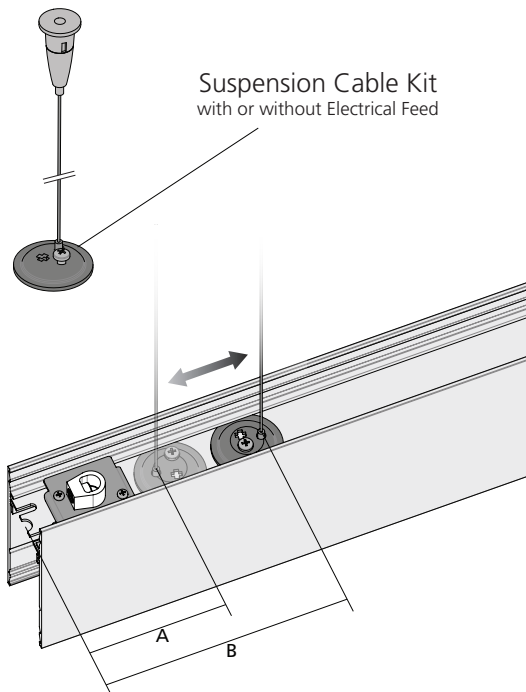

Dim A (min): 3" (75mm)
Dim B (max): 5 1/4" (134mm)

Fig. 2

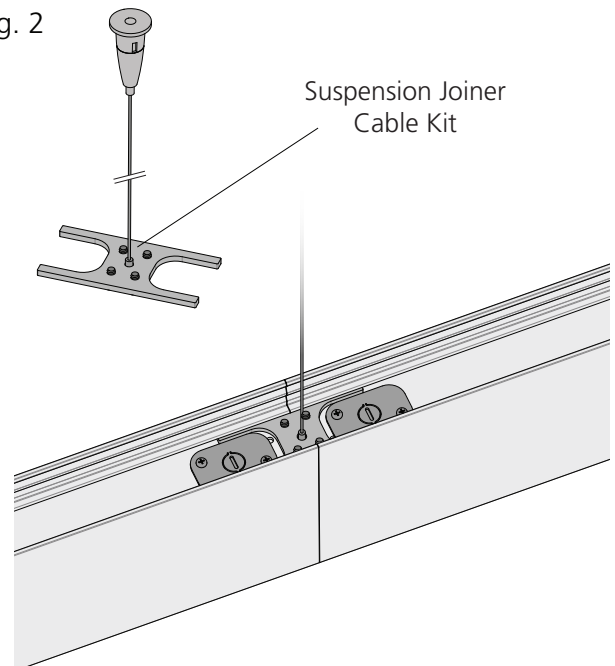

No Adjustment



STEP 1

Measure and mark the mounting locations depending on your configuration. A dimension of 4" (102mm) from the Suspension Cable Kit to the module edge has been used for simplicity but can vary, as per Note 1.

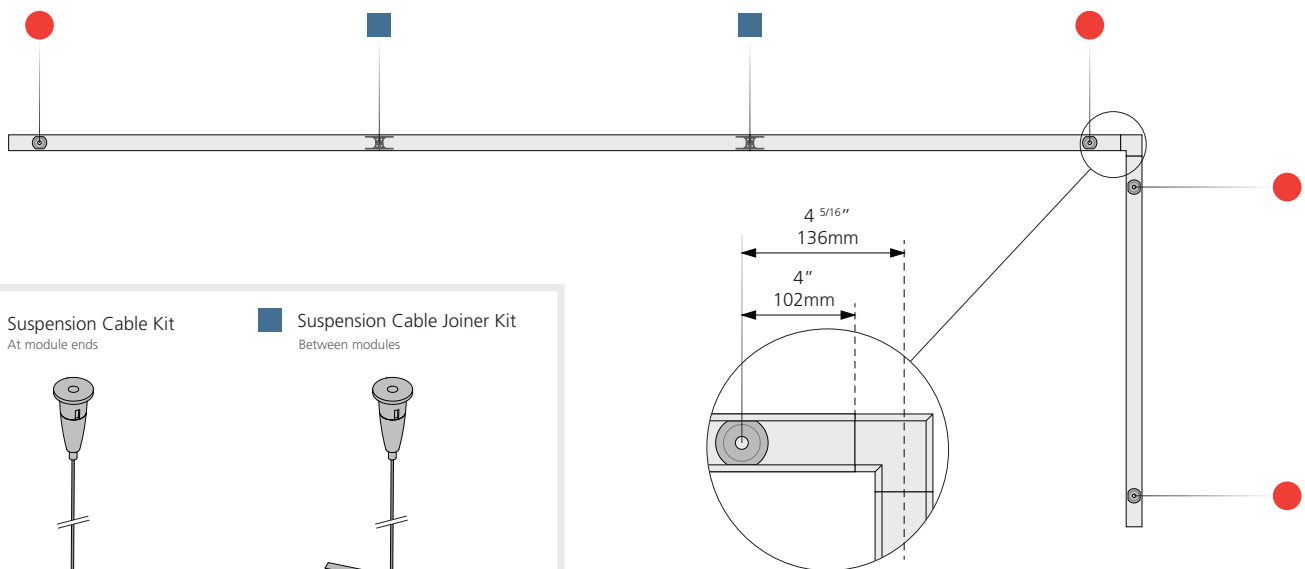
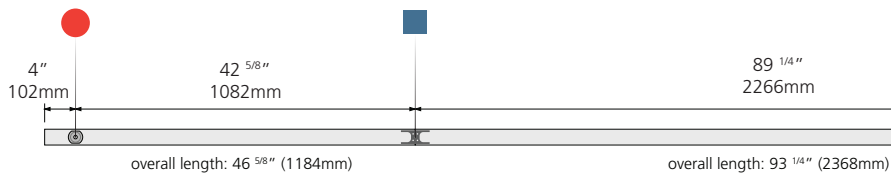
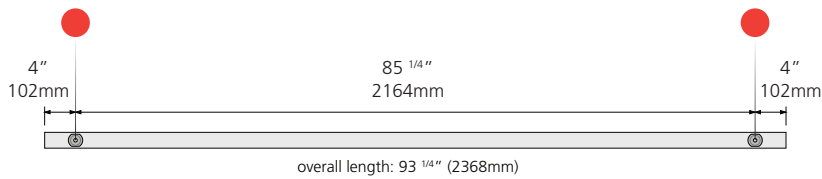
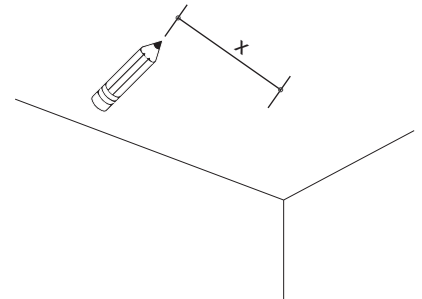
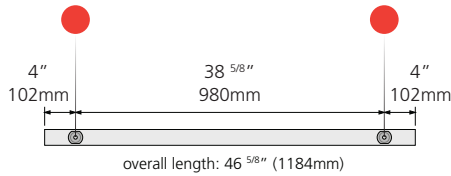

Suspension Cable Kit
At module ends

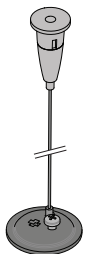

Suspension Cable Joiner Kit
Between modules

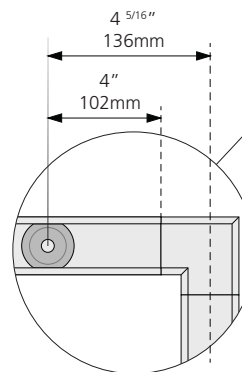
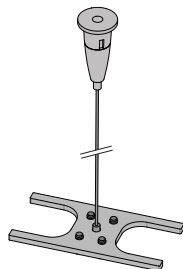



STEP 2

The following applies to the Suspension Cable Kit (USC-MALSC6/15) and Feed Cable Kit (USC-MALSFK6/15)

- 2.1 Remove the Cover Plate from the module (2 philips screws).
- 2.2 Slide in the Suspension Cable Alignment Disc.
- 2.3 Re-insert the previously removed Cover Plate. If installing a feed in this location, it will need a different plate; see document that comes with the Feed Kit (Y503-12103).
- 2.4 Position the Suspension Cable Alignment Disc to the desired dimension. Rotate it in order to center the cable.

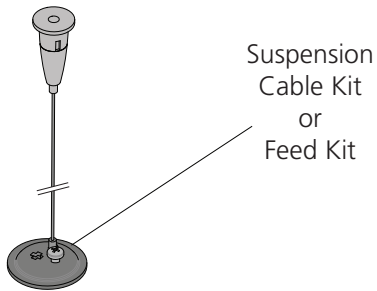

2.1

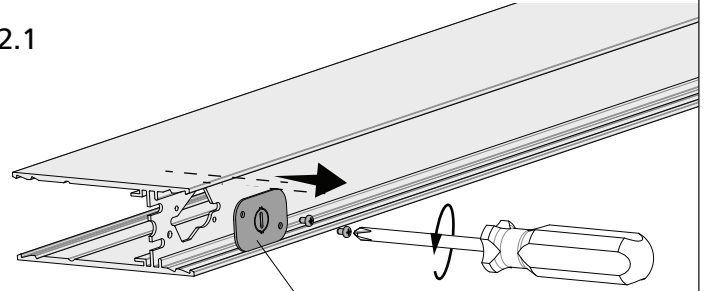

2.2

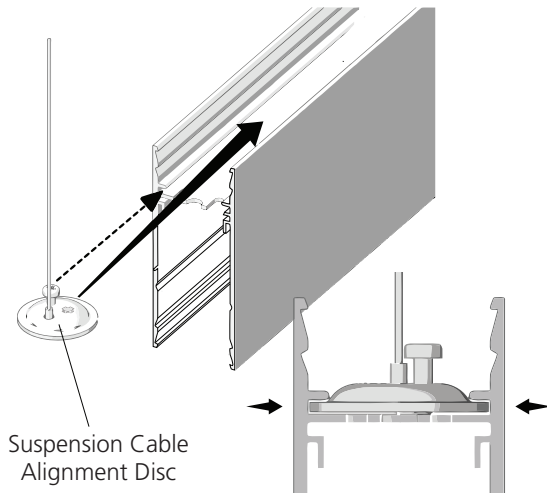

2.3

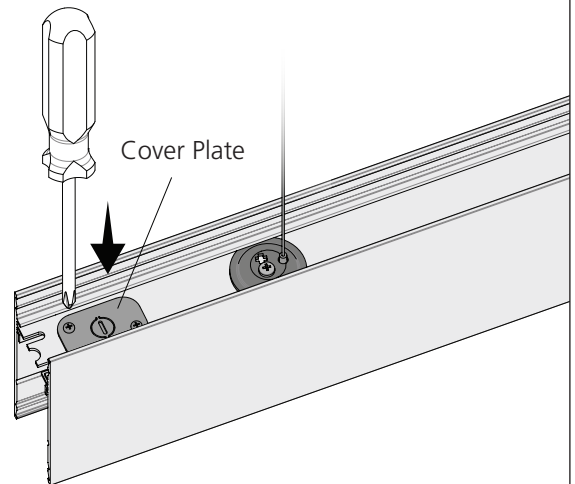

2.4

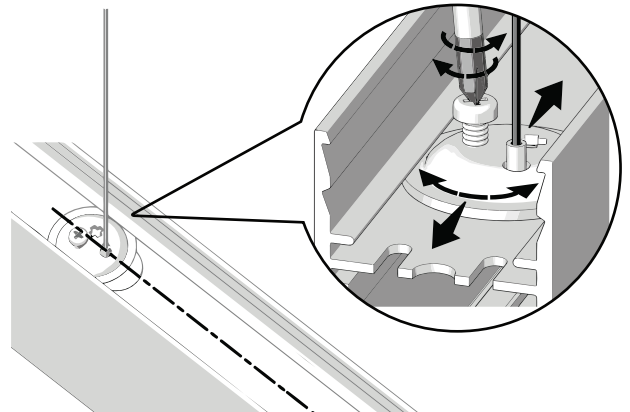
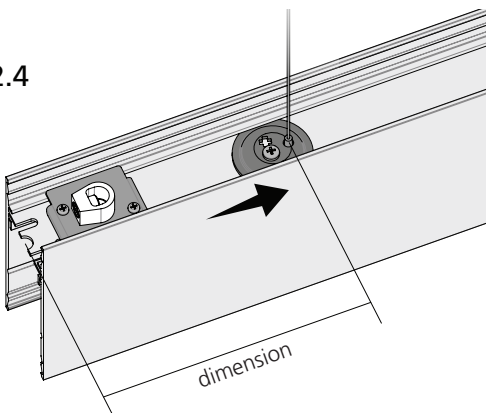



STEP 2 (cont.)

- 2.5 Install the Cable Grippers to the previously marked locations on the ceiling.
2.6 Feed the Suspension Cable through the previously installed Cable Gripper. Adjust the fixture to the desired height by pulling on the cable or pushing on the Gripper pin to release.
2.7 If this is the only fixture being installed, repeat all steps for the 2nd cable. If installing another, see following page.

2.5

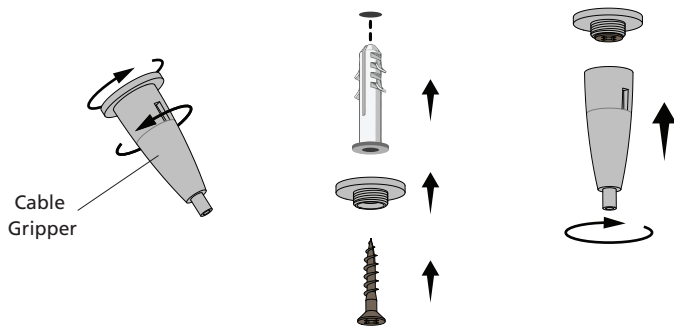

2.6

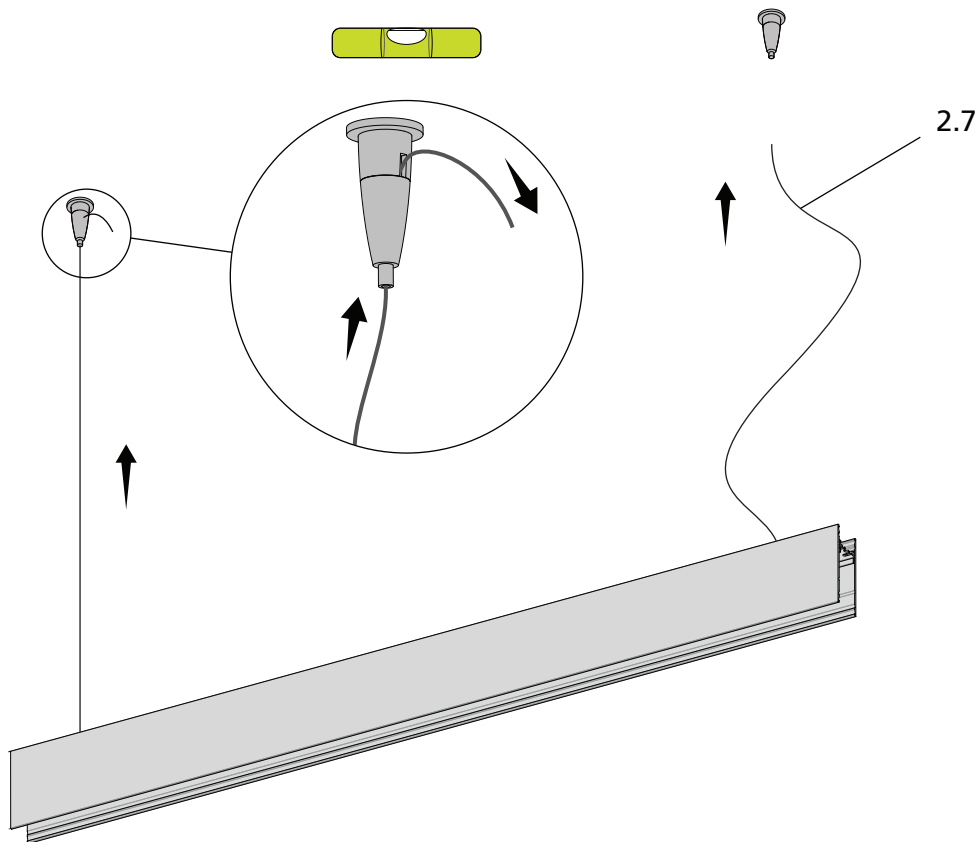
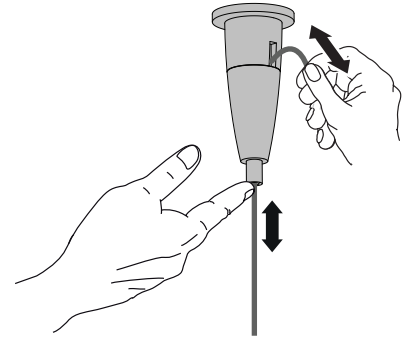



STEP 3
(If applicable)

The following applies to the Suspension Cable Joiner Kit (USC-MALLJK6/15)

3.1 Slide the Joiner plate into the module and tighten both Philips screws from the bottom. Feed the Suspension Cable through the center hole.

3.2 Feed the Suspension Cable through the previously installed Gripper. Adjust fixture height.

3.3 Insert the next module in line and it's Suspension Cable into the Gripper.

3.4 Tighten the 2 remaining screws from the bottom on the Linear Joiner to lock both fixtures to it.

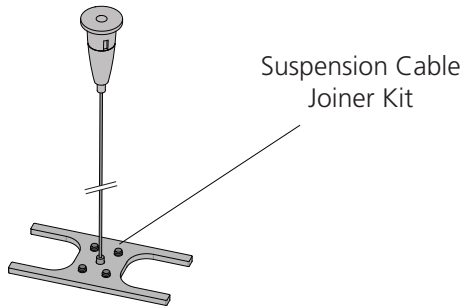

3.1

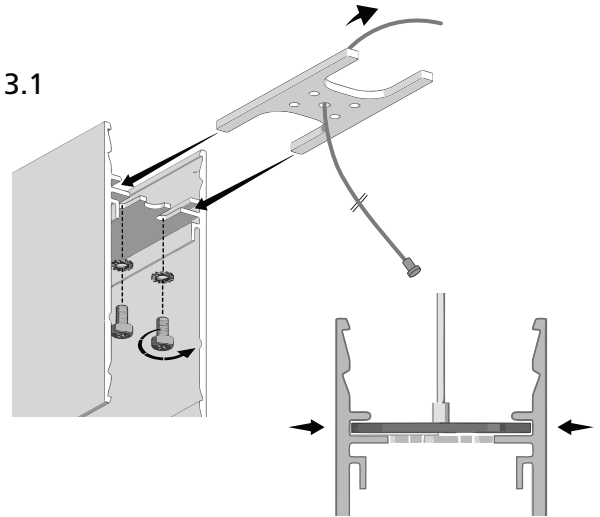

3.2

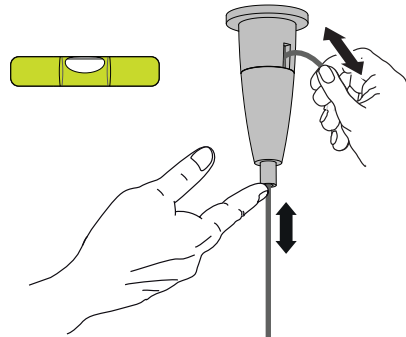
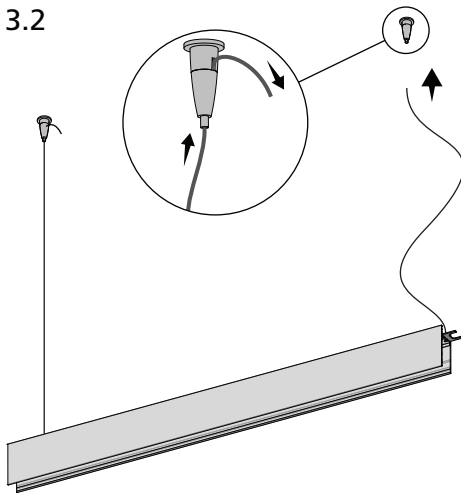

3.3

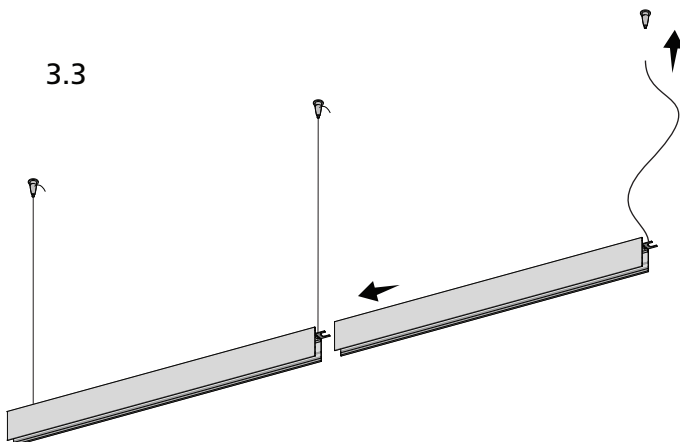

3.4

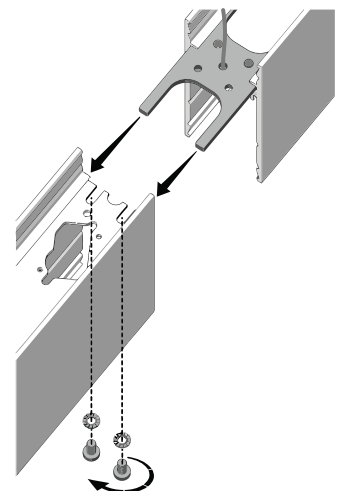



STEP 4
(If applicable)

4.1 The Horizontal Joiner (USC-MALC9HDx) and End Caps (USC-MALECx) do not require suspension cables. Simply slide them into the modules and fasten the screws from the bottom.
4.2 Foil tape is supplied in order to ensure there are no light leaks between bodies and joiners. Cut to size, peel off backing and apply to inside portions at each junction.

4.1

Horizontal Joiner

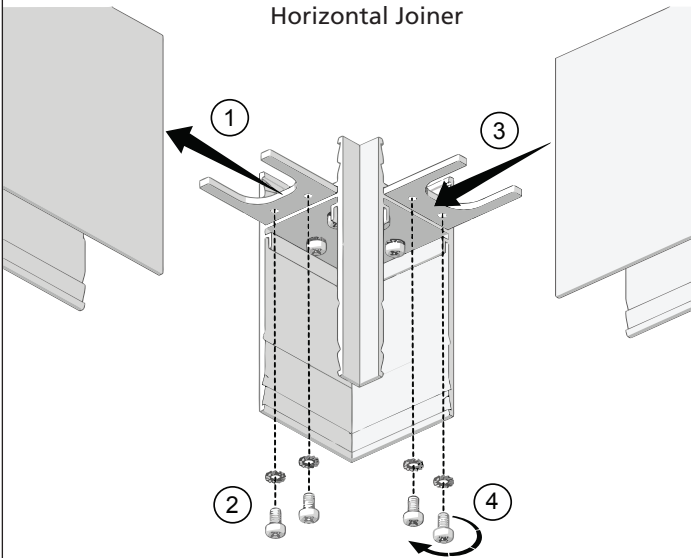

End Caps

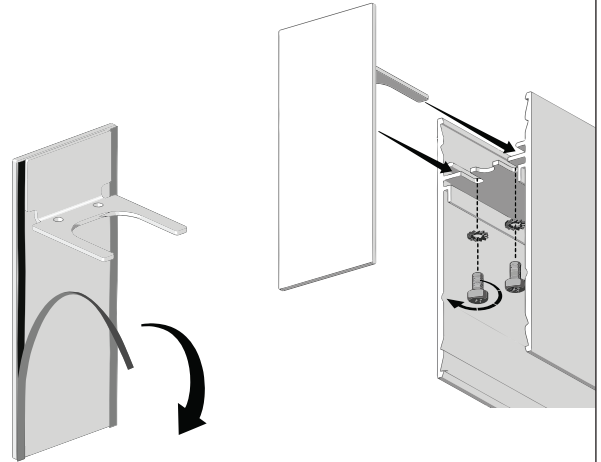

4.2

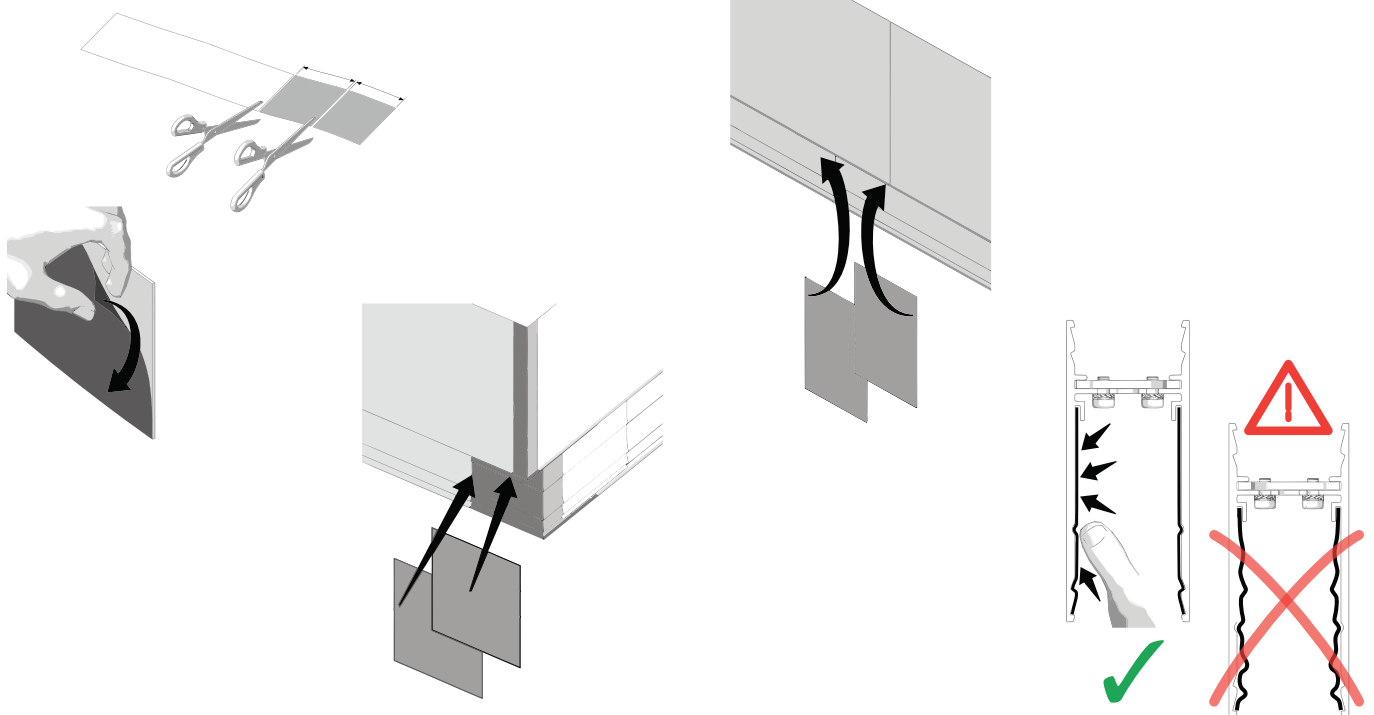



STEP 5

Continue installation of Gear Plate (document Y503-11986) and Optics (document Y503-12078)

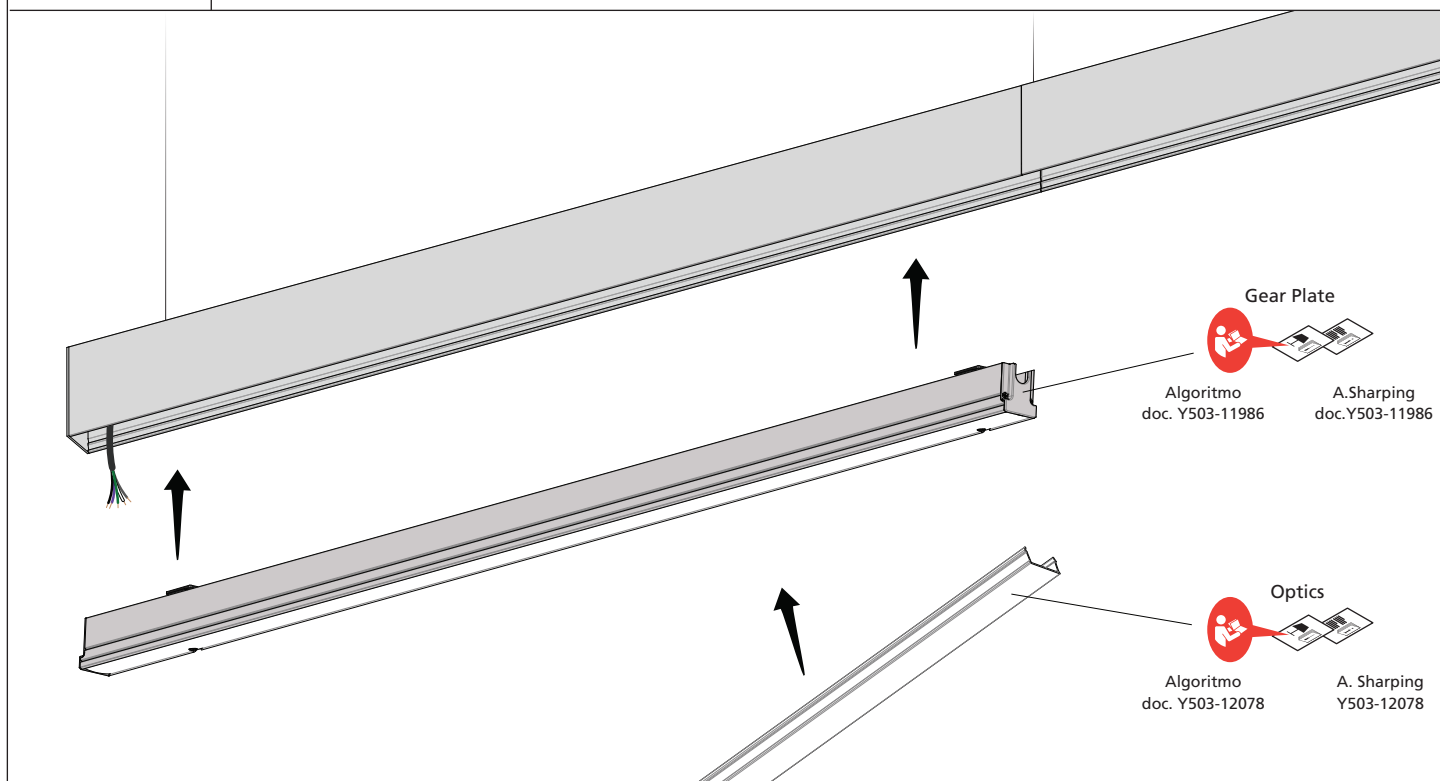



Attention: Read and understand these instructions before installing fixture. This fixture is intended for installation in accordance with National Electric Code and local regulation: To assure full compliance with local codes and regulations, check with your local electrical inspector before installation. This equipment is guaranteed only when used as indicated in these instructions; therefore they should be kept for future reference. To prevent electrical shock, turn off power supply before carrying out any connection or maintenance operations.

STEP 1

Make sure your box has the following parts:

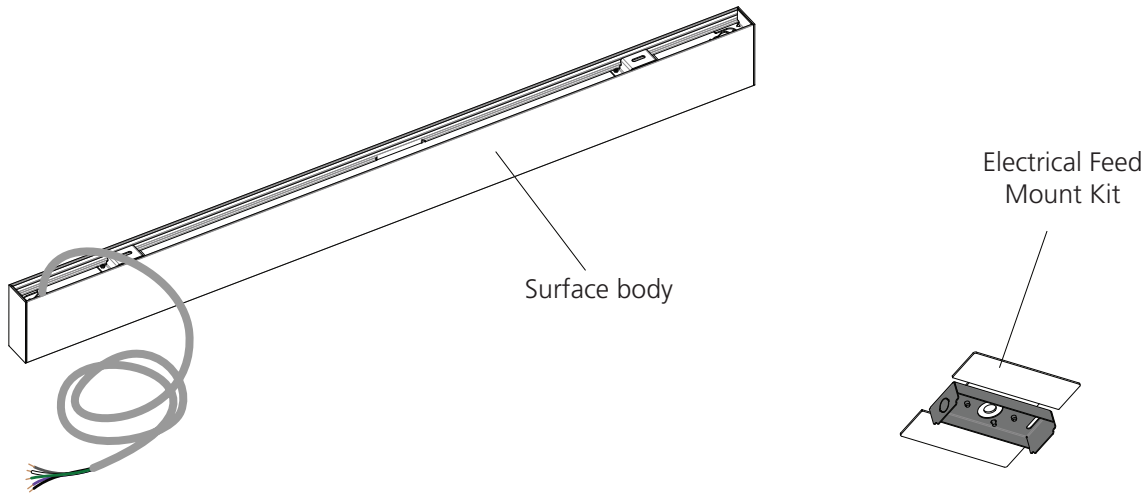

NOTE 1

The Electrical feed position must be verified as it can interfere with the body's mounting brackets.

4ft (118cm) Model, viewed from above

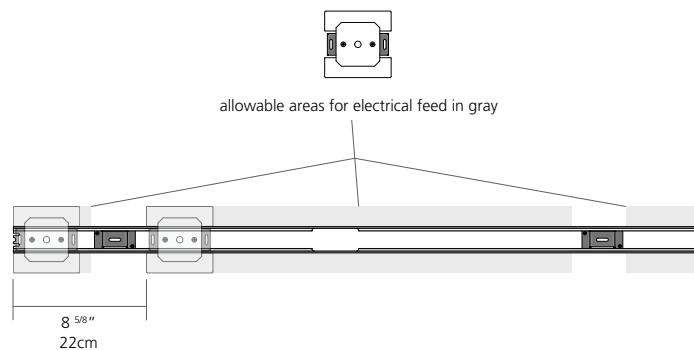

8ft (237cm) Model, viewed from above

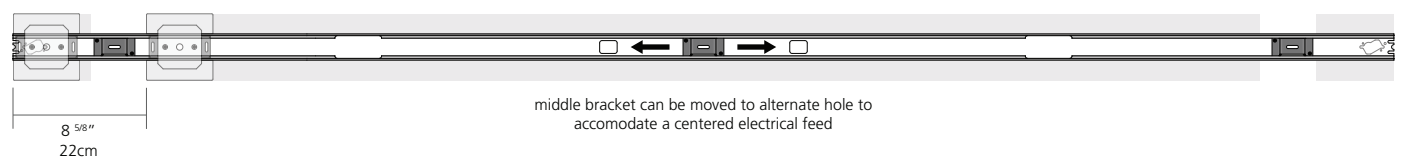



STEP 2

Choose your installation type

Armored Cable ("BX" pigtail)

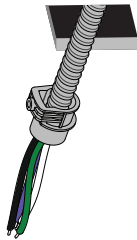

connection housing

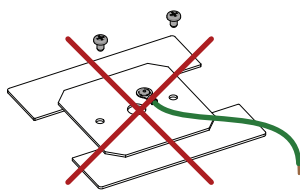
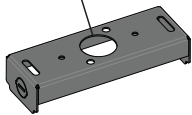

the canopy cover will not be used. It is represented graphically in some steps, disregard as installation process is the same.

Insert the armored cable through the connection housing and secure into place with the nut. Using the appropriate hardware (not supplied), mount the housing to the surface.

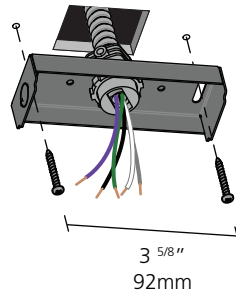
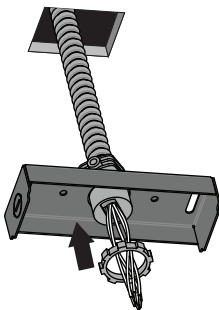

Electrical Junction Box

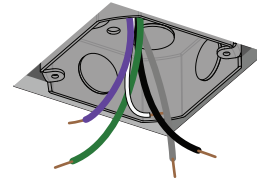

Install the mandatory canopy cover using the 2 philips screws.

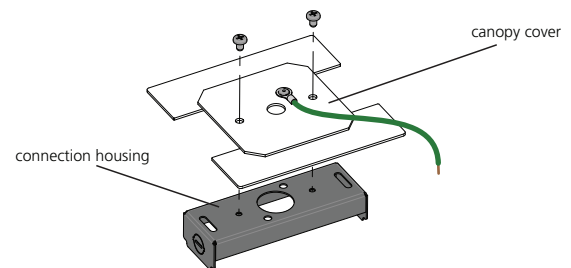

Insert the junction box wiring through the canopy cover hole. Using the appropriate hardware (not supplied), mount the housing to the surface.

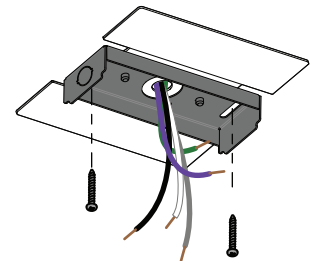
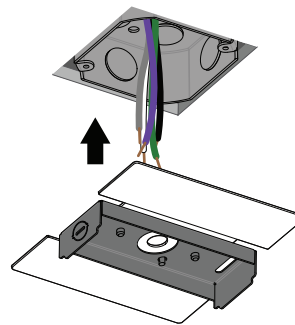



STEP 3

Choose how the power will be fed to the gear plate and proceed with the following steps

If feeding from the edge of the fixture, the feed cable will need to be cut and stripped.

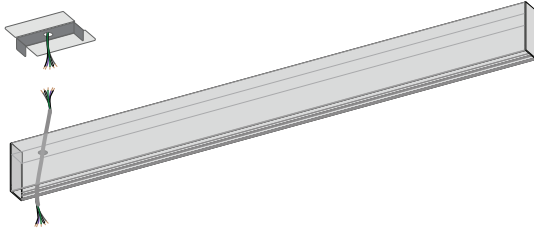

Cut the excess wiring, leaving just enough to strip the wiring in order to make the connections to the Feed Mount Kit.

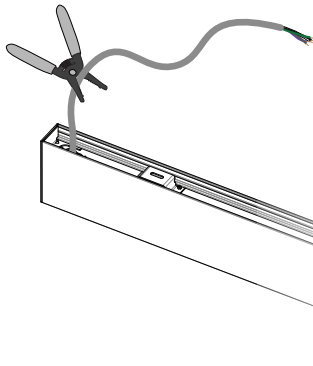

If feeding from a center position, the cable will need to be routed through a grommet.

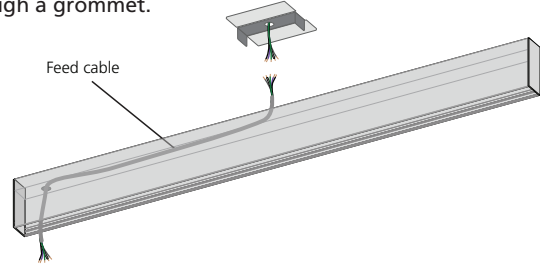

Pry out the knock-out opening, insert the protective grommet and insert feed cable through grommet.

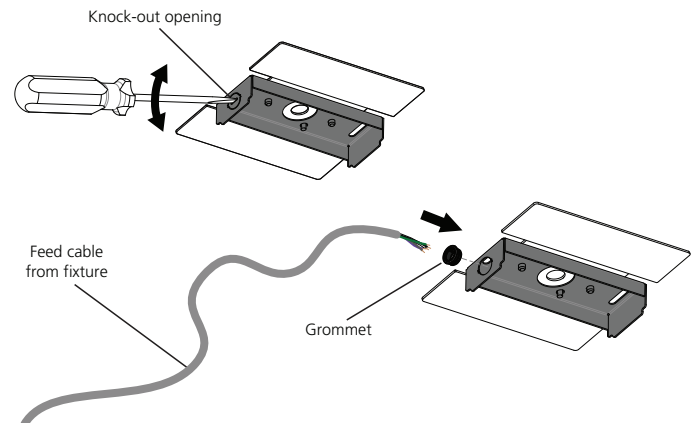

STEP 4

Make the appropriate connections that will go to the fixture, depending on your installation type.

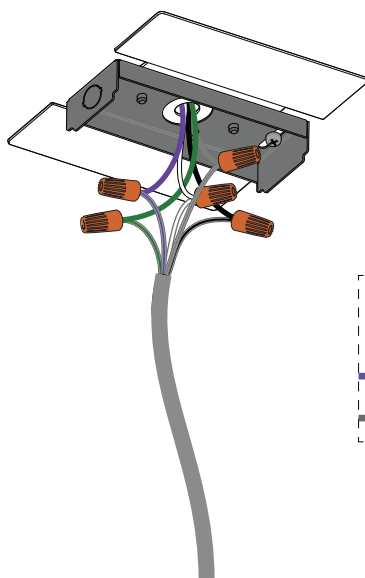

To Fixture

CEILING WIRES		HOUSING WIRES
GREEN	G	GREEN/YELLOW
BLACK	L	BLACK
WHITE	N	WHITE

0-10V DIMMABLE VERSION:	
CEILING WIRES	HOUSING WIRES
0-10V (+)	VIOLET (+)
0-10V (-)	GREY (-)

OR

DALI DIMMABLE VERSION:	
CEILING WIRES	HOUSING WIRES
DALI	VIOLET
DALI	GREY

DIMMING WIRES OPTIONAL
IF NOT USING, **DO NOT** CAP TOGETHER
AS IT WILL DIM THE FIXTURE TO MINIMUM

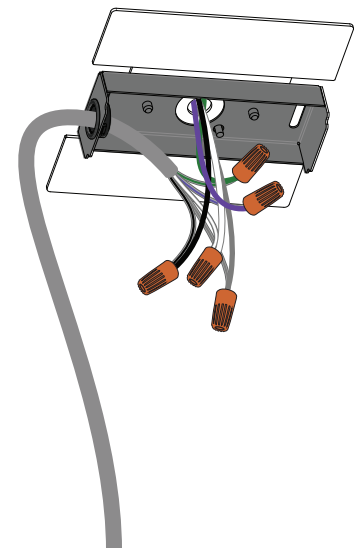

To Fixture



STEP 5

- 5.1 Gently pry out optics with a flat tool. Be careful not to damage the paint.
- 5.2 Unlock the gear plate (2 slotted brass pins) and pull it out.
- 5.3 Measure and mark the mounting locations for your model.

5.1

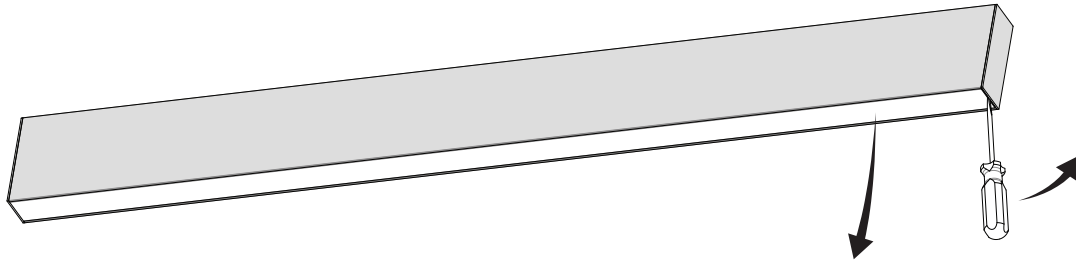

5.2

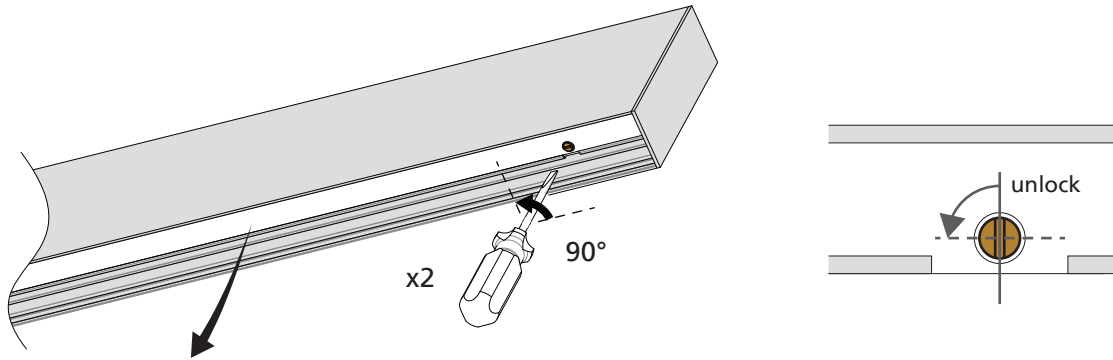

4ft (118cm) Model

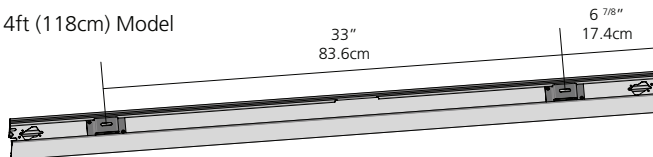

overall length: 46 5/8" (1184mm)

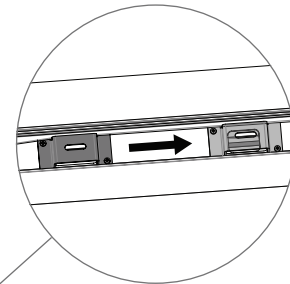

bracket can be moved to
alternate hole to
accommodate a centered
power feed

8ft (237cm) Model

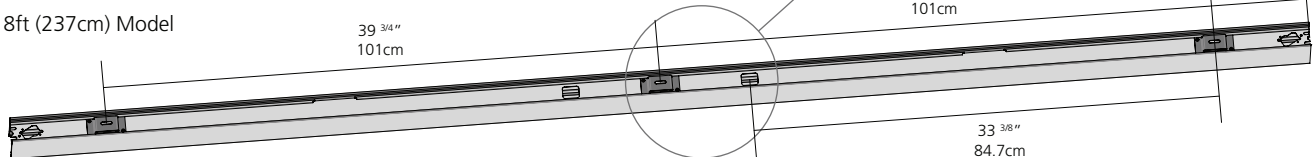

overall length: 93 1/4" (2368mm)



STEP 6

6.1 Mount the body to the surface at the previously marked locations (hardware not supplied).
NOTE: If mounting over the electrical feed, make sure the wiring is routed properly on top of the body (fig. 1).

6.1

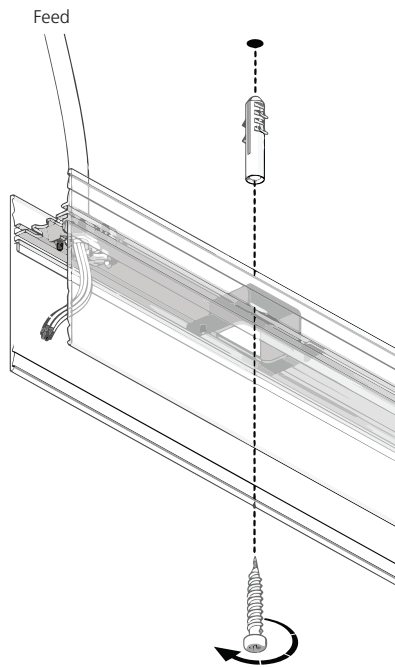
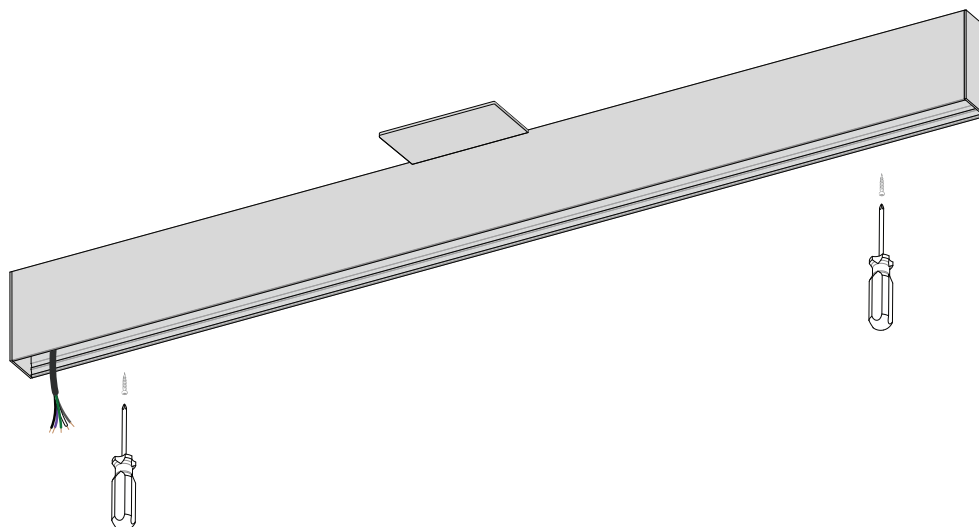
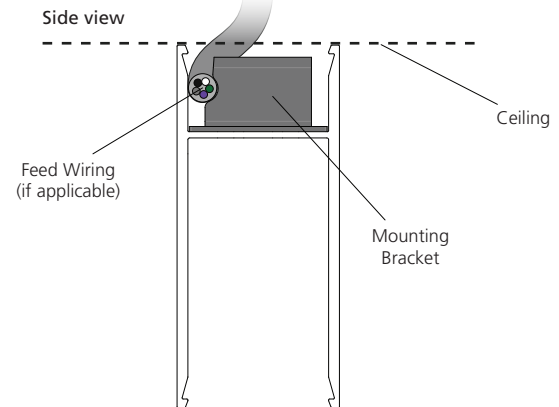
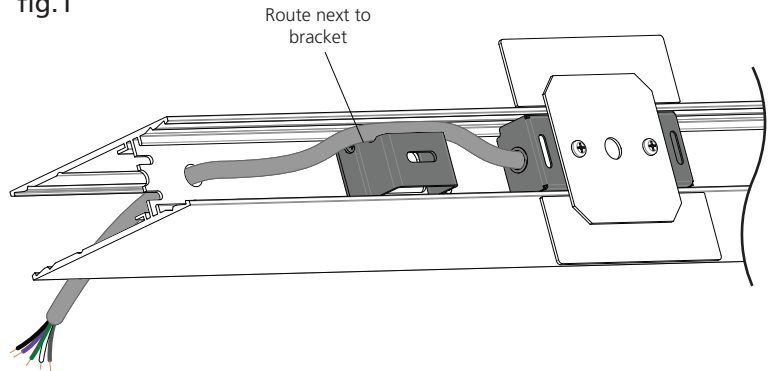

fig.1





STEP 7

7.1 Make the appropriate feed and ground pin connections to the gear plate.

7.1

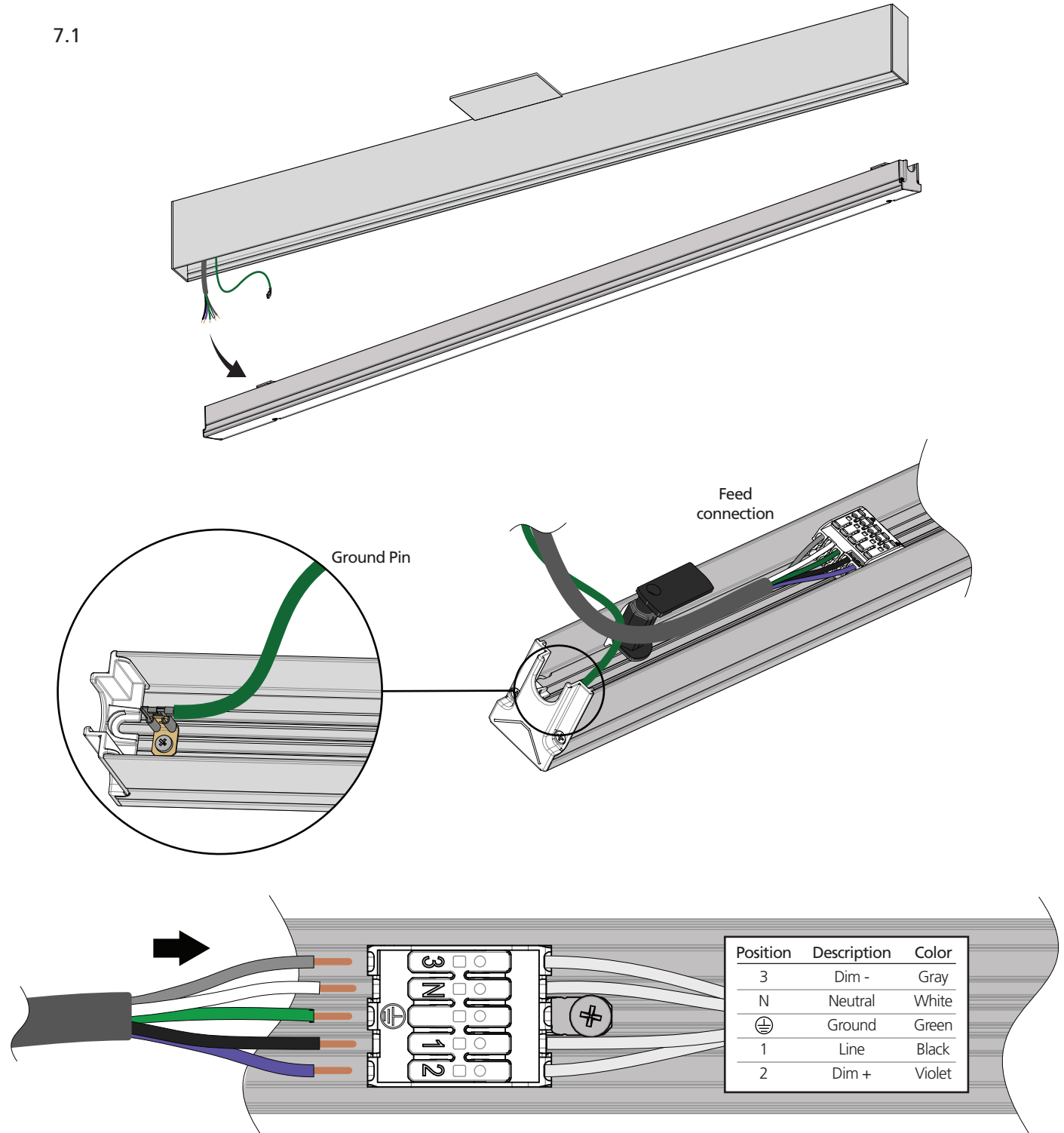



STEP 8

8.1 Insert Gear Plate and lock into place by turning the 2 brass pins. Be careful to route the wiring carefully as the gear plate may not lock properly into place. DO NOT turn the pins by force as they will not lock.
8.2 Clip the Optics back on. Installation is complete.

8.1

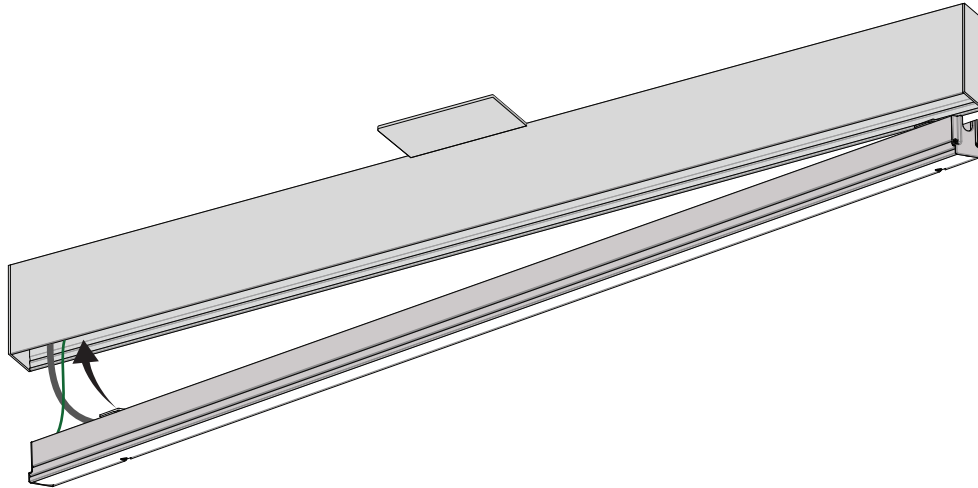

8.2

