

# FLOS

F6105000 Glass

## Romeo Moon Suspension 1

Designed by Philippe Starck, 1996



Halogen - 150W

Suspension lamp providing diffused light. Acid-etched pressed borosilicate glass internal diffuser. Pressed clear glass shade. Injection-molded transparent polycarbonate diffuser support. Transparent, stamped polycarbonate dust protection screen. White, injection-molded ABS rose, galvanized pressed steel ceiling fitting. Free steel suspension cable.

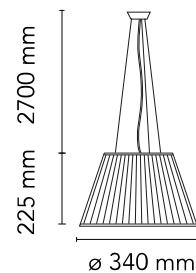

Are you a professional and your project needs consulting and support?

[BOOK AN APPOINTMENT](#)

### Main specifications

EAN	8059607020883
Mounting	Suspension
Environments	Indoor dry location
Light Source Type	Bulb
Lamp category	Halogen
Lamp holders	E27
Ilcos	HSGS
Number of heads	1
Power (W)	150

### Physical

Colour	Glass
Cord length (mm)	2700
Net weight (kg)	4.5
Package height (mm)	380
Package width (mm)	430
Package length (mm)	420
Package volume (m3)	0.07
IP internal	20

### Download

[Mounting instructions](#)  PDF

[Spare Parts](#)  PDF

### Photometric Files

[LDT / IES](#)  LDT

### Technical Drawings

[2D](#)  ZIP

[3D](#)  ZIP



## Schematic light drawing

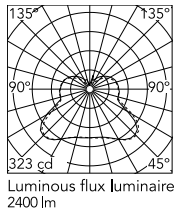

### Photometric

Lighting type	Total
Light distribution	Symmetric

### Electrical

Insulation class	I
Frequency (Hz)	50/60
Main voltage (Vac)	220-250
LED voltage Vf (Vdc)	null
Dimmable	Yes
Dimming interface	Remote Dimmable (Dimmer Not Included)
Batteries inside	No
Charging min time	No

## Bulbs



NOT INCLUDED

RF32564

LED Lamp 11.5W E27 220-240V  
3000K A70



NOT INCLUDED

RF32563

LED Lamp 11.5W E27 220-240V  
2700K A70

## Spare Parts

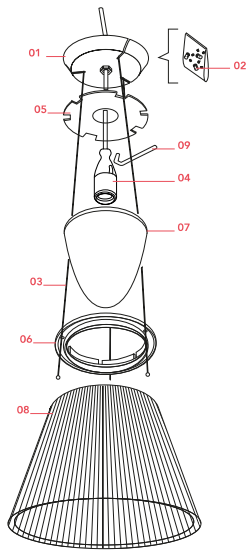

- |     |   |           |
|-----|---|-----------|
| 01. | Ceiling attachment assembly             | RF81836   |
| 02. | Kit with brass wire clamps and screws   | RF6110800 |
| 03. | Steel cable packed 3 pieces mt. 3       | RF29875   |
| 04. | Lamp holder assembly                    | RF85863   |
| 05. | Anti-dust screen                        | RF05974   |
| 06. | Safety ring assembly                    | RF6105200 |
| 07. | Acid-etched diffuser                    | RF03172   |
| 08. | Romeo Moon Suspension/Table 1 lampshade | RF6110400 |
| 09. | Lamp holder support                     | RF02784   |

**DOWNLOAD**



RF81836  
Ceiling attachment assembly



RF6110800  
Kit with brass wire clamps and screws



RF29875  
Steel cable packed 3 pieces mt. 3



RF85863  
Lamp holder assembly



RF05974  
Anti-dust screen



RF6105200  
Safety ring assembly



RF03172  
Acid-etched diffuser



RF6110400  
Romeo Moon Suspension/Table 1 lampshade



RF02784

Lamp holder support

# FLOS

F0003000 Glass

## Romeo Moon Suspension 2

Designed by Philippe Starck, 1996



Halogen - 150W

Suspension lamp providing diffused light. Acid-etched pressed borosilicate glass internal diffuser. Pressed clear glass shade. Injection-molded transparent polycarbonate diffuser support. Transparent, stamped polycarbonate dust protection screen. White, injection-molded ABS rose, galvanized pressed steel ceiling fitting. Free steel suspension cable.

Are you a professional and your project needs consulting and support?

BOOK AN APPOINTMENT

### Main specifications

EAN	8059607013021
Mounting	Suspension
Environments	Indoor dry location
Light Source Type	Bulb
Lamp category	Halogen
Lamp holders	E27
Ilcos	HSGS
Number of heads	1
Power (W)	150

### Physical

Colour	Glass
Cord length (mm)	2700
Net weight (kg)	7.6
Package height (mm)	370
Package width (mm)	610
Package length (mm)	610
Package volume (m3)	0.14
IP internal	20

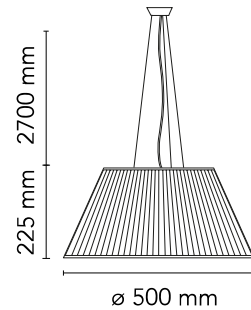

### Download

Mounting instructions [↓ PDF](#)

Spare Parts [↓ PDF](#)

### Photometric Files

LDT / IES [↓ LDT](#)

### Technical Drawings

2D [↓ ZIP](#)

3D [↓ ZIP](#)



## Schematic light drawing

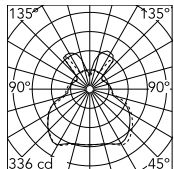

Luminous flux Luminaire  
2400 lm

### Photometric

Lighting type	Total
Light distribution	Symmetric

### Electrical

Insulation class	I
Frequency (Hz)	50/60
Main voltage (Vac)	220-250
LED voltage Vf (Vdc)	null
Dimmable	Yes
Dimming interface	Remote Dimmable (Dimmer Not Included)
Batteries inside	No
Charging min time	No



## Bulbs



NOT INCLUDED

RF32564

LED Lamp 11.5W E27 220-240V  
3000K A70



NOT INCLUDED

RF32563

LED Lamp 11.5W E27 220-240V  
2700K A70

## Spare Parts

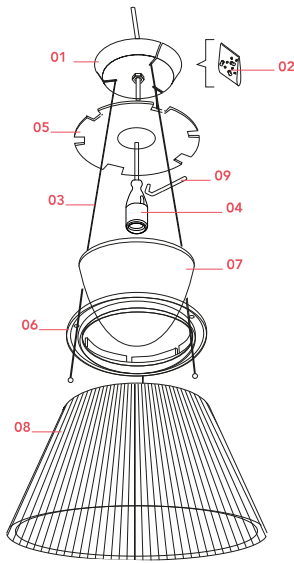

- |     |   |           |
|-----|---|-----------|
| 01. | Ceiling attachment assembly                     | RF81836   |
| 02. | Kit with brass wire clamps and screws           | RF6110800 |
| 03. | Steel cable packed 3 pieces mt. 3               | RF29875   |
| 04. | Lamp holder assembly                            | RF85863   |
| 05. | Anti-dust screen                                | RF05985   |
| 06. | Safety ring assembly                            | RF6110700 |
| 07. | Acid-etched diffuser                            | RF03171   |
| 08. | Romeo Moon Suspension/Table 2 & Floor lampshade | RF6110300 |
| 09. | Lamp holder support                             | RF02783   |

**DOWNLOAD**



RF81836  
Ceiling attachment assembly



RF6110800  
Kit with brass wire clamps and screws



RF29875  
Steel cable packed 3 pieces mt. 3



RF85863  
Lamp holder assembly



RF05985  
Anti-dust screen



RF6110700  
Safety ring assembly



RF03171  
Acid-etched diffuser



RF6110300  
Romeo Moon Suspension/Table 2 & Floor lampshade



RF02783

Lamp holder support