



ONE WELL KNOWN SEQUENCE  
- 01, 2017

Black Anodised Satin Aluminium / Inox Anodised Satin Aluminium  
Pendant rod length to order.



OVERALL DIMENSIONS



BACKPLATE DIMENSIONS

Mounting screws not included.  
6mm countersunk screw recommended.

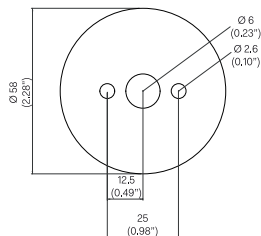

MATERIALS AND FINISHES

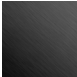
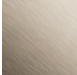
-  MA-OWKS-01-BAA  
Black Anodised Satin Aluminium
-  MA-OWKS-01-INX  
Inox Anodised Satin Aluminium  
Limited Stock

BULB SPECIFICATIONS

S14s opal LED tube  
Radium Raledina 9.9W / 1000mm Ø30mm  
1055lm / 2700K

PRODUCT SPECIFICATIONS

Input voltage: 120V / 240V  
Maximum wattage: 120W  
120V / 240V dimmable LED triac  
Product weight: 6kg  
IP20

Please supply required drop length of fixture,  
measured from the ceiling to bottom fitting at  
time of order.

Minimum total drop length 1350mm.  
Maximum total drop length 3040mm.

Please allow 25mm tolerance of drop length.

120V version supplied with paintable junction  
box cover.

CLEANING INSTRUCTIONS

Before cleaning, lighting fixtures must  
be turned off and unplugged from mains  
electricity. Whilst cleaning please take care  
and use the gloves provided.

Black Anodised Satin Aluminium and Inox  
Anodised Satin Aluminium: Use a lightly  
damp soft dust cloth and gently go over marks  
until clean. Dry it afterwards with a soft dust  
cloth.

Glass tube: Remove the bulb from the  
product. Using a lightly damp cloth, clean only  
the outside of the tube and dry it with a dry  
soft dust cloth. Only put the glass bulb back  
on the product once it is fully dry.



ONE WELL KNOWN SEQUENCE  
- 0101, 2017

Black Anodised Satin Aluminium / Inox Anodised Satin Aluminium  
Pendant rod length to order.



OVERALL DIMENSIONS

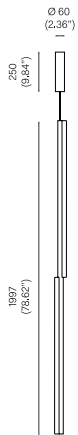

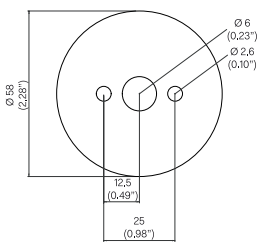

BACKPLATE DIMENSIONS

Mounting screws not included.  
6mm countersunk screw recommended.

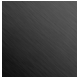

MATERIALS AND FINISHES

-  MA-OWKS-0101-BAA  
Black Anodised Satin Aluminium
-  MA-OWKS-0101-INX  
Inox Anodised Satin Aluminium  
Limited Stock

BULB SPECIFICATIONS

S14s opal LED tube  
Radium Raledina 9.9W / 1000mm Ø30mm  
1055lm / 2700K

PRODUCT SPECIFICATIONS

Input voltage: 120V / 240V  
Maximum wattage: 120W  
120V / 240V dimmable LED triac  
Product weight: 10kg  
IP20

Please supply required drop length of fixture,  
measured from the ceiling to bottom fitting at  
time of order.

Minimum total drop length 2350mm.  
Maximum total drop length 4040mm.

Please allow 25mm tolerance of drop length.

120V version supplied with paintable junction  
box cover.

CLEANING INSTRUCTIONS

Before cleaning, lighting fixtures must  
be turned off and unplugged from mains  
electricity. Whilst cleaning please take care  
and use the gloves provided.

Black Anodised Satin Aluminium and Inox  
Anodised Satin Aluminium: Use a lightly  
damp soft dust cloth and gently go over marks  
until clean. Dry it afterwards with a soft dust  
cloth.

Glass tube: Remove the bulb from the  
product. Using a lightly damp cloth, clean only  
the outside of the tube and dry it with a dry  
soft dust cloth. Only put the glass bulb back  
on the product once it is fully dry.