

YUH - Electronics Function

26000-I2

1/2

Wall:

Table+Floor:

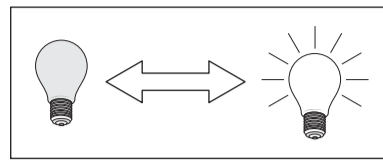
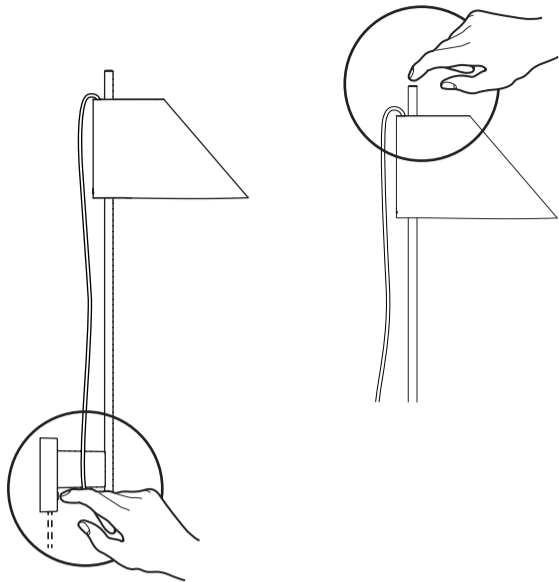

Power on/off:

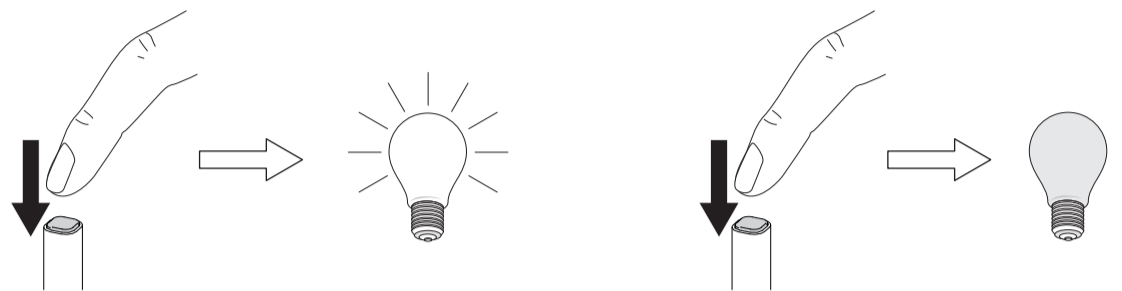

Dimming Function:

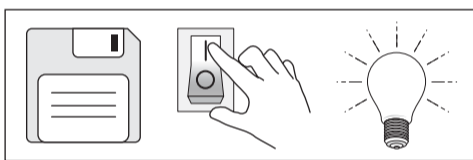
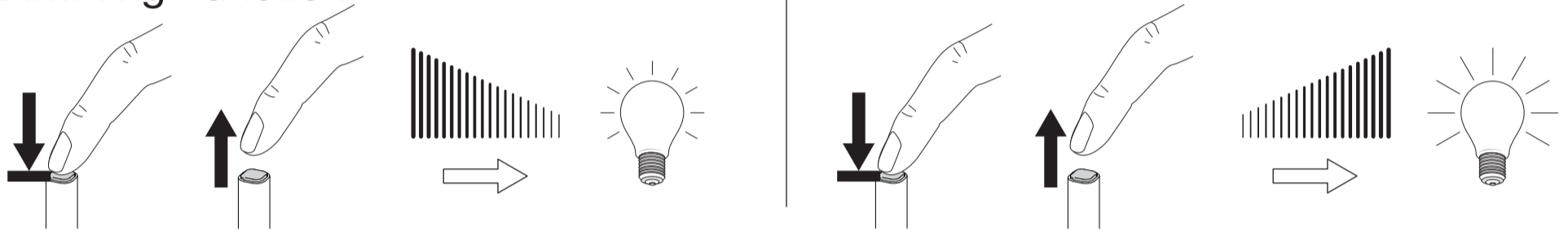

Set default brightness level (User Function) when connected to power:
 Factory reset to deactivate brightness level when set

A

1.

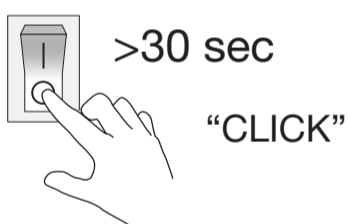

Power off
(min 30 sec)

2.



Press & hold

Power on

x 1 Flash

3.

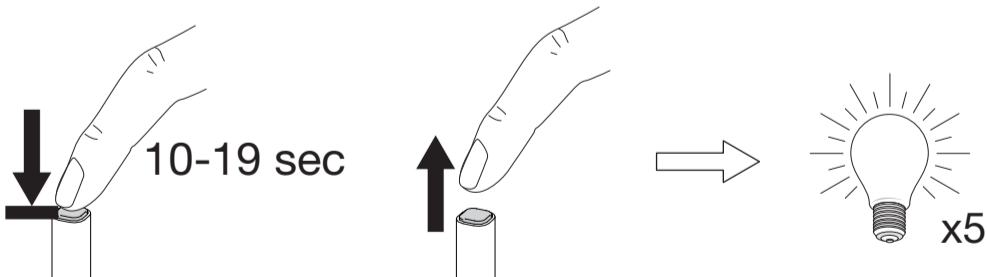

Continue press & hold
(min 10 sec - max 19 sec)

x 5 Flash

4.

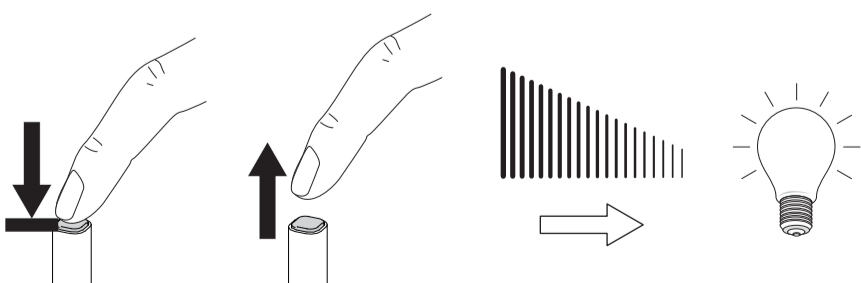

Turn light on

Dim light to desired brightness level

5.

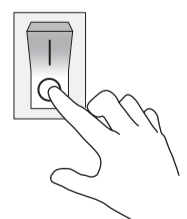

Power off
(min 30 sec)

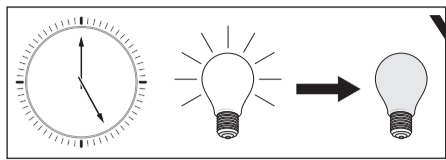

B Timing Function (User Function) Set timer to automatically turn off after period of time

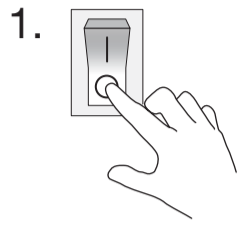

Power off
(min 30 sec)

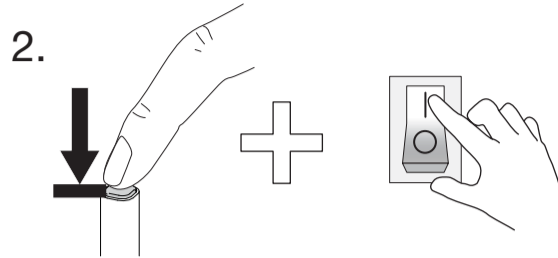

Press & hold

Power on

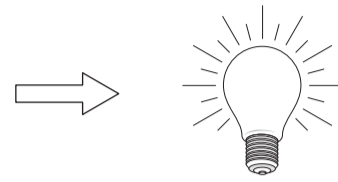

x 1 Flash

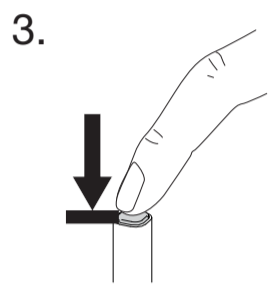

Continue press & hold
(min 5 sec - max 9 sec)

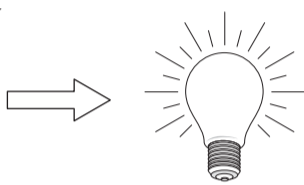
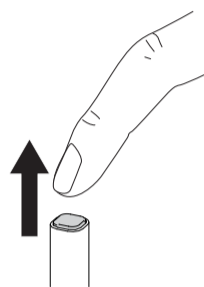

x 1 Flash

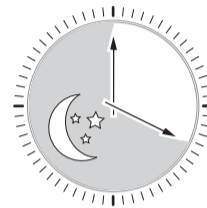

4 hours



Power off
(min 30 sec)



Repeat 1.-3.

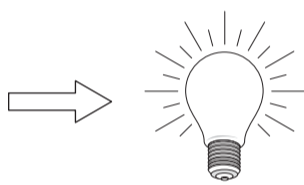

x 2 Flash

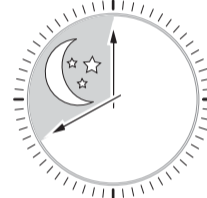

8 hours



x 3 Flash

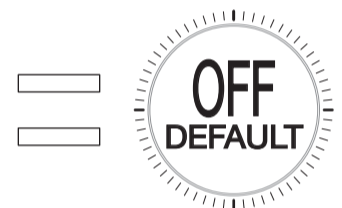

Timing function off



Restore factory default settings:

This is the standard setting for this product.

With this setting the on/off button and dimming function is active.

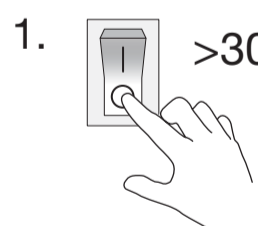

>30 sec

"CLICK"

Power off
(min 30 sec)

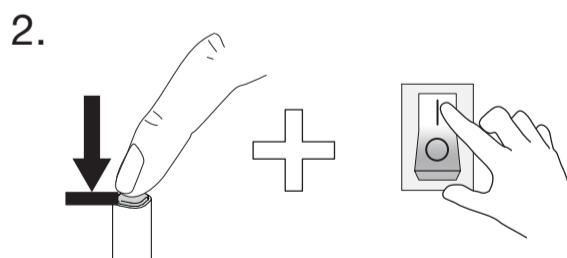

Press & hold

Power on

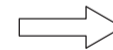

x 1 Flash

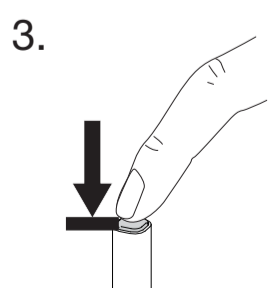

Continue press & hold
(min 20 sec)

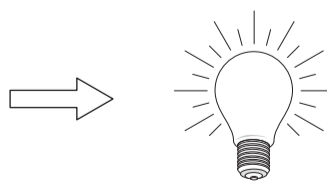
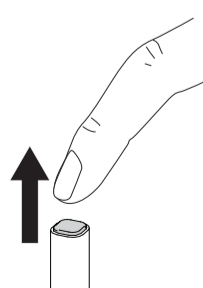

x 25 Flash

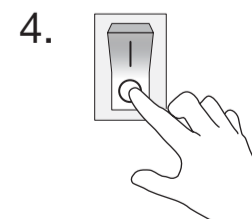

Power off
(min 30 sec)