

FLOS

F4190009 White



Mini Glo-Ball Ceiling/Wall Mirror

Designed by Jasper Morrison, 2002

Halogen - 25W

Lamp for ceiling, wall or mirror providing diffused light. Diffuser consisting of an externally acidetched, hand blown, flashed opaline glass and of a white, injection-molded PPS threaded ring nut. Injection-molded PPS white mirror ring nut. MIRROR HOLE: \varnothing 35 mm.

Are you a professional and your project needs consulting and support?

BOOK AN APPOINTMENT

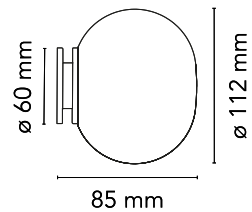

Main specifications

EAN	8059607019986
Mounting	Mirror mounted
Environments	Indoor dry location
Light Source Type	Bulb
Lamp category	Halogen
Lamp holders	G9
Iicos	HSGS
Number of heads	1
Power (W)	25

Physical

Colour	White
Net weight (kg)	0.29
Package height (mm)	190
Package width (mm)	190
Package length (mm)	190
Package volume (m3)	0.01
IP internal	40

Download

Mounting instructions [↓ PDF](#)

Spare Parts [↓ PDF](#)

Photometric Files

LDT / IES [↓ LDT](#)

Technical Drawings

2D [↓ ZIP](#)

3D [↓ ZIP](#)

[Bim](#) [↓ ZIP](#)



IP
40

Schematic light drawing

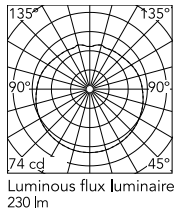

Photometric

Lighting type	Total
Light distribution	Roto symmetric

Electrical

Insulation class	II
Frequency (Hz)	50/60
Main voltage (Vac)	220-250
LED voltage Vf (Vdc)	null
Dimmable	Yes
Dimming interface	Remote Dimmable (Dimmer Not Included)
Batteries inside	No
Charging min time	No

Bulbs



NOT INCLUDED

RF28425

LED BiPin Lamp G9 3W 2700K
Non Dimmable



NOT INCLUDED

RF26520

LED Lamp 2W 240lm G9 220-
240 2700K T13 Non Dimmable

Spare Parts

- | | | |
|-----|---|-----------|
| 01. | Mini Glo-Ball Ceiling/Wall & Table
new diffuser assembly | RF4190400 |
| 02. | Ring nut & gasket kit | RF4190300 |

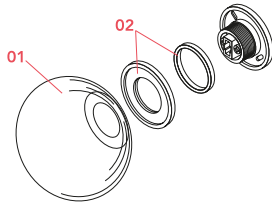

DOWNLOAD



RF4190400

Mini Glo-Ball Ceiling/Wall & Table
new diffuser assembly



RF4190300

Ring nut & gasket kit

FLOS

F4194009 White



Mini Glo-Ball Ceiling/Wall

Designed by Jasper Morrison, 2002

Halogen - 25W

Lamp for ceiling or wall providing diffused light. Diffuser consisting of an externally acidetched, hand blown, flashed opaline glass and of a white, injection-molded PPS threaded ring nut.

Are you a professional and your project needs consulting and support?

[BOOK AN APPOINTMENT](#)

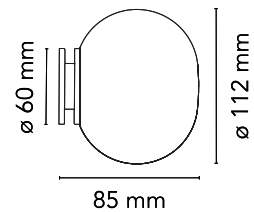

Main specifications

EAN	8059607020050
Mounting	Ceiling and wall surface
Environments	Indoor dry location
Light Source Type	Bulb
Lamp category	Halogen
Lamp holders	G9
Icos	HSGS
Number of heads	1
Power (W)	25

Physical

Colour	White
Net weight (kg)	0.45
Package height (mm)	190
Package width (mm)	190
Package length (mm)	190
Package volume (m3)	0.01
IP internal	44

Download

[Mounting instructions](#) PDF

[Spare Parts](#) PDF

Photometric Files

[LDT / IES](#) LDT

Technical Drawings

[2D](#) ZIP

[3D](#) ZIP

[Bim](#) ZIP



IP
44

Schematic light drawing

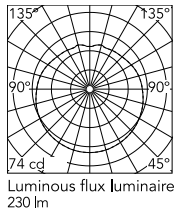

Photometric

Lighting type	Total
Light distribution	Roto symmetric

Electrical

Insulation class	II
Frequency (Hz)	50/60
Main voltage (Vac)	220-250
LED voltage Vf (Vdc)	null
Dimmable	Yes
Dimming interface	Remote Dimmable (Dimmer Not Included)
Batteries inside	No
Charging min time	No

Bulbs



NOT INCLUDED

RF28425

LED BiPin Lamp G9 3W 2700K
Non Dimmable



NOT INCLUDED

RF26520

LED Lamp 2W 240lm G9 220-
240 2700K T13 Non Dimmable

Spare Parts

01. Mini Glo-Ball Ceiling/Wall & Table RF4190400
new diffuser assembly

DOWNLOAD

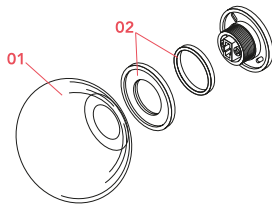



RF4190400

Mini Glo-Ball Ceiling/Wall & Table
new diffuser assembly