

MICHAELANASTASSIADES

INSTALLATION INSTRUCTIONS



BRASS ARCHITECTURAL COLLECTION
PENDANTS, 2017

PRODUCT SPECIFICATIONS

Pendant 80

Bulb specifications: 120V / 240V
G9 maximum wattage: 25W
120V / 240V dimmable LED triac
Product weight: ~2kg

Pendant 150

Bulb specifications: 120V / 240V
G9 maximum wattage: 40W
120V / 240V dimmable LED triac
Product weight: ~3kg

Pendant 250

Bulb specifications: 120V / 240V
E26 / E27 maximum wattage: 75W
120V / 240V dimmable LED triac
Product weight: ~4kg

Pendant 350

Bulb specifications: 120V / 240V
E26 / E27 maximum wattage: 150W
120V / 240V dimmable LED triac
Product weight: ~5kg

All Pendants are rated
IP 20: Indoor Use Only

BEFORE INSTALLING

Please keep these instructions for future reference. Please read instructions in full prior to installation noting all illustrations. Instructions should be followed precisely. If in any doubt about electrical safety, contact a qualified electrician.

Installation should always be carried out by a qualified electrician or a competent person in accordance with your current electrical regulation.

The electricity supply should always be isolated at its source (fuse box) before attempting any installation or maintenance. Please do not fit bulbs exceeding the maximum allowable wattage.

Ensure the circuit, to which the fixture is to be connected, has been installed and fused in accordance with your local electrical standards.

If the external flexible cable or cord is damaged, it should be replaced exclusively by MICHAEL ANASTASSIADES or a similar qualified person to avoid a hazard.

Please see the latest IEE Wiring Regulations for full details.

If a bulb requires replacement, always switch off the mains power and allow the fixture to cool.

Position the fixture where desired, ensuring that the area is suitable to support the weight of the fixture.

Determine the fixing method appropriate to the surface material.

Modifying any part of the fixture will void the products warranty.

MICHAEL ANASTASSIADES takes no responsibility for incorrectly installed lights & recommends that all fixtures should be installed by a qualified electrician.

CLEANING INSTRUCTIONS

Before cleaning, lighting fixtures must be turned off and unplugged from mains electricity. Whilst cleaning please take care and use the gloves provided.

Polished brass: As the item is unlacquered it will naturally oxidise and darken. Upon touching the items without gloves, fingerprints are likely to occur and leave marks. Use a good quality brass cleaning liquid and follow the product instructions using the extra soft dust cloth. Do not apply pressure on persistent marks. Remove them using repeated gentle motions and by reapplying the brass cleaning liquid.

Polished nickel: Use a lightly damp soft dust cloth and gently go over marks until clean. Dry it afterwards with a soft dust cloth. Make sure the product is completely dry before switching the electricity on.

Patinated Finish: Use a dry soft dust cloth and gently go over marks until clean. The brass patina is achieved through an artisanal technique of applying pigments by hand during a hot patination process. Through this alchemic process, the brass is transformed whilst retaining the material's inherent qualities. It will mature and change overtime. The manner and speed in which it will change will depend on the environment, handling and the level and frequency of maintenance. Verdigris can also appear when the copper in the brass begins to oxidise.

Opaline glass: Remove the opaline glass from the product. Using a lightly damp cloth, clean only the outside of the sphere. Only put the glass sphere back on the product once it is fully dry.

Collection

SMALL CEILING ROSE
only for 240V

LARGE CEILING ROSE
120V / 240V

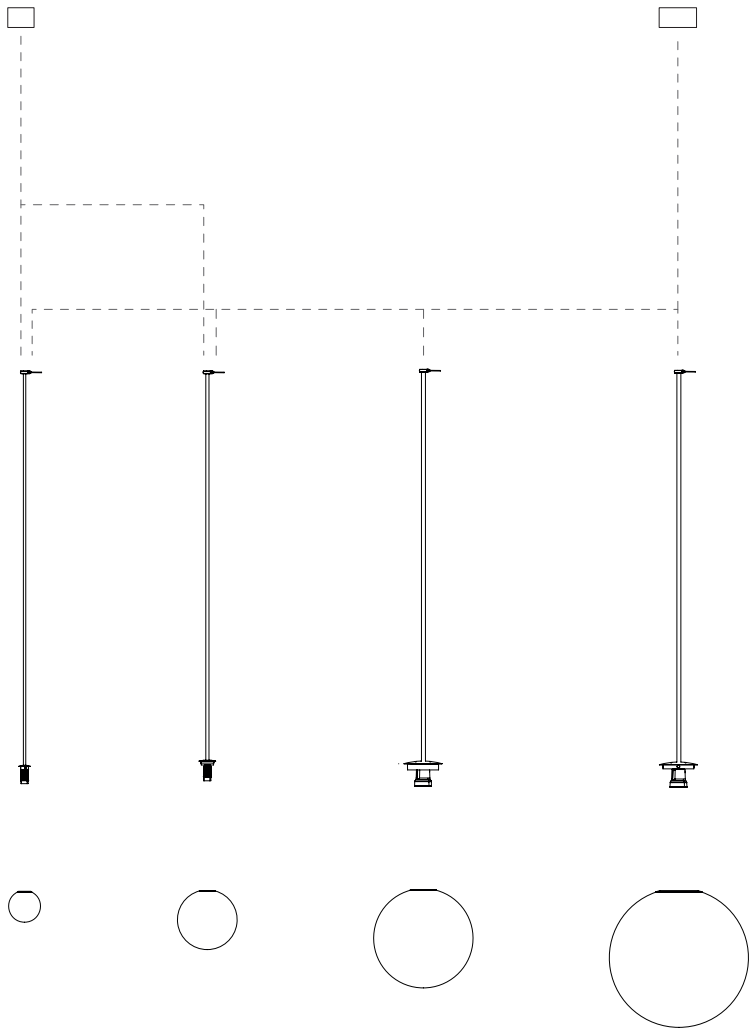

PENDANT 80

PENDANT 150

PENDANT 250

PENDANT 350

Parts Supplied

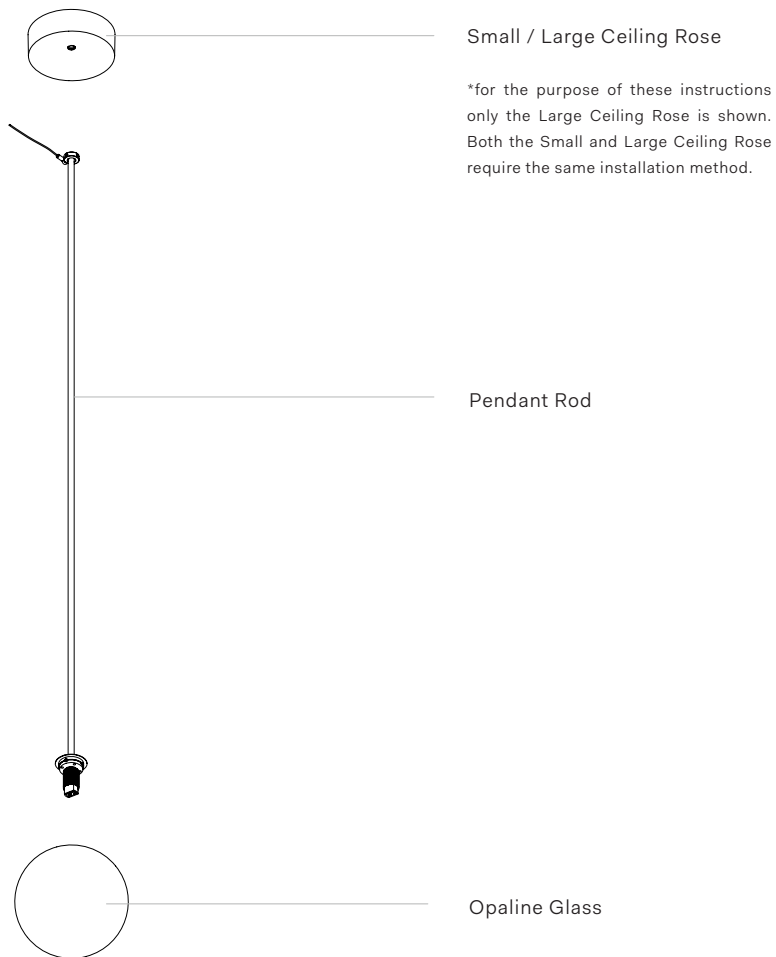

Additional Items Provided

Pair of Gloves
Allen Key - 2mm

INSTALLATION PREPARATION

Whilst installing the fixture, please take care and use the gloves provided.

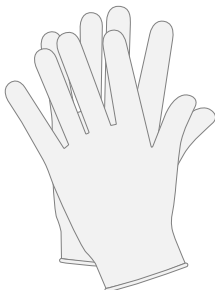

Turn off the electrical supply at the fuse box.

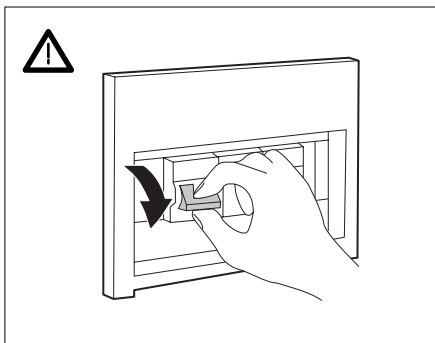

Use the guide below to ensure you follow the instructions that are relevant to your fixture.

| | | | | | | | |
|-----------------------|-------|--------|-------|-------|-------|-------|-------|
| BAC Pendants, 240V | Fig.1 | Fig.2 | Fig.4 | Fig.5 | Fig.6 | Fig.7 | Fig.8 |
| | Fig.9 | Fig.10 | | | | | |
| BAC Pendants, 120V | Fig.1 | Fig.3 | Fig.4 | Fig.5 | Fig.6 | Fig.7 | Fig.8 |
| | Fig.9 | Fig.10 | | | | | |

Fig. 1

Loosen the grub screw (A) using the allen key provided (B). Rotate the lamp body (C) anti-clockwise to unlock and release from the backplate (D).

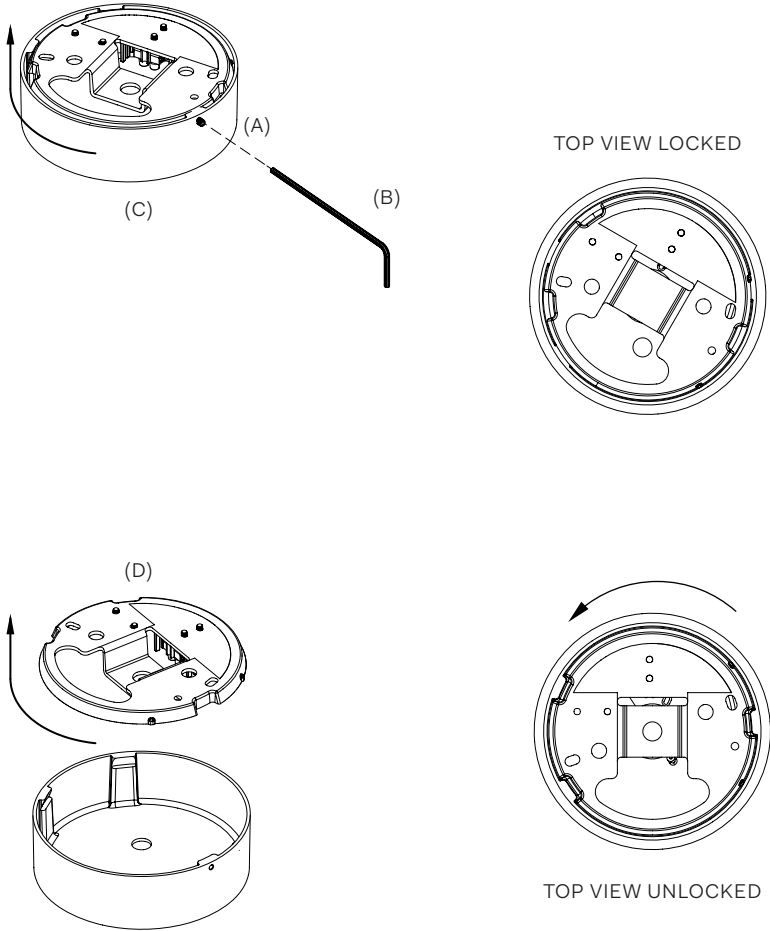

Fig. 2 For 240V Fittings

Place the back plate (D) onto the ceiling, centre it to the mains electrical supply cable and mark two holes to be drilled. Once drilled, insert wall anchors into the holes, ensuring that the area is able to support the entire weight of the fixture (noted on product specification). Screw the back plate onto the ceiling, making sure it is levelled.

Ceiling anchors and mounting screws are not supplied for this fixture. Determine the fixing method appropriate to the surface material before starting the project. Use fixings that are suited to the surface material and are sufficient to bear the weight of the light.

Go to Fig.4 for next step.

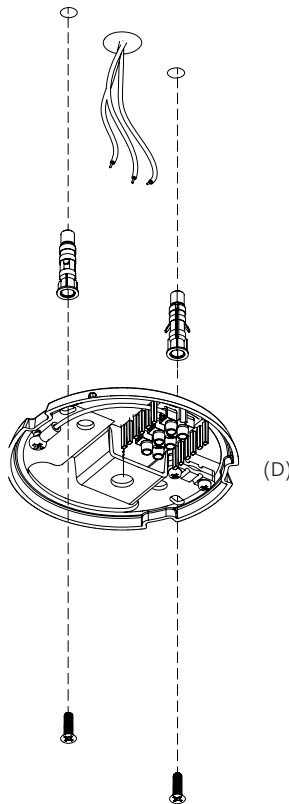

Fig. 3 For 120V Fittings

Screw the backplate (D) onto the junction box, making sure it is levelled. Pull live, neutral and ground cables out through the central hole. Mounting screws are not supplied with this fixture as J-boxes can vary.

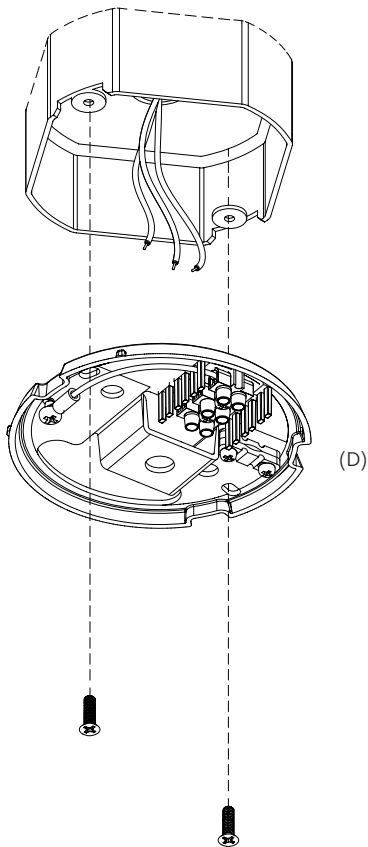

Fig. 4

Loosen the grub screws from the rod lock (F), ensuring not to remove them completely. Then place the rod lock in the mounting plate (D). Carefully pass the pendant rod (G) through the ceiling rose (C) taking care not to damage the finish on the pendant rod.

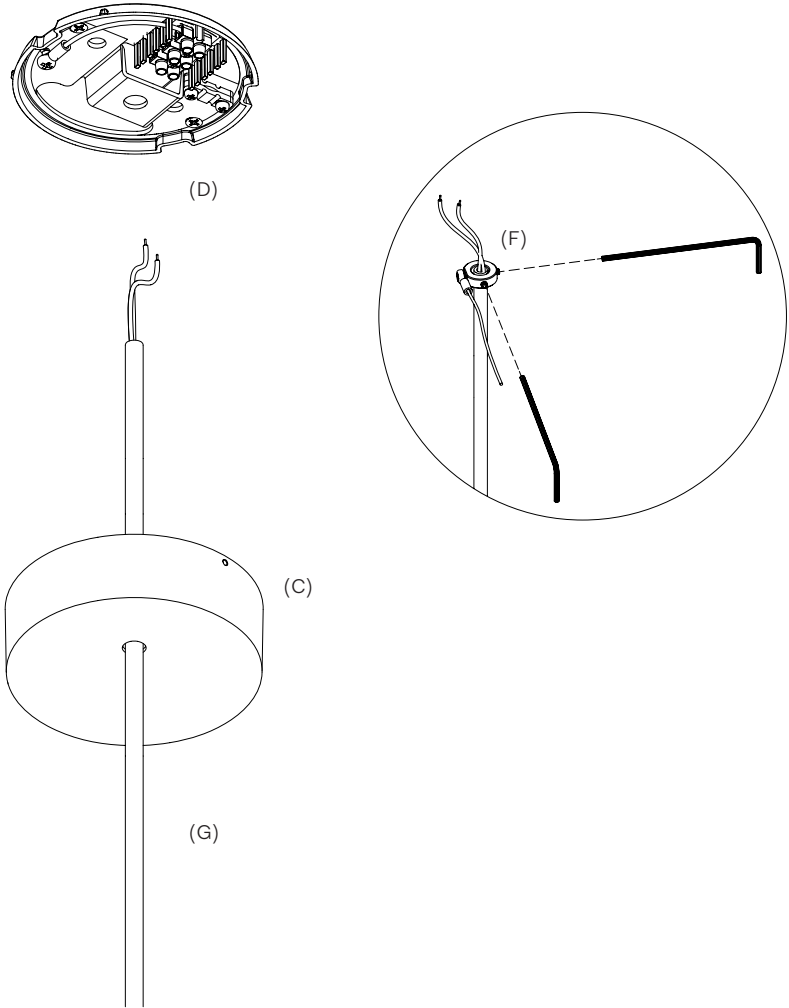
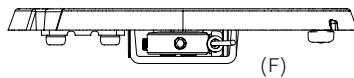
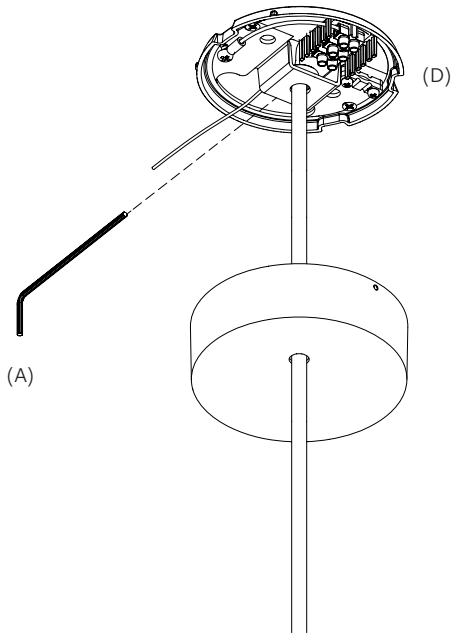

Fig. 5

Thread the pendant rod (G) through the mounting plate (D) and the rod lock (F). Use the allen key (A) to tighten the grub screws to secure the fixture. When doing so make sure that another person is securely holding the ceiling rose (C), taking care not to damage the finish on the pendant rod.



FRONT VIEW

Fig. 6

Feed the mains cables through the mounting plate (D). Connect the live, neutral and earth of the mains electrical cable to the connectors of the fixture. Make sure all electrical cables match correctly.

See Cable Connection Guide for further reference.

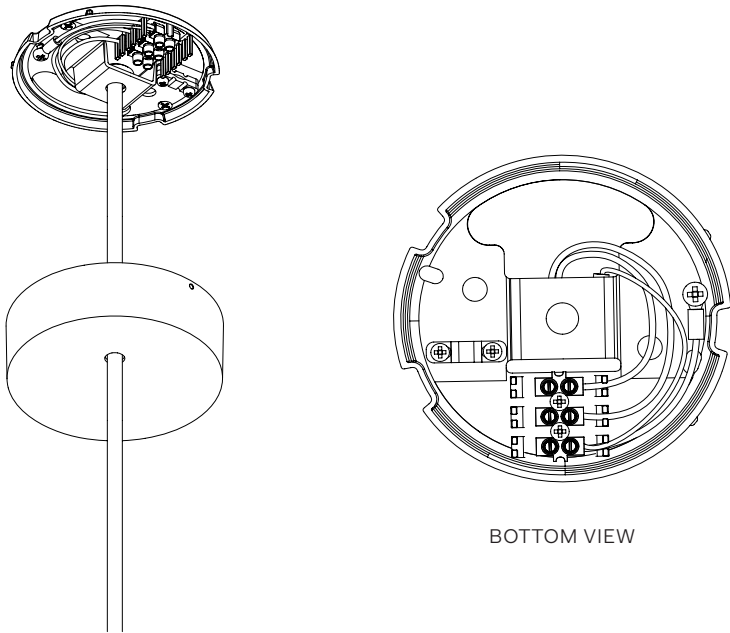

Cable Connection Guide

Lamp fixture cables

Live (L)

Neutral (N)

Earth (E)

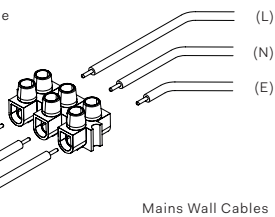

Mains Wall Cables

Fig. 7

Feed the electrical cables through the central hole and secure them using the cord grip (E).

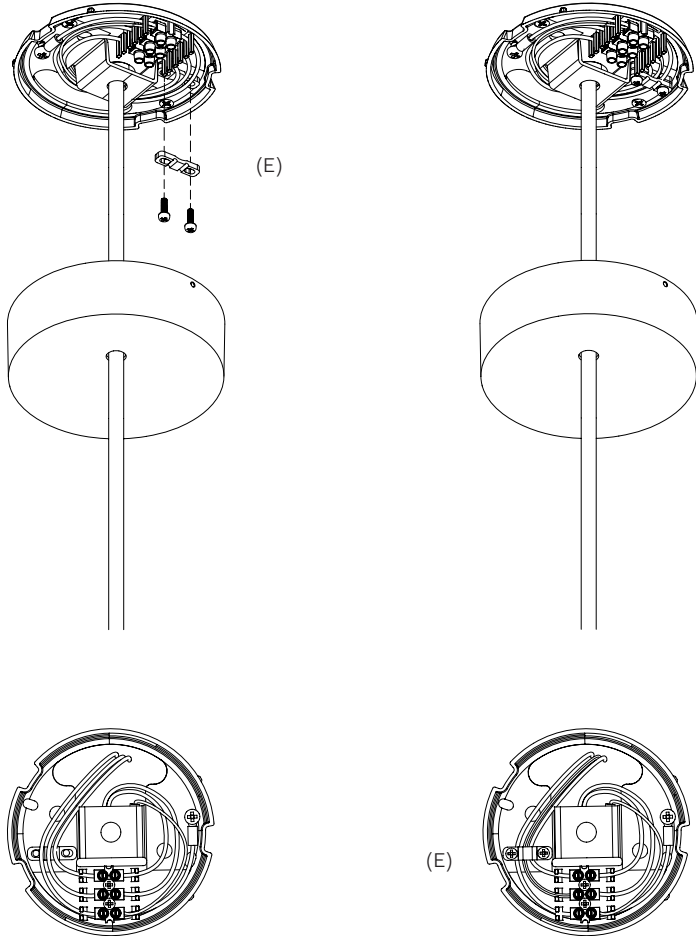

BOTTOM VIEW

Fig. 8

Bring the ceiling rose (C) onto the backplate (D) and secure to the ceiling. Rotate the ceiling rose (C) clockwise to secure it with the backplate. Insert and tighten the grub screw (A) using the allen key provided (B).

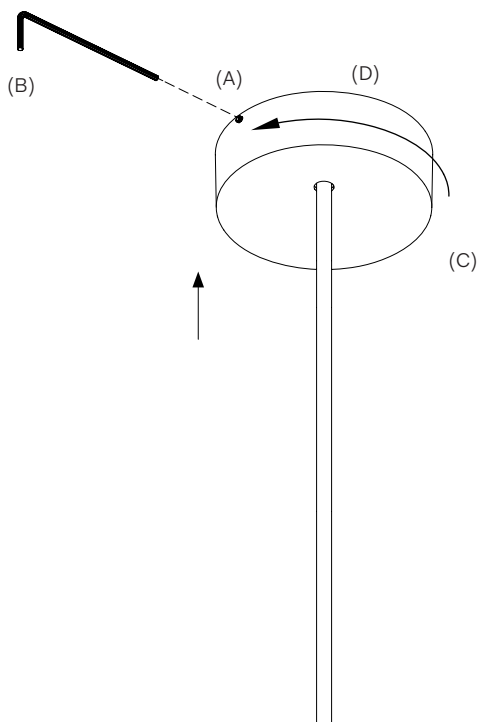
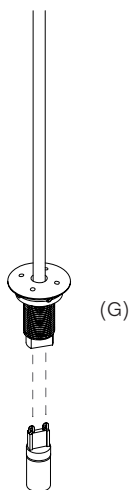
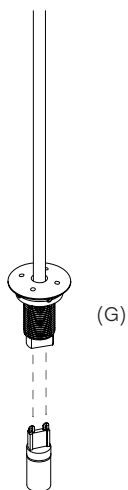

Fig. 9

For Pendant 80 and Pendant 150 insert the G9 LED bulb into the bulb holder (G).
For Pendant 250 and Pendant 350 screw the bulb, into the bulb holder (H) .



PENDANT 80



PENDANT 150

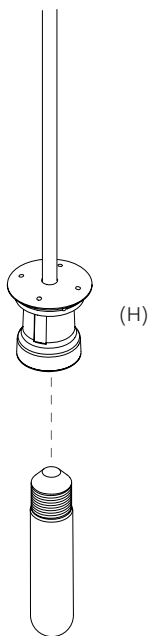

PENDANT 250

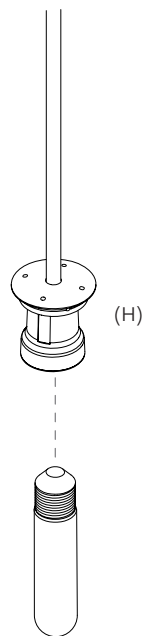

PENDANT 350

Fig. 10

Screw the opaline glass onto the lamp holder.

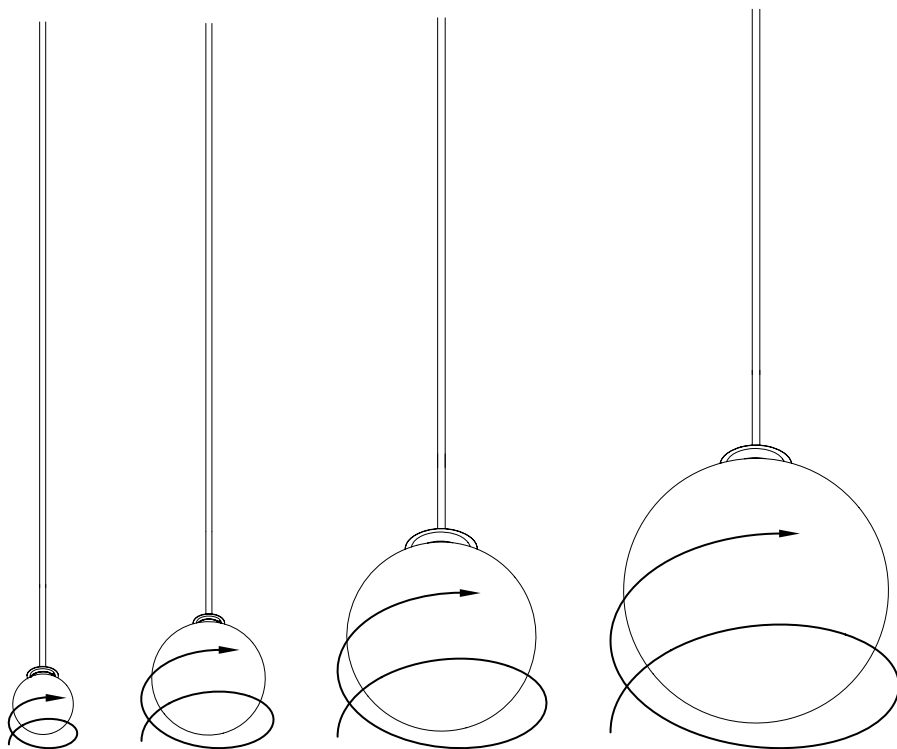

PENDANT 80

PENDANT 150

PENDANT 250

PENDANT 350

Michael Anastassiades' design philosophy is to preserve the inherent qualities of given materials. All of our products are handmade and come in natural finishes, exposed to the elements without any protective lacquers. We look at oxidisation as part of a process that adds to the patina of an object, increasing beauty with time. We try our best for all goods to leave our premises in pristine condition, but sometimes products may arrive with minor oxidisation marks.

Whilst every effort is made to ensure an accurate representation of product colours, finishes and dimensions, Michael Anastassiades Ltd reserves the right to alter these details without notice, in compliance with its own production needs, technological changes or in response to the current market needs. Colour swatches are for reference only; Michael Anastassiades Ltd cannot guarantee exact colour match for any product finishes.

All designs are protected under copyright law. Michael Anastassiades holds the exclusive manufacturing and distribution rights worldwide. Copying will be prosecuted.

All light fixtures in this catalogue have CE marking compliance.

Michael Anastassiades Ltd.
50 Rochester Place, London NW1 9JX
T +44 (0)20 7928 7527
sales@michaelanastassiades.com
www.michaelanastassiades.com
© 2024 Michael Anastassiades Ltd. All rights reserved.