



Description

The collection is a showcase of original design and refined combinations of materials, such as glass, metal, and leather. It features a tubular LED light source with a range of colour temperatures to choose from.

Tech. description

The light comprises a glass shade, leather suspension straps, and tubular LED module with triplex opal glass diffuser. The LED module uses a Brokis connector. The entire assembly is secured with dural endcaps. The light is hung from a ceiling canopy, which also houses the electronics and terminal connectors.



Colours options: https://brokis.sharepoint.com/:b:/s/brokis_sp/EfK0Av2TO-5IkY7E5kdbw0sBLjdZs_LRcAcACdgzHOPDRA

CONSTRUCTION SPECIFICATION

Weight:	15.5 kg
Construction material:	glass, metal, leather
Cord length [mm]:	2,200 mm
Mounting:	Ceiling
Environment:	Indoor

DIMENSIONS [mm]

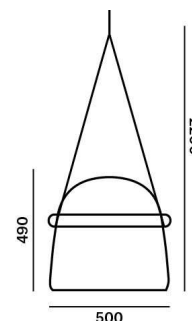

ELECTRICAL SPECIFICATION

Input voltage [V]:	100 - 240 V
Frequency [Hz]:	50-60 Hz
Max. power [W]:	12.5 W
Coverage IP:	20
Socket:	non-user replaceable LED module
Light source:	-
Energy class:	A+

CERTIFICATIONS





CP10301

Type	LED module
Lamp wattage [W]	12.5 W
Input voltage [V]	24 VDC
Energy class	A+
Flux [lm]	915 lm
Light colour [K]	2700 K
CRI	80+
Lifespan [h]	20000h
Dimmable	yes (PWM)



DATASHEET

RECOMENDED CANOPY



Download

CEILING CANOPY

Dimensions $O \times w$ [mm]	280 x 50 mm
Weight [kg]	1.6 kg
Material	metal

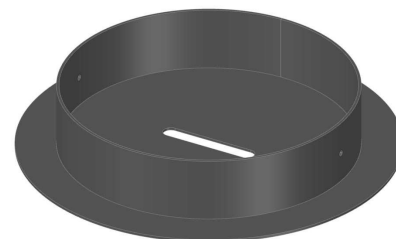

Drawing

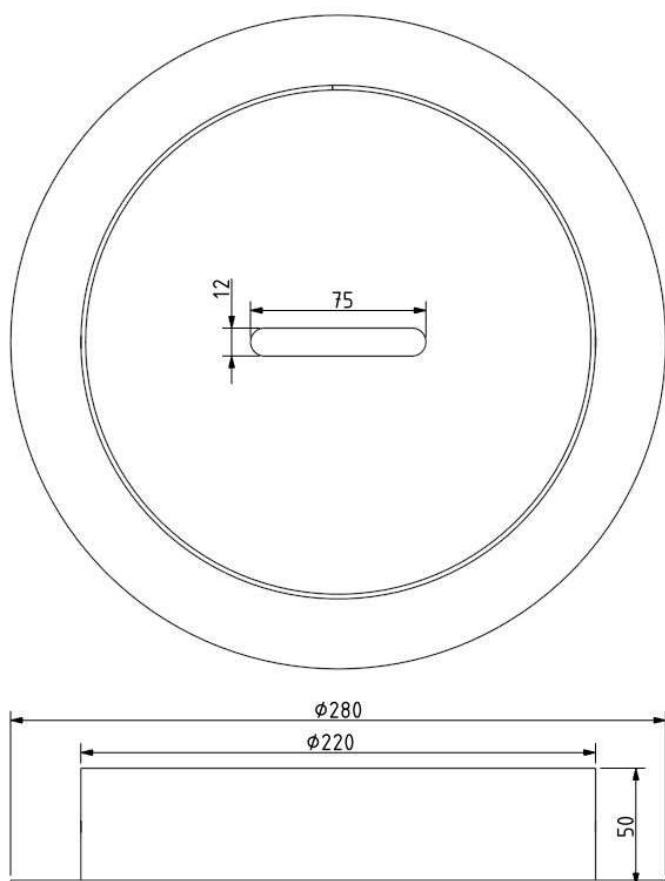

Canopy bracket

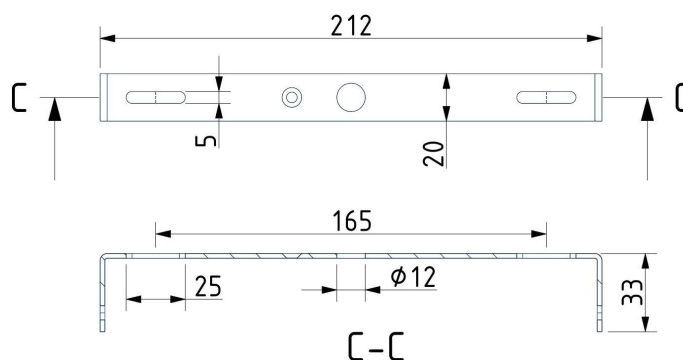

BROKIS S.R.O.
ŠPANIELOVA 1315/25
163 00 PRAHA 6 - ŘEPY
CZECH REPUBLIC

ORG ID 64940799
VAT ID CZ64940799
C 42174 MĚSTSKÝ SOUD
V PRAZE

TEL +420 567 211 517
TECHNICAL@BROKIS.CZ
INFO@BROKIS.CZ
WWW.BROKIS.CZ

2020_09
PAGE 3