

BROKIS®



CM12097

# BONBORI

PC1165



Download

### COMPONENTS INCLUDED WITH UNIT:

- 1x lamp body
- 1x upper section
- 1x cap
- 1x light source
- 1x glass shade
- 1x glass diffuser
- 1x pair cotton gloves
- 1x installation manual
- 3x M6x16 set screws
- 3x M6x25 hex screws
- 1x M4x4 set screw
- 1x power cable with connector
- 1x hex key size 1,5
- 1x hex key size 2

### WARNING:

**The manufacturer assumes no liability for damage resulting from incorrect assembly. When unpacking the light, do so with regard for its material composition – the main components are made of glass.**

**Wear the cotton gloves included with the light when unpacking and assembling it.**

**Installation time: 30 minutes / 1 person**



BROKIS®

BROKIS S.R.O.  
ŠPANILOVA 1315/25  
163 00 PRAHA 6 - ŘEPY  
CZECH REPUBLIC

ORG. ID 64940799  
VAT ID CZ64940799  
C 42174 MĚSTSKÝ SOUD  
V PRAZE

TEL +420 567 211 517  
TECHNICAL@BROKIS.CZ  
INFO@BROKIS.CZ  
WWW.BROKIS.CZ



### CLEANING THE GLASS

**BROKIS applies the highest possible quality standards in manufacturing its lights. Prior to shipping, each light undergoes several quality controls and stages of cleaning. Lights may require additional cleaning as a result of transportation, storage, and the amount of time that passes between packing in our plant and subsequent unpacking by the client. Therefore, we emphasize cleaning the lights prior to installation.**

**The glass must first be rinsed in hot water, with a dilution of a dish-detergent used to remove all foreign particles and dust. Eventually repeat this basic treatment, if necessary. Afterwards the glass must have a second cleaning using hot water, with a dilution of a de-greaser (such as ammonia or vinegar). The glass must then be thoroughly rinsed with running hot water. Eventually repeat this treatment, if necessary. The glass is then thoroughly dried with a paper towel or a clean soft cotton towel. Only re-assemble the glass to the lamp body, when completely cooled down.**

**Do not use mineral spirits, highly concentrated thinners, or other substances not intended for use on glass surfaces. Also: do not use products, containing silicones – since they will rapidly attract more dust and grease.**

**PRIOR TO SHIPPING, THE FUNCTIONALITY OF EACH LIGHT AND ITS COMPONENTS IS THOROUGHLY TESTED. THE MANUFACTURER ASSUMES NO LIABILITY FOR THE MISHANDLING OF PRODUCTS.**



## 1. ASSEMBLING THE LIGHT

Screw the light source into the fixture.

Insert the diffuser into the top of the body. When doing so, hold the body at an angle to prevent damage to the diffuser, then return it to a vertical position.

Insert the diffuser into the light through the open side!

Turn the 3 set screws (M6x16) from the inside of the body so that they are flush with the outer surface of the light.

Position the upper section on the set screws (M6x16) and turn it to secure the bayonet.

Tighten the set screw (M4x4) at the top of the body to prevent the upper section from turning.

Position the glass shade on the body with the larger opening facing downwards and install 3 set screws (M6x25) into the holes in the upper section.

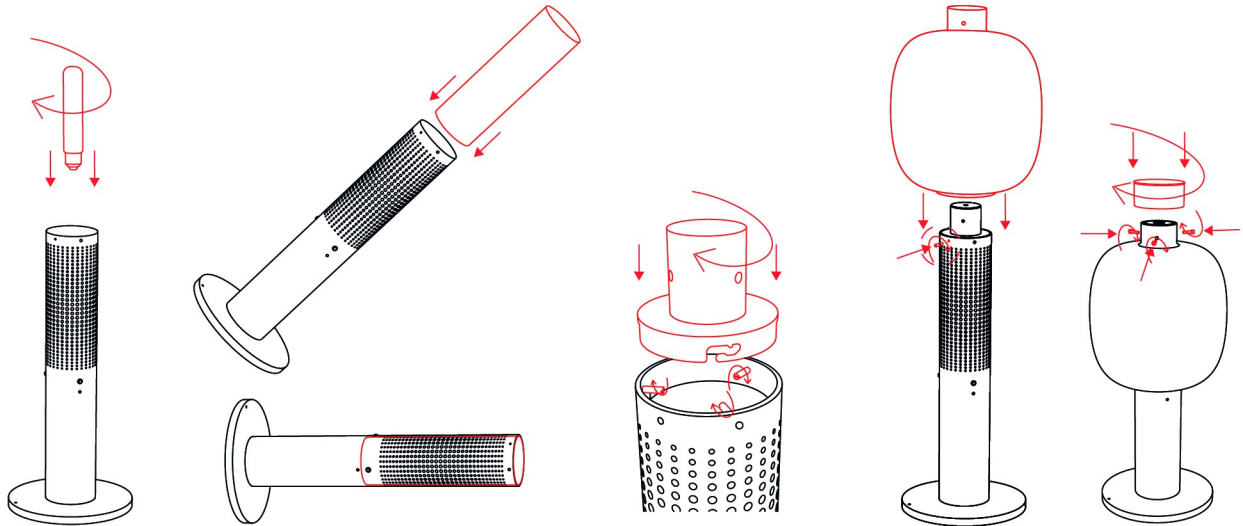

## 2. CONNECTING THE LIGHT

Loosen the set screw (M3x3) on the power cable connector. Insert the cable connector into the connector on the light and turn the sleeve to close. Retighten the set screw in the connector.

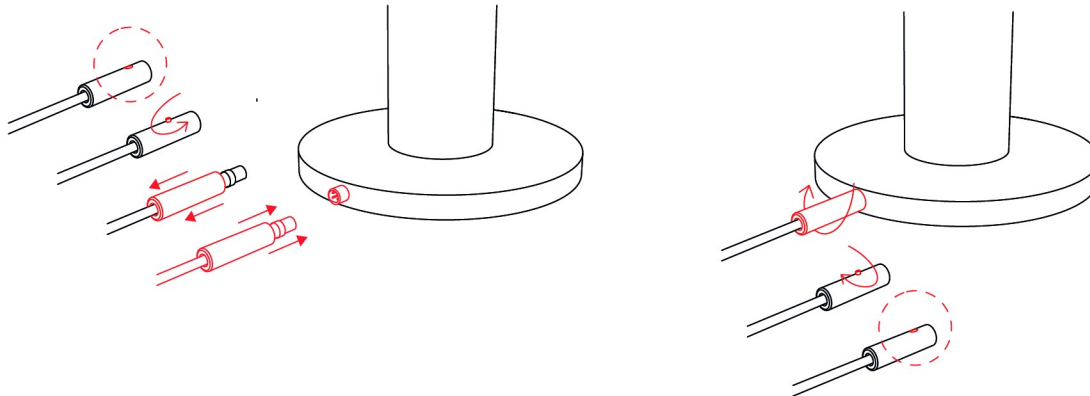

### 3. SWITCHING ON THE LIGHT

Plug the power cable into an electrical outlet and verify that the light works properly.

