

approx 1.4kg (3lb)

adjustable
up to 3000 (10')
standard

adjustable
up to 30500
(100')
custom

- PENDANTS: one
- MOUNTING: mini canopy 30mm (1.2") in diameter x 11mm (0.4") deep
- LAMPING: 1.5w LED or 10w xenon
- COAX: adjustable. 3000mm (10') standard / up to 30500mm (100') maximum
- MATERIALS: pulled glass, braided metal coaxial cable, electrical components, brushed nickel canopy
- WEIGHT: approximately 1.4kg (3lb)
- POWER SUPPLIES: remote mounted (fixture does not hook directly to a junction box). Power supplies included

DESCRIPTION

The 'm' designation in this 87 variant refers to the mini canopy. The mini canopy is just over 30mm (1.2") in diameter and 11mm (0.4") deep, which creates a subtle profile that will essentially disappear into the application surface. The pendant drop length on this light fixture is adjustable up to the specified maximum.

A matrix of hot glass is stretched and folded back onto itself numerous times as it cools. Air is trapped between the folds and stretched along the grain of the loop, creating microfilaments that give the piece a pearlescent optical quality. A light source is introduced at one end of the loop casting light through the microfilaments and registering a gentle gradient.

NOTES

- + Purchase replacement lamps online at www.bocci.com/shop/bulbs
- + Unless otherwise noted when ordering, all chandeliers will be outfitted to be xenon compatible.
- + Unless otherwise specified, a single class 2 power supply will be sent for every 5 xenon fixtures or every 12 LED fixtures

Worldwide patents pending
EU Patent # 03611144 - 0005-0009

Made in Vancouver, Canada

Vancouver
sales@bocci.com
www.bocci.com

Berlin
europe@bocci.com
www.bocci.com



SWAG - MINI CANOPY

87.1m

Design by Omer Arbel
PRODUCT SPECIFICATION

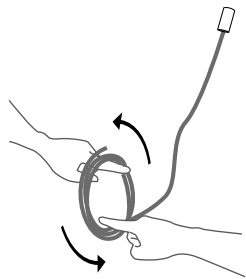

1

Very carefully uncoil the braided coaxial cable in a spool like manner. Insert your index fingers into opposite sides of the roll then rotate your fingers around each other to unroll the coaxial cable.

Use patience: allow the cable to uncoil completely to avoid kinks.

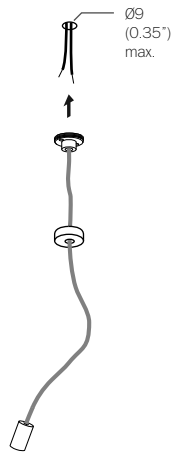

2

Drill a maximum 9mm (0.35") diameter hole in ceiling material. Pull low voltage house wire through the hole.

Note: There MUST be adequate backing, not just the drywall. This low voltage wire will run to a remote mounted power supply.

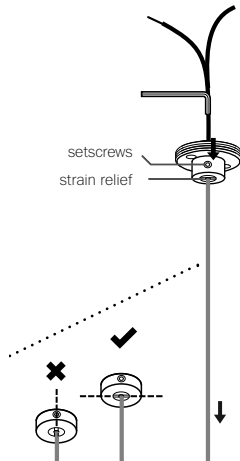

3

Thread the coaxial cable through the canopy, use a 2mm Allen key to loosen the setscrew in the canopy and gently feed the cable through until you have reached your desired drop length.

Use Allen key to tighten the setscrew to hold the strain relief and secure the coaxial cable at its new length. Perform a gentle tug test to ensure it is secure.

DO NOT OVERTIGHTEN.

Note: The strain relief is a black plastic collar around the coaxial cable. There is a single slot opening on the side of the strain relief component. It is essential that this opening is oriented at 90 degrees to set screw chamber. There can be no contact between the set screw and the cable.

RISK OF ELECTRIC SHORT!

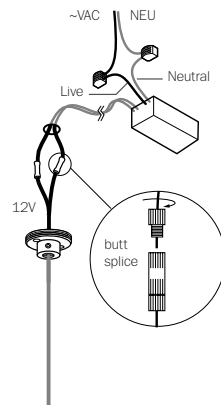

4

Primary: connect live and neutral power supply leads to supply wiring. Line with Live wire and Neutral with Neutral.

Secondary: Connect (+/-) wires to the coaxial cable using #16 butt splices, provided (stagger the splices).

For multiple pendant installations, ensure that the braided outer wires are all connected to one 12V output wire and all inner insulated wires are connected to the other or a short will occur.

Wires are 1.02mm (18AWG).

Note: Insulated core is positive and braided exterior is negative.

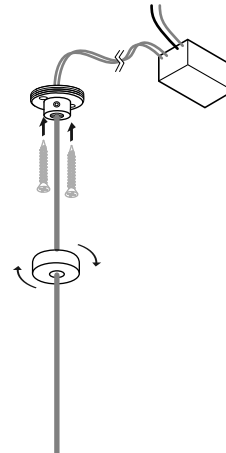

5

The client is responsible to ensure fasteners are attached to a robust structural substrate.

Affix mini-canopy to ceiling surface with fasteners provided. Twist the threaded cover into place.

Turn power to fixture on.

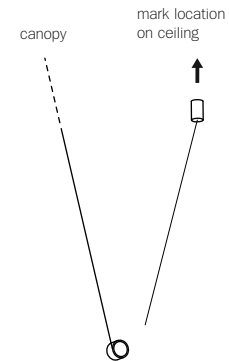

6

Check that each lamp is working properly as you go along.

Move pendant into location and mark the location for the swag hook screw on the ceiling.

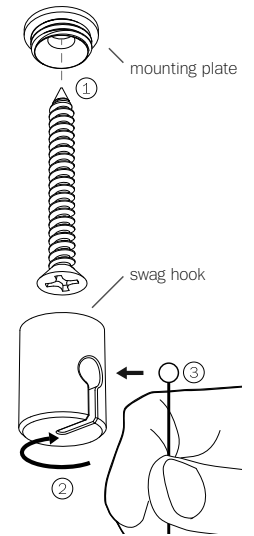

7

Ensure that the ceiling at the swag location is strong enough to hold 2kg (5lbs) before attaching swag hook with the provided screws.

Thread the swag hook on to the mounting plate, ensuring all the threads are engaged.

Slide the ball end of the aircraft into the slot on the swag hook.

SWAG - MINI CANOPY

87.1m

Design by Omer Arbel
PRODUCT INSTALLATION INSTRUCTIONS

© 2020, Bocci Design and Manufacturing Inc. All rights reserved. Any inquiries should be directed to: info@bocci.com

BOCCI

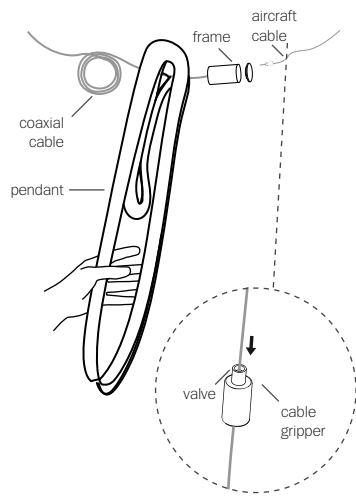

8

Push the valve on the cable gripper and adjust the position of the cable gripper so that the aircraft cable is roughly the same length as the coaxial cable.

Apply a load to the cable to ensure it is locked.

Thread the frame assembly through the top hole of the 87 pendant.

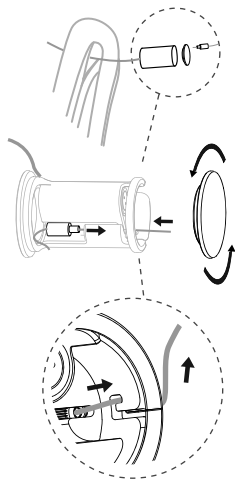

9

Unscrew frame cap opposite to the coaxial cable. Hook the cable gripper into the pocket inside the frame and guide the cable through the u-shaped hook in the frame and the silicone tube.

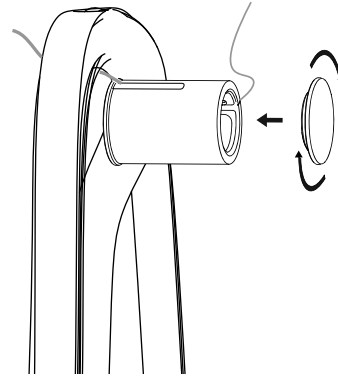

10

Screw frame cap back onto the frame assembly.

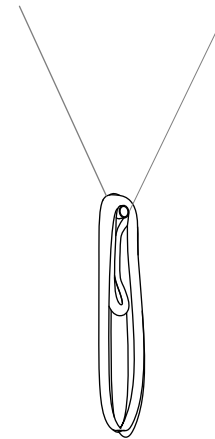

11

Rest pendant onto frame assembly.

If needed, repeat step 8 to adjust the position of frame.

Note: Frame assembly should hang level. The swag cable and the coaxial cable should be approximately the same length.

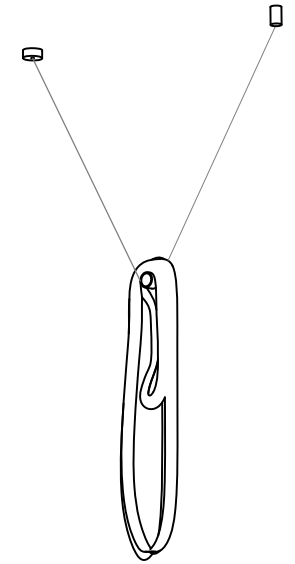

12

Clean fingerprints from surfaces.

For additional assistance, please contact Bocci:

Vancouver
sales@bocci.com
www.bocci.com

Berlin
europe@bocci.com
www.bocci.com

Worldwide patents pending
EU Patent # 03611144 - 0005-0009

Made in Vancouver, Canada



LOW VOLTAGE LUMINAIRE
E476186

SWAG - MINI CANOPY

87.1m

Design by Omer Arbel
PRODUCT INSTALLATION INSTRUCTIONS

© 2020, Bocci Design and Manufacturing Inc. All rights reserved. Any inquiries should be directed to: info@bocci.com

BOCCI

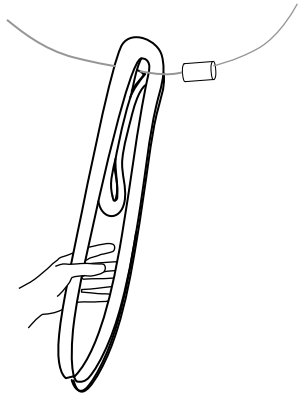

1

Lift glass off of lamp holder assembly and hold securely.

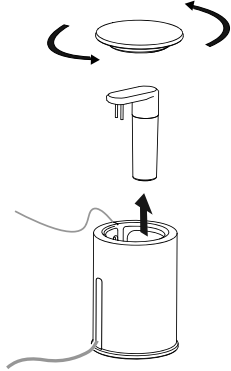

2

Unscrew cap at the aircraft cable end of the lamp holder assembly. Push coaxial cable through the slot in the silicone sheath, and remove lamp and lamp adapter.



3

Remove lamp from lamp adapter and replace with new bulb.

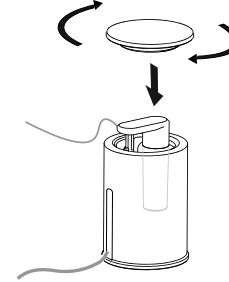

4

Screw cap back onto the lamp holder assembly.

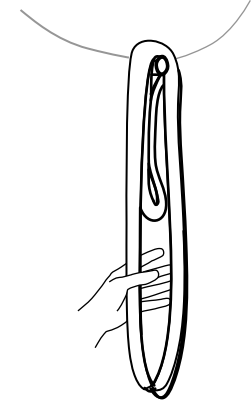

5

Gently rest pendant back onto lamp holder assembly.

Clean fingerprints from glass surfaces.

Turn power to fixture on.

For additional assistance,
please contact Bocci:

Vancouver
sales@bocci.com
www.bocci.com

Berlin
europe@bocci.com
www.bocci.com

Worldwide patents pending
EU Patent # 03611144 - 0005-0009

Made in Vancouver, Canada



LOW VOLTAGE LUMINAIRE
E476186

SWAG - MINI CANOPY

87.1m

Design by Omer Arbel
LAMP REPLACEMENT INSTRUCTIONS

© 2020, Bocci Design and Manufacturing Inc. All rights reserved. Any inquiries should be directed to: info@bocci.com

BOCCI

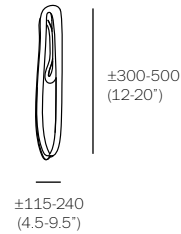
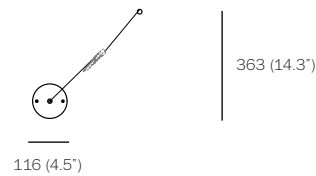
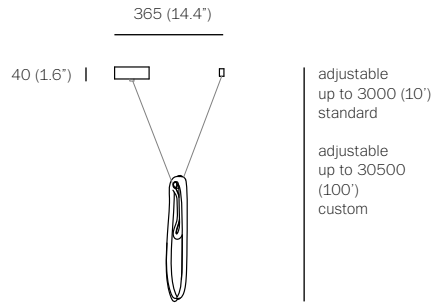
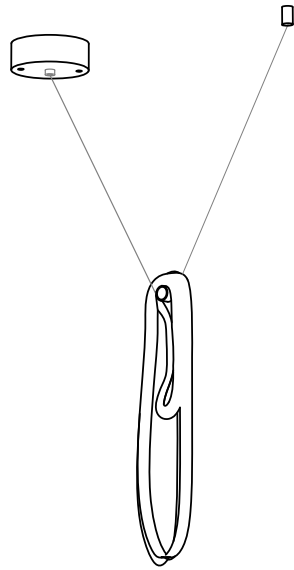

approx 1.4kg (3lb)

- PENDANTS: one
- MOUNTING: deep brushed nickel canopy 116mm (4.5") in diameter x 40mm (1.6") deep
- LAMPING: 1.5w LED or 10w xenon
- COAX: adjustable. 3000mm (10') standard / up to 30500mm (100') maximum
- MATERIALS: pulled glass, braided metal coaxial cable, electrical components, brushed nickel canopy
- WEIGHT: approximately 1.4kg (3lb)
- POWER SUPPLIES: integral. Power supplies included

DESCRIPTION

The deep canopy in this 87 variant refers to the canopy size depth capable of accommodating the power supply inside (standard outside of North America and Latin America). The deep canopy is 116mm (4.5") in diameter and 40mm (1.6") deep. It is designed for surface mounted applications that cannot make use of a junction box or ceiling cavity. The canopy is completely enclosed by a backplate, which houses the power supply. The pendant drop length on this light fixture is adjustable up to the specified maximum.

A matrix of hot glass is stretched and folded back onto itself numerous times as it cools. Air is trapped between the folds and stretched along the grain of the loop, creating microfilaments that give the piece a pearlescent optical quality. A light source is introduced at one end of the loop casting light through the microfilaments and registering a gentle gradient.

NOTES

- + Purchase replacement lamps online at www.bocci.com/shop/bulbs
- + Unless otherwise noted when ordering, all chandeliers will be outfitted to be xenon compatible.

Worldwide patents pending
EU Patent # 03611144 - 0005-0009

Made in Vancouver, Canada

Vancouver
sales@bocci.com
www.bocci.com

Berlin
europe@bocci.com
www.bocci.com

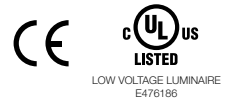

SWAG - DEEP CANOPY

87.1 Design by Omer Arbel
PRODUCT SPECIFICATION

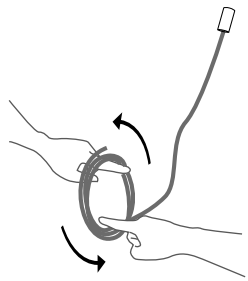

1

Very carefully uncoil the braided coaxial cable in a spool like manner. Insert your index fingers into opposite sides of the roll then rotate your fingers around each other to unroll the coaxial cable.

Use patience: allow the cable to uncoil completely to avoid kinks.

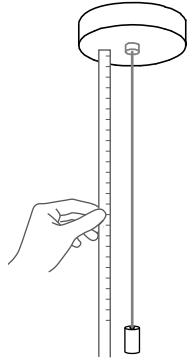

2

Determine the overall drop for the pendant fixture.

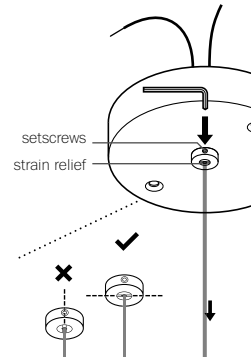

3

Thread the coaxial cable through the canopy, use a 2mm Allen key to loosen the setscrew in the canopy and gently feed the cable through until you have reached your desired drop length.

Use Allen key to tighten the setscrew to hold the strain relief and secure the coaxial cable at its new length. Perform a gentle tug test to ensure it is secure.

DO NOT OVERTIGHTEN.

Note: The strain relief is a black plastic collar around the coaxial cable. There is a single slot opening on the side of the strain relief component. It is essential that this opening is oriented at 90 degrees to set screw chamber. There can be no contact between the set screw and the cable.

RISK OF ELECTRIC SHORT!

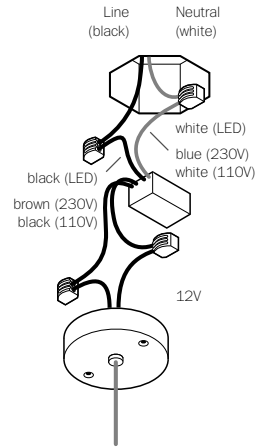

4

Xenon (110V) or LED: connect the black wire to black and white wire to white wire.

Xenon (230V): connect black wire to brown wire and white wire to blue wire.

Connect the coaxial cable to the open slots in the terminal block on the 12V side of the power supplies.

For multiple pendant installations, ensure that the braided outer wires are all connected to one 12V output wire and all inner insulated wires are connected to the other or a short will occur.

Once all coaxial connections are made, lift the fixture into position and connect the line voltage to the open slot in the appropriate terminal block.

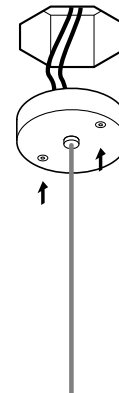

5

The client is responsible to ensure fasteners are attached to a robust structural substrate.

Tuck the power supply and wiring into the canopy. Line up the fastener holes or connect directly to structural ceiling surface using the fasteners provided.

Turn power to fixture on.

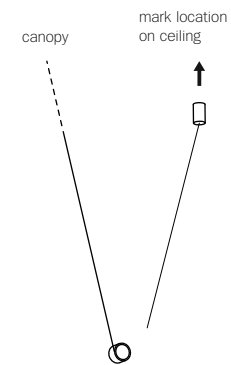

6

Check that each lamp is working properly as you go along.

Move pendant into location and mark the location for the swag hook screw on the ceiling.

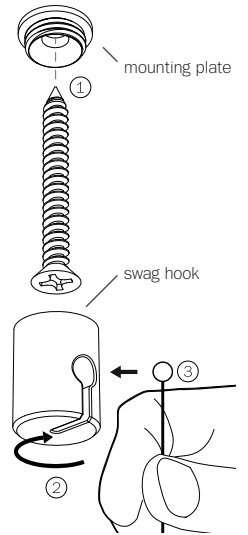

7

Ensure that the ceiling at the swag location is strong enough to hold 2kg (5lbs) before attaching swag hook with the provided screws.

Thread the swag hook on to the mounting plate, ensuring all the threads are engaged.

Slide the ball end of the aircraft into the slot on the swag hook.

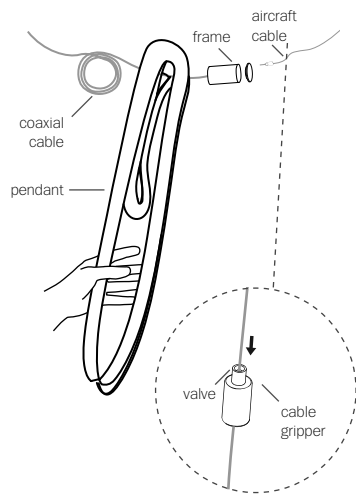

8

Push the valve on the cable gripper and adjust the position of the cable gripper so that the aircraft cable is roughly the same length as the coaxial cable.

Apply a load to the cable to ensure it is locked.

Thread the frame assembly through the top hole of the 87 pendant.

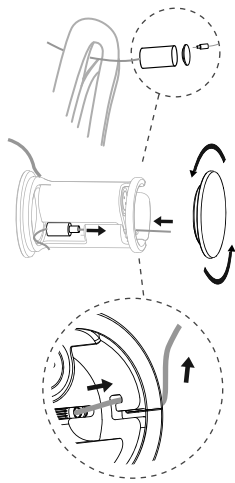

9

Unscrew frame cap opposite to the coaxial cable. Hook the cable gripper into the pocket inside the frame and guide the cable through the u-shaped hook in the frame and the silicone tube.

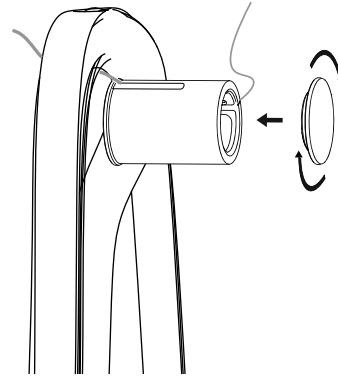

10

Screw frame cap back onto the frame assembly.

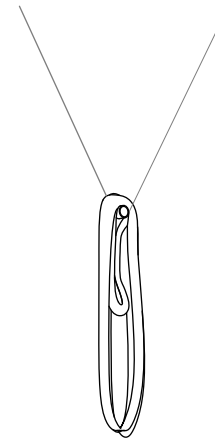

11

Rest pendant onto frame assembly.

If needed, repeat step 8 to adjust the position of frame.

Note: Frame assembly should hang level. The swag cable and the coaxial cable should be approximately the same length.

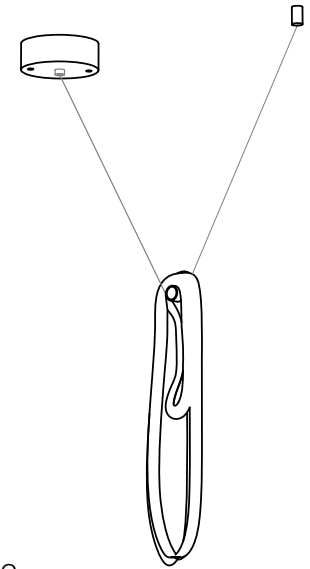

12

Clean fingerprints from surfaces.

For additional assistance, please contact Bocci:

Vancouver
sales@bocci.com
www.bocci.com

Berlin
europe@bocci.com
www.bocci.com

Worldwide patents pending
EU Patent # 03611144 - 0005-0009

Made in Vancouver, Canada



LOW VOLTAGE LUMINAIRE
E476186

SWAG - DEEP CANOPY

87.1

Design by Omer Arbel
PRODUCT INSTALLATION INSTRUCTIONS

© 2020, Bocci Design and Manufacturing Inc. All rights reserved. Any inquiries should be directed to: info@bocci.com

BOCCI

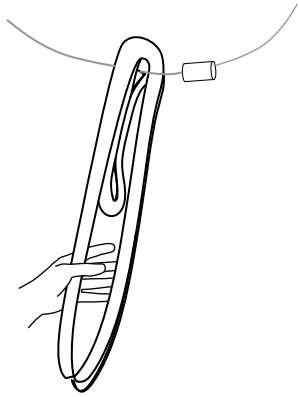

1

Lift glass off of lamp holder assembly and hold securely.

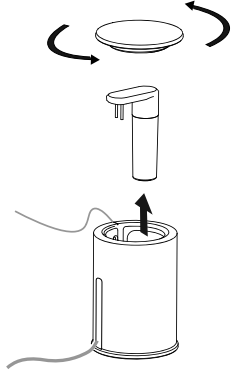

2

Unscrew cap at the aircraft cable end of the lamp holder assembly. Push coaxial cable through the slot in the silicone sheath, and remove lamp and lamp adapter.



3

Remove lamp from lamp adapter and replace with new bulb.

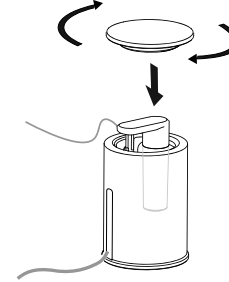

4

Screw cap back onto the lamp holder assembly.

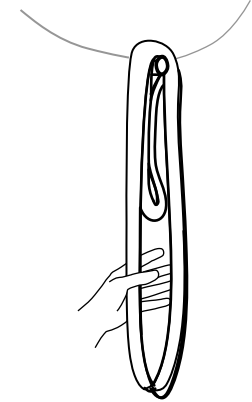

5

Gently rest pendant back onto lamp holder assembly.

Clean fingerprints from glass surfaces.

Turn power to fixture on.

For additional assistance,
please contact Bocci:

Vancouver
sales@bocci.com
www.bocci.com

Berlin
europe@bocci.com
www.bocci.com

Worldwide patents pending
EU Patent # 03611144 - 0005-0009

Made in Vancouver, Canada



LOW VOLTAGE LUMINAIRE
E476186

SWAG - DEEP CANOPY

87.1

Design by Omer Arbel
LAMP REPLACEMENT INSTRUCTIONS

© 2020, Bocci Design and Manufacturing Inc. All rights reserved. Any inquiries should be directed to: info@bocci.com

BOCCI

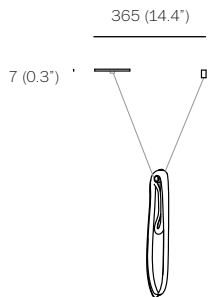
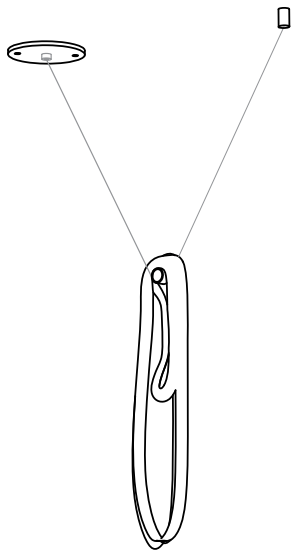

adjustable
up to 3000 (10')
standard

adjustable
up to 30500
(100')
custom

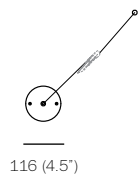

363 (14.3')

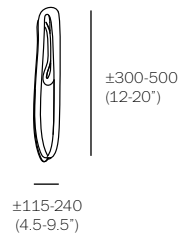

approx 1.4kg (3lb)

- PENDANTS: one
- MOUNTING: shallow brushed nickel canopy 116mm (4.5") in diameter x 7mm (0.3") deep
- LAMPING: 1.5w LED or 10w xenon
- COAX: adjustable. 3000mm (10') standard / up to 30500mm (100') maximum
- MATERIALS: pulled glass, braided metal coaxial cable, electrical components, brushed nickel canopy
- WEIGHT: approximately 1.4kg (3lb)
- POWER SUPPLIES: integral (power supply housed within junction box). Power supplies included

DESCRIPTION

The 87.1 shallow canopy is a single 87 pendant fixture with a shallow brushed nickel canopy designed to fit over a new or existing 4" octagonal junction box. The canopy is 116mm (4.5") in diameter and 7mm (0.3") deep, which creates a subtle profile that minimizes the impact in the application surface. The pendant drop length on this light fixture is adjustable up to the specified maximum.

A matrix of hot glass is stretched and folded back onto itself numerous times as it cools. Air is trapped between the folds and stretched along the grain of the loop, creating microfilaments that give the piece a pearlescent optical quality. A light source is introduced at one end of the loop casting light through the microfilaments and registering a gentle gradient.

NOTES

- + Purchase replacement lamps online at www.bocci.com/shop/bulbs
- + Unless otherwise noted when ordering, all chandeliers will be outfitted to be xenon compatible.

Worldwide patents pending
EU Patent # 03611144 - 0005-0009

Made in Vancouver, Canada

Vancouver
sales@bocci.com
www.bocci.com

Berlin
europe@bocci.com
www.bocci.com

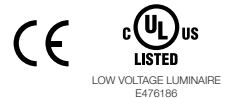

SWAG - SHALLOW CANOPY

87.1

Design by Omer Arbel
PRODUCT SPECIFICATION

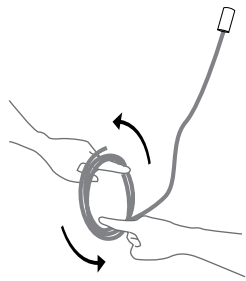

1

Very carefully uncoil the braided coaxial cable in a spool like manner. Insert your index fingers into opposite sides of the roll then rotate your fingers around each other to unroll the coaxial cable.

Use patience: allow the cable to uncoil completely to avoid kinks.

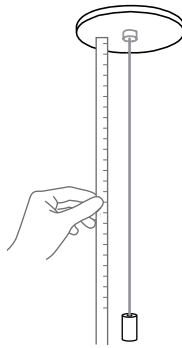

2

Determine the overall drop for the pendant fixture.

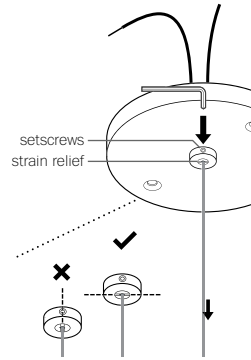

3

Thread the coaxial cable through the canopy, use a 2mm Allen key to loosen the setscrew in the canopy and gently feed the cable through until you have reached your desired drop length.

Use Allen key to tighten the setscrew to hold the strain relief and secure the coaxial cable at its new length. Perform a gentle tug test to ensure it is secure.

DO NOT OVERTIGHTEN.

Note: The strain relief is a black plastic collar around the coaxial cable. There is a single slot opening on the side of the strain relief component. It is essential that this opening is oriented at 90 degrees to set screw chamber. There can be no contact between the set screw and the cable.

RISK OF ELECTRIC SHORT!

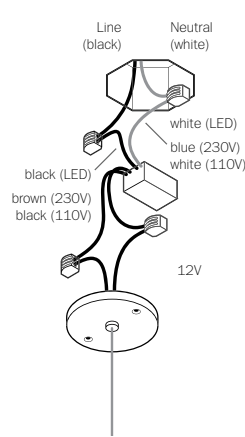

4

Xenon (110V) or LED: connect the black wire to black and white wire to white wire.

Xenon (230V): connect black wire to brown wire and white wire to blue wire.

Connect the coaxial cable to the open slots in the terminal block on the 12V side of the power supplies.

For multiple pendant installations, ensure that the braided outer wires are all connected to one 12V output wire and all inner insulated wires are connected to the other or a short will occur.

Once all coaxial connections are made, lift the fixture into position and connect the line voltage to the open slot in the appropriate terminal block.

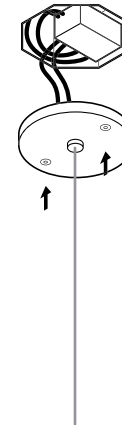

5

The client is responsible to ensure fasteners are attached to a robust structural substrate.

Tuck the power supply and wiring into the octagonal box, if available, and place canopy over top, lining up the fastener holes or connecting directly to structural ceiling surface. Affix canopy with fasteners provided.

Turn power to fixture on.

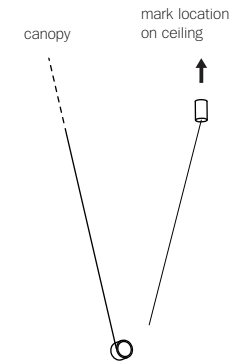

6

Check that each lamp is working properly as you go along.

Move pendant into location and mark the location for the swag hook screw on the ceiling.

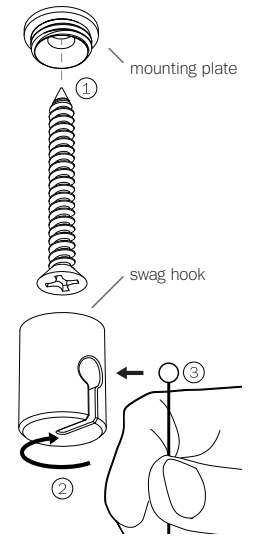

7

Ensure that the ceiling at the swag location is strong enough to hold 2kg (5lbs) before attaching swag hook with the provided screws.

Thread the swag hook on to the mounting plate, ensuring all the threads are engaged.

Slide the ball end of the aircraft into the slot on the swag hook.

SWAG - SHALLOW CANOPY

87.1

Design by Omer Arbel
PRODUCT INSTALLATION INSTRUCTIONS

© 2020, Bocci Design and Manufacturing Inc. All rights reserved. Any inquiries should be directed to: info@bocci.com

BOCCI

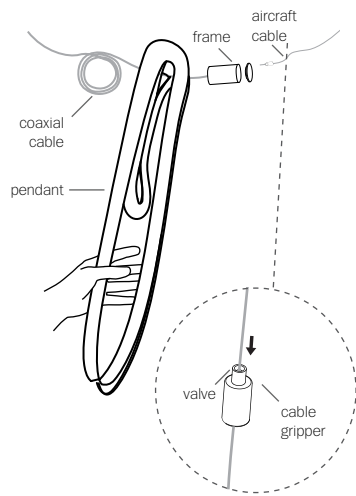

8

Push the valve on the cable gripper and adjust the position of the cable gripper so that the aircraft cable is roughly the same length as the coaxial cable.

Apply a load to the cable to ensure it is locked.

Thread the frame assembly through the top hole of the 87 pendant.

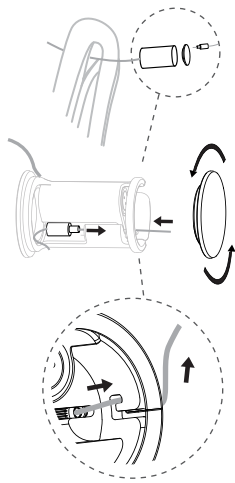

9

Unscrew frame cap opposite to the coaxial cable. Hook the cable gripper into the pocket inside the frame and guide the cable through the u-shaped hook in the frame and the silicone tube.

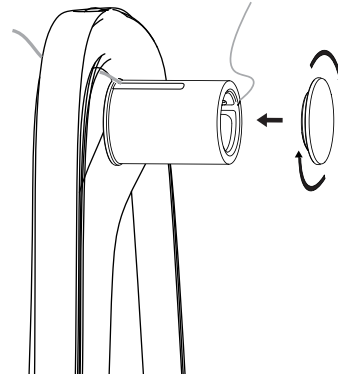

10

Screw frame cap back onto the frame assembly.

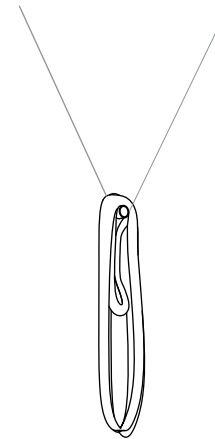

11

Rest pendant onto frame assembly.

If needed, repeat step 8 to adjust the position of frame.

Note: Frame assembly should hang level. The swag cable and the coaxial cable should be approximately the same length.

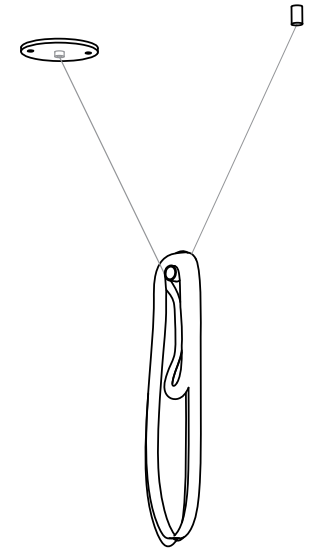

12

Clean fingerprints from surfaces.

For additional assistance, please contact Bocci:

Vancouver
sales@bocci.com
www.bocci.com

Berlin
europe@bocci.com
www.bocci.com

Worldwide patents pending
EU Patent # 03611144 - 0005-0009

Made in Vancouver, Canada



LOW VOLTAGE LUMINAIRE
E476186

SWAG - SHALLOW CANOPY

87.1

Design by Omer Arbel
PRODUCT INSTALLATION INSTRUCTIONS

© 2020, Bocci Design and Manufacturing Inc. All rights reserved. Any inquiries should be directed to: info@bocci.com

BOCCI

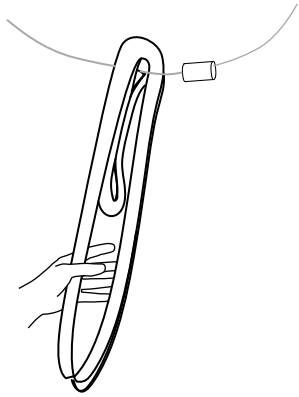

1

Lift glass off of lamp holder assembly and hold securely.

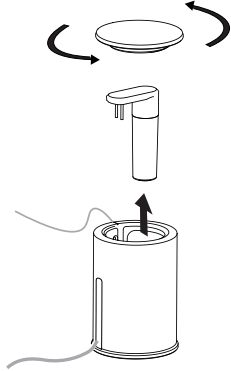

2

Unscrew cap at the aircraft cable end of the lamp holder assembly. Push coaxial cable through the slot in the silicone sheath, and remove lamp and lamp adapter.



3

Remove lamp from lamp adapter and replace with new bulb.

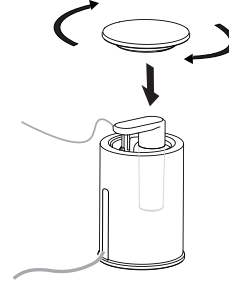

4

Screw cap back onto the lamp holder assembly.

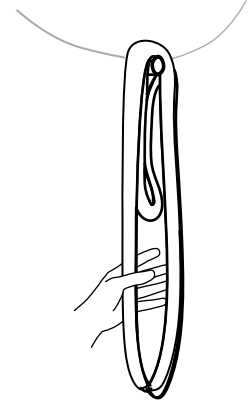

5

Gently rest pendant back onto lamp holder assembly.

Clean fingerprints from glass surfaces.

Turn power to fixture on.

For additional assistance,
please contact Bocci:

Vancouver
sales@bocci.com
www.bocci.com

Berlin
europe@bocci.com
www.bocci.com

Worldwide patents pending
EU Patent # 03611144 - 0005-0009

Made in Vancouver, Canada



LOW VOLTAGE LUMINAIRE
E476186

SWAG - SHALLOW CANOPY

87.1

Design by Omer Arbel
LAMP REPLACEMENT INSTRUCTIONS

© 2020, Bocci Design and Manufacturing Inc. All rights reserved. Any inquiries should be directed to: info@bocci.com

BOCCI

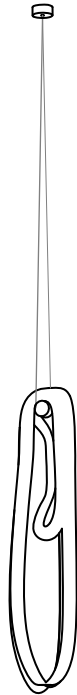

11
(0.4")

adjustable
up to 3000
(10')
standard

adjustable
up to 30500
(100')
custom



30 (1.2")



±300-500
(12-20')

±115-240
(4.5-9.5')

MINI CANOPY

87.1m

Design by Omer Arbel
PRODUCT SPECIFICATION

- PENDANTS: one
- MOUNTING: mini canopy 30mm (1.2") in diameter x 11mm (0.4") deep
- LAMPING: 1.5w LED or 10w xenon
- COAX: adjustable. 3000mm (10') standard / up to 30500mm (100') maximum
- MATERIALS: pulled glass, braided metal coaxial cable, electrical components, brushed nickel canopy
- WEIGHT: approximately 1.4kg (3lb)
- POWER SUPPLIES: remote mounted (fixture does not hook directly to a junction box). Power supplies included

DESCRIPTION

The 'm' designation in this 87 variant refers to the mini canopy size. The mini canopy is just over 30mm (1.2") in diameter and 11mm (0.4") deep, which creates a subtle profile that will essentially disappear into the application surface. The pendant drop length on this light fixture is adjustable up to the specified maximum.

A matrix of hot glass is stretched and folded back onto itself numerous times as it cools. Air is trapped between the folds and stretched along the grain of the loop, creating microfilaments that give the piece a pearlescent optical quality. A LED light source is introduced at one end of the loop casting light through the microfilaments and registering a gentle gradient.

NOTES

- + Purchase replacement lamps online at www.bocci.com/shop/bulbs
- + Unless otherwise noted when ordering, all chandeliers will be outfitted to be xenon compatible.
- + Unless otherwise specified, a single class 2 power supply will be sent for every 5 xenon fixtures or every 12 LED fixtures
- + Requires power supplies to be remote mounted

Worldwide patents pending
EU Patent # 03611144 - 0005-0009

Made in Vancouver, Canada

Vancouver
sales@bocci.com
www.bocci.com

Berlin
europe@bocci.com
www.bocci.com

approx 1.4kg (3lb)

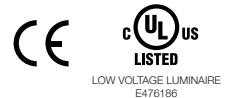

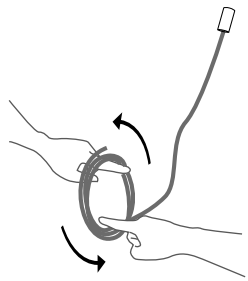

1

Very carefully uncoil the braided coaxial cable in a spool like manner. Insert your index fingers into opposite sides of the roll then rotate your fingers around each other to unroll the coaxial cable.

Use patience: allow the cable to uncoil completely to avoid kinks.

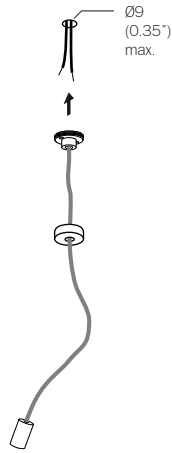

2

Drill a maximum 9mm (0.35") diameter hole in ceiling material. Pull low voltage house wire through the hole.

Note: There MUST be adequate backing, not just the drywall. This low voltage wire will run to a remote mounted power supply.

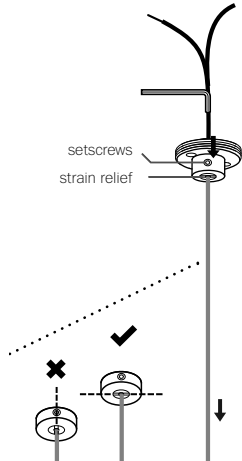

3

Thread the coaxial cable through the canopy, use a 2mm Allen key to loosen the setscrew in the canopy and gently feed the cable through until you have reached your desired drop length.

Use Allen key to tighten the setscrew to hold the strain relief and secure the coaxial cable at its new length. Perform a gentle tug test to ensure it is secure.

DO NOT OVERTIGHTEN.

Note: The strain relief is a black plastic collar around the coaxial cable. There is a single slot opening on the side of the strain relief component. It is essential that this opening is oriented at 90 degrees to set screw chamber. There can be no contact between the set screw and the cable.

RISK OF ELECTRIC SHORT!

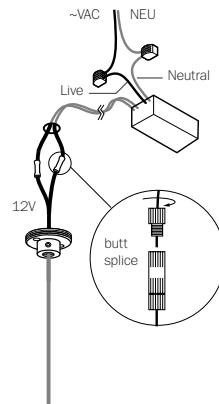

4

Primary: connect live and neutral power supply leads to supply wiring. Line with Live wire and Neutral with Neutral.

Secondary: Connect (+/-) wires to the coaxial cable using #16 butt splices, provided (stagger the splices).

For multiple pendant installations, ensure that the braided outer wires are all connected to one 12V output wire and all inner insulated wires are connected to the other or a short will occur.

Wires are 1.02mm (18AWG).

Note: Insulated core is positive and braided exterior is negative.

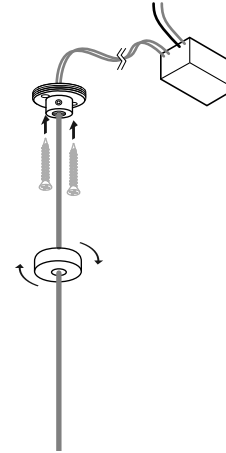

5

The client is responsible to ensure fasteners are attached to a robust structural substrate.

Affix mini-canopy to ceiling surface with fasteners provided. Twist the threaded cover into place.

Turn power to fixture on.

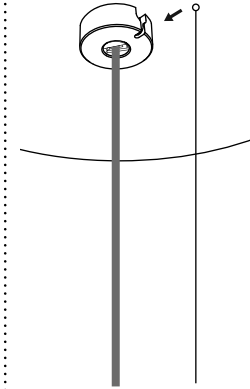

6

Check that each lamp is working properly as you go along.

On the canopy, there is a slot that will receive the ball on the end of aircraft cable. Slide ball end aircraft cable into the slot.

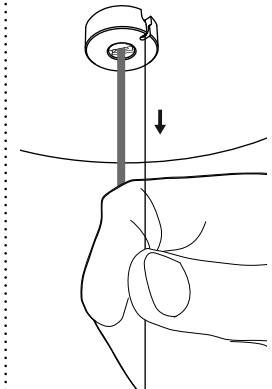

7

Pull it gently to make sure the aircraft cable is seated properly.

MINI CANOPY

87.1m

Design by Omer Arbel
PRODUCT INSTALLATION INSTRUCTIONS

© 2020, Bocci Design and Manufacturing Inc. All rights reserved. Any inquiries should be directed to: info@bocci.com

BOCCI

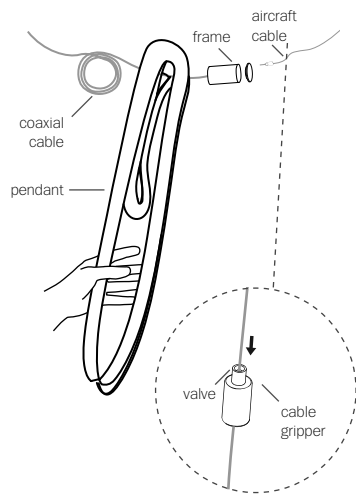

8

Push the valve on the cable gripper and adjust the position of the cable gripper so that the aircraft cable is roughly the same length as the coaxial cable.

Apply a load to the cable to ensure it is locked.

Thread the frame assembly through the top hole of the 87 pendant.

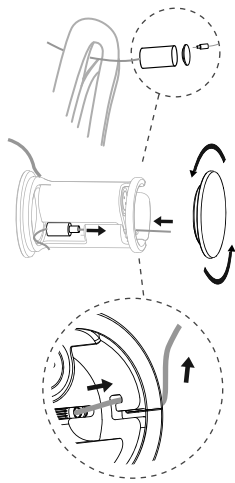

9

Unscrew frame cap opposite to the coaxial cable. Hook the cable gripper into the pocket inside the frame and guide the cable through the u-shaped hook in the frame and the silicone tube.

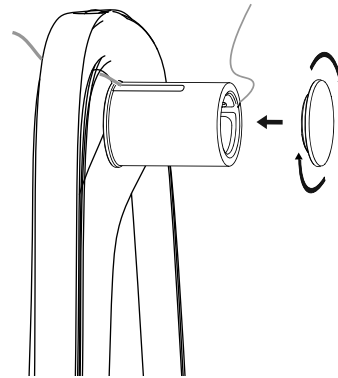

10

Screw frame cap back onto the frame assembly.



11

Rest pendant onto frame assembly.

If needed, repeat step 8 to adjust the position of frame.

Note: Frame assembly should hang level. The swag cable and the coaxial cable should be approximately the same length.



12

Clean fingerprints from surfaces.

For additional assistance, please contact Bocci:

Vancouver
sales@bocci.com
www.bocci.com

Berlin
europe@bocci.com
www.bocci.com

Worldwide patents pending
EU Patent # 03611144 - 0005-0009

Made in Vancouver, Canada



LOW VOLTAGE LUMINAIRE
E476186

MINI CANOPY

87.1m

Design by Omer Arbel
PRODUCT INSTALLATION INSTRUCTIONS

© 2020, Bocci Design and Manufacturing Inc. All rights reserved. Any inquiries should be directed to: info@bocci.com

BOCCI

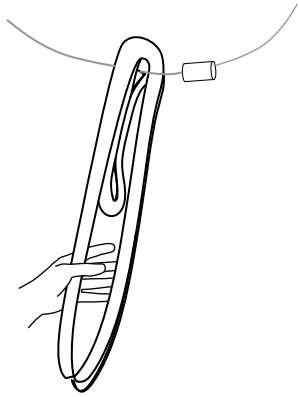

1

Lift glass off of lamp holder assembly and hold securely.

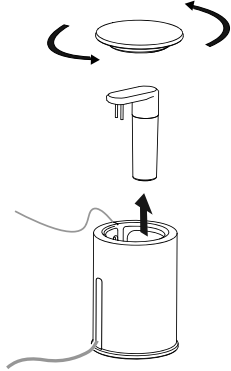

2

Unscrew cap at the aircraft cable end of the lamp holder assembly. Push coaxial cable through the slot in the silicone sheath, and remove lamp and lamp adapter.



3

Remove lamp from lamp adapter and replace with new bulb.

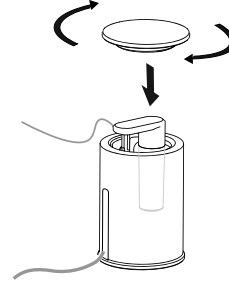

4

Screw cap back onto the lamp holder assembly.

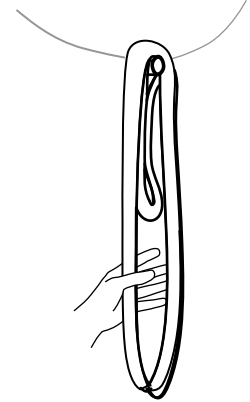

5

Gently rest pendant back onto lamp holder assembly.

Clean fingerprints from glass surfaces.

Turn power to fixture on.

For additional assistance,
please contact Bocci:

Vancouver
sales@bocci.com
www.bocci.com

Berlin
europe@bocci.com
www.bocci.com

Worldwide patents pending
EU Patent # 03611144 - 0005-0009

Made in Vancouver, Canada



LOW VOLTAGE LUMINAIRE
E476186

MINI CANOPY

87.1m

Design by Omer Arbel
LAMP REPLACEMENT INSTRUCTIONS

© 2020, Bocci Design and Manufacturing Inc. All rights reserved. Any inquiries should be directed to: info@bocci.com

BOCCI

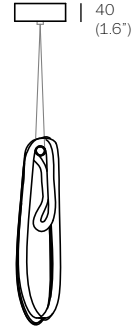

adjustable
up to 3000
(10')
standard

adjustable
up to 30500
(100')
custom



116 (4.5")



±300-500
(12-20')

±115-240
(4.5-9.5')

- PENDANTS: one
- MOUNTING: deep brushed nickel canopy 116mm (4.5") in diameter x 40mm (1.6") deep
- LAMPING: 1.5w LED or 10w xenon
- COAX: adjustable. 3000mm (10') standard / up to 30500mm (100') maximum
- MATERIALS: pulled glass, braided metal coaxial cable, electrical components, brushed nickel canopy
- WEIGHT: approximately 1.4kg (3lb)
- POWER SUPPLIES: integral. Power supplies included

DESCRIPTION

The deep canopy in this 87 variant refers to the canopy depth capable of accommodating a power supply inside (standard outside of North America and Latin America). The deep canopy is 116mm (4.5") in diameter and 40mm (1.6") deep. It is designed for surface mounted applications that cannot make use of a junction box or ceiling cavity. The canopy is completely enclosed by a backplate, which houses the power supply. The pendant drop length on this light fixture is adjustable up to the specified maximum.

A matrix of hot glass is stretched and folded back onto itself numerous times as it cools. Air is trapped between the folds and stretched along the grain of the loop, creating microfilaments that give the piece a pearlescent optical quality. A LED light source is introduced at one end of the loop casting light through the microfilaments and registering a gentle gradient.

NOTES

- + Purchase replacement lamps online at www.bocci.com/shop/bulbs
- + Unless otherwise noted when ordering, all chandeliers will be outfitted to be xenon compatible.

Worldwide patents pending
EU Patent # 03611144 - 0005-0009

Made in Vancouver, Canada

Vancouver
sales@bocci.com
www.bocci.com

Berlin
europe@bocci.com
www.bocci.com

approx 1.4kg (3lb)

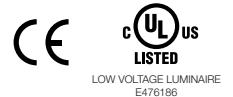

DEEP CANOPY

87.1

Design by Omer Arbel
PRODUCT SPECIFICATION

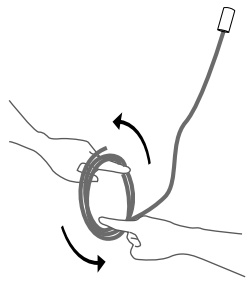

1

Very carefully uncoil the braided coaxial cable in a spool like manner. Insert your index fingers into opposite sides of the roll then rotate your fingers around each other to unroll the coaxial cable.

Use patience: allow the cable to uncoil completely to avoid kinks.

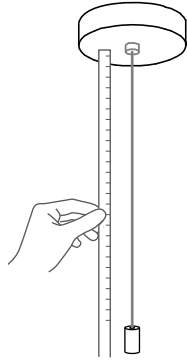

2

Determine the overall drop for the pendant fixture.

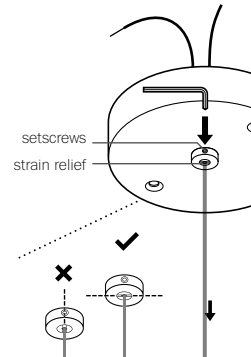

3

Thread the coaxial cable through the canopy, use a 2mm Allen key to loosen the setscrew in the canopy and gently feed the cable through until you have reached your desired drop length.

Use Allen key to tighten the setscrew to hold the strain relief and secure the coaxial cable at its new length. Perform a gentle tug test to ensure it is secure.

DO NOT OVERTIGHTEN.

Note: The strain relief is a black plastic collar around the coaxial cable. There is a single slot opening on the side of the strain relief component. It is essential that this opening is oriented at 90 degrees to set screw chamber. There can be no contact between the set screw and the cable.

RISK OF ELECTRIC SHORT!

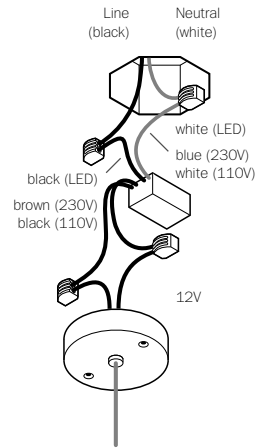

4

Xenon (110V) or LED: connect the black wire to black and white wire to white wire.

Xenon (230V): connect black wire to brown wire and white wire to blue wire.

Connect the coaxial cable to the open slots in the terminal block on the 12V side of the power supplies.

For multiple pendant installations, ensure that the braided outer wires are all connected to one 12V output wire and all inner insulated wires are connected to the other or a short will occur.

Once all coaxial connections are made, lift the fixture into position and connect the line voltage to the open slot in the appropriate terminal block.

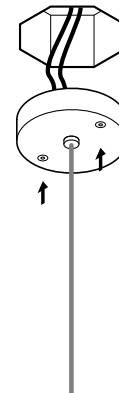

5

The client is responsible to ensure fasteners are attached to a robust structural substrate.

Tuck the power supply and wiring into the canopy. Line up the fastener holes or connect directly to structural ceiling surface using the fasteners provided.

Turn power to fixture on.

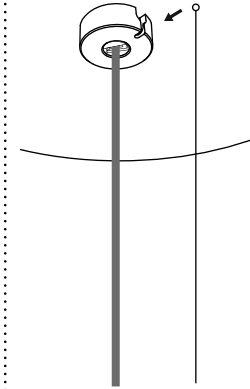

6

Check that each lamp is working properly as you go along.

On the canopy, there is a slot that will receive the ball on the end of aircraft cable. Slide ball end aircraft cable into the slot.

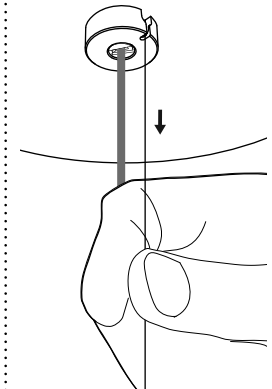

7

Pull it gently to make sure the aircraft cable is seated properly.

DEEP CANOPY

87.1

Design by Omer Arbel
PRODUCT INSTALLATION INSTRUCTIONS

© 2020, Bocci Design and Manufacturing Inc. All rights reserved. Any inquiries should be directed to: info@bocci.com

BOCCI

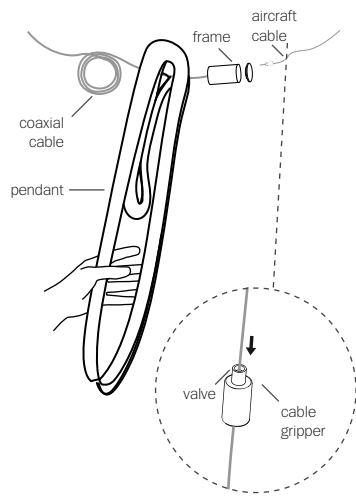

8

Push the valve on the cable gripper and adjust the position of the cable gripper so that the aircraft cable is roughly the same length as the coaxial cable.

Apply a load to the cable to ensure it is locked.

Thread the frame assembly through the top hole of the 87 pendant.

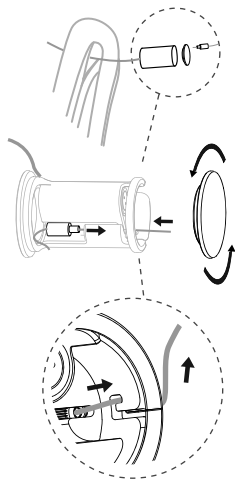

9

Unscrew frame cap opposite to the coaxial cable. Hook the cable gripper into the pocket inside the frame and guide the cable through the u-shaped hook in the frame and the silicone tube.

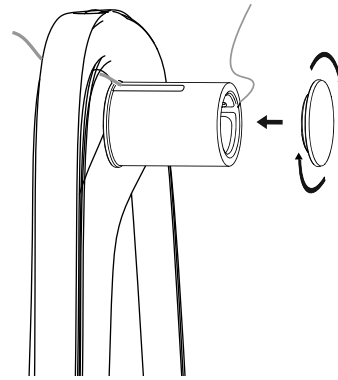

10

Screw frame cap back onto the frame assembly.



11

Rest pendant onto frame assembly.

If needed, repeat step 8 to adjust the position of frame.

Note: Frame assembly should hang level. The swag cable and the coaxial cable should be approximately the same length.



12

Clean fingerprints from surfaces.

For additional assistance, please contact Bocci:

Vancouver
sales@bocci.com
www.bocci.com

Berlin
europe@bocci.com
www.bocci.com

Worldwide patents pending
EU Patent # 03611144 - 0005-0009

Made in Vancouver, Canada



LOW VOLTAGE LUMINAIRE
E476186

DEEP CANOPY

87.1

Design by Omer Arbel
PRODUCT INSTALLATION INSTRUCTIONS

© 2020, Bocci Design and Manufacturing Inc. All rights reserved. Any inquiries should be directed to: info@bocci.com

BOCCI

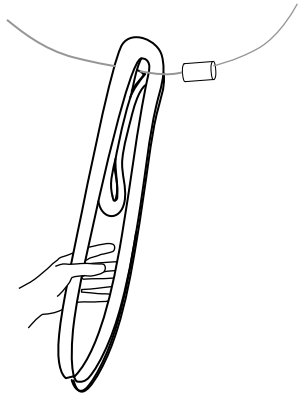

1

Lift glass off of lamp holder assembly and hold securely.

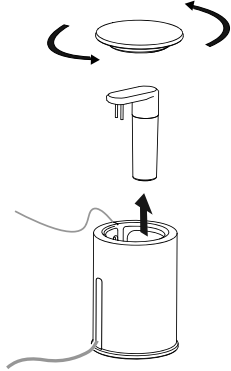

2

Unscrew cap at the aircraft cable end of the lamp holder assembly. Push coaxial cable through the slot in the silicone sheath, and remove lamp and lamp adapter.



3

Remove lamp from lamp adapter and replace with new bulb.

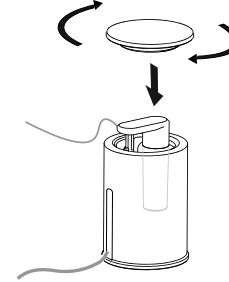

4

Screw cap back onto the lamp holder assembly.

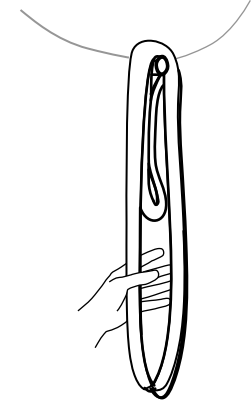

5

Gently rest pendant back onto lamp holder assembly.

Clean fingerprints from glass surfaces.

Turn power to fixture on.

For additional assistance,
please contact Bocci:

Vancouver
sales@bocci.com
www.bocci.com

Berlin
europe@bocci.com
www.bocci.com

Worldwide patents pending
EU Patent # 03611144 - 0005-0009

Made in Vancouver, Canada



LOW VOLTAGE LUMINAIRE
E476186

DEEP CANOPY

87.1

Design by Omer Arbel
LAMP REPLACEMENT INSTRUCTIONS

© 2020, Bocci Design and Manufacturing Inc. All rights reserved. Any inquiries should be directed to: info@bocci.com

BOCCI

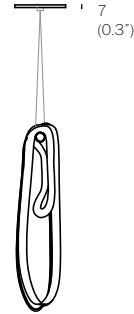
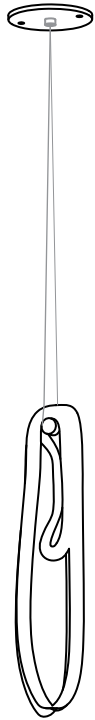

7
(0.3")
adjustable
up to 3000
(10')
standard

adjustable
up to 30500
(100')
custom



116 (4.5")



±115-240
(4.5-9.5")

±300-500
(12-20')

- PENDANTS: one
- MOUNTING: shallow brushed nickel canopy 116mm (4.5") in diameter x 7mm (0.3") deep
- LAMPING: 1.5w LED or 10w xenon
- COAX: adjustable. 3000mm (10') standard / up to 30500mm (100') maximum
- MATERIALS: pulled glass, braided metal coaxial cable, electrical components, brushed nickel canopy
- WEIGHT: approximately 1.4kg (3lb)
- POWER SUPPLIES: integral (power supply housed within junction box). Power supplies included

DESCRIPTION

The 87.1 shallow canopy is a single 87 pendant fixture with a shallow brushed nickel canopy designed to fit over a new or existing 4" octagonal junction box. The canopy is 116mm (4.5") in diameter and 7mm (0.3") deep, which creates a subtle profile that minimizes the impact in the application surface. The pendant drop length on this light fixture is adjustable up to the specified maximum.

A matrix of hot glass is stretched and folded back onto itself numerous times as it cools. Air is trapped between the folds and stretched along the grain of the loop, creating microfilaments that give the piece a pearlescent optical quality. A light source is introduced at one end of the loop casting light through the microfilaments and registering a gentle gradient.

NOTES

- + Purchase replacement lamps online at www.bocci.com/shop/bulbs
- + Unless otherwise noted when ordering, all fixtures will be outfitted to be xenon compatible

Worldwide patents pending
EU Patent # 03611144 - 0005-0009

Made in Vancouver, Canada

Vancouver
sales@bocci.com
www.bocci.com

Berlin
europe@bocci.com
www.bocci.com

approx 1.4kg (3lb)

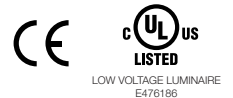

SHALLOW CANOPY

87.1

Design by Omer Arbel
PRODUCT SPECIFICATION

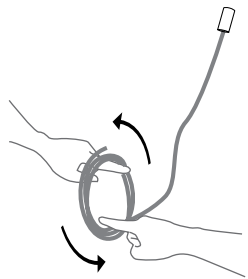

1

Very carefully uncoil the braided coaxial cable in a spool like manner. Insert your index fingers into opposite sides of the roll then rotate your fingers around each other to unroll the coaxial cable.

Use patience: allow the cable to uncoil completely to avoid kinks.

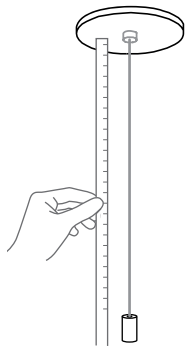

2

Determine the overall drop for the pendant fixture.

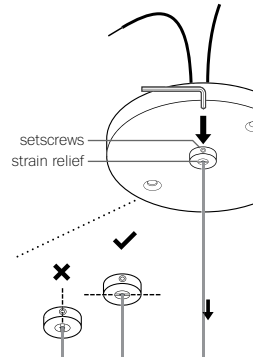

3

Thread the coaxial cable through the canopy, use a 2mm Allen key to loosen the setscrew in the canopy and gently feed the cable through until you have reached your desired drop length.

Use Allen key to tighten the setscrew to hold the strain relief and secure the coaxial cable at its new length. Perform a gentle tug test to ensure it is secure.

DO NOT OVERTIGHTEN.

Note: The strain relief is a black plastic collar around the coaxial cable. There is a single slot opening on the side of the strain relief component. It is essential that this opening is oriented at 90 degrees to set screw chamber. There can be no contact between the set screw and the cable.

RISK OF ELECTRIC SHORT!

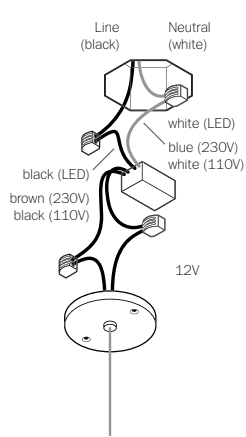

4

Xenon (110V) or LED: connect the black wire to black and white wire to white wire.

Xenon (230V): connect black wire to brown wire and white wire to blue wire.

Connect the coaxial cable to the open slots in the terminal block on the 12V side of the power supplies.

For multiple pendant installations, ensure that the braided outer wires are all connected to one 12V output wire and all inner insulated wires are connected to the other or a short will occur.

Once all coaxial connections are made, lift the fixture into position and connect the line voltage to the open slot in the appropriate terminal block.

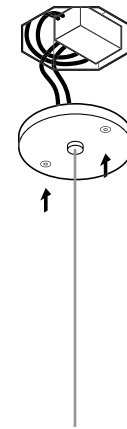

5

The client is responsible to ensure fasteners are attached to a robust structural substrate.

Tuck the power supply and wiring into the octagonal box, if available, and place canopy over top, lining up the fastener holes or connecting directly to structural ceiling surface. Affix canopy with fasteners provided.

Turn power to fixture on.

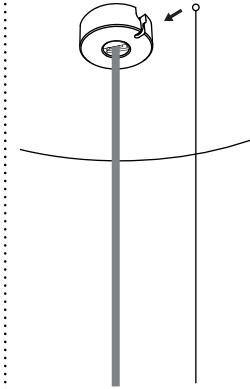

6

Check that each lamp is working properly as you go along.

On the canopy, there is a slot that will receive the ball on the end of aircraft cable. Slide ball end aircraft cable into the slot.

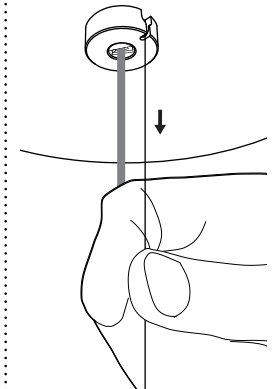

7

Pull it gently to make sure the aircraft cable is seated properly.

SHALLOW CANOPY

87.1

Design by Omer Arbel
PRODUCT INSTALLATION INSTRUCTIONS

© 2020, Bocci Design and Manufacturing Inc. All rights reserved. Any inquiries should be directed to: info@bocci.com

BOCCI

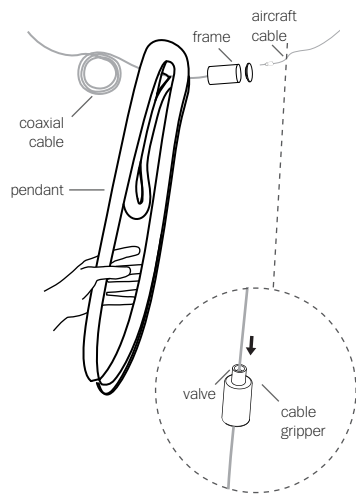

8

Push the valve on the cable gripper and adjust the position of the cable gripper so that the aircraft cable is roughly the same length as the coaxial cable.

Apply a load to the cable to ensure it is locked.

Thread the frame assembly through the top hole of the 87 pendant.

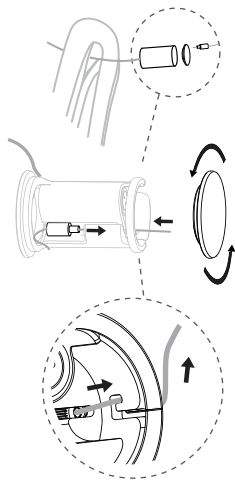

9

Unscrew frame cap opposite to the coaxial cable. Hook the cable gripper into the pocket inside the frame and guide the cable through the u-shaped hook in the frame and the silicone tube.

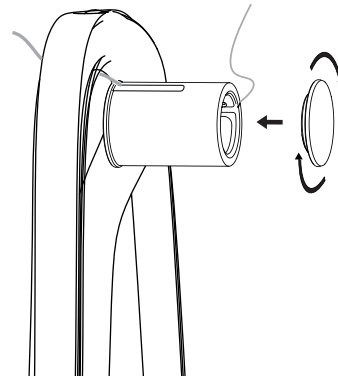

10

Screw frame cap back onto the frame assembly.



11

Rest pendant onto frame assembly.

If needed, repeat step 8 to adjust the position of frame.

Note: Frame assembly should hang level. The swag cable and the coaxial cable should be approximately the same length.



12

Clean fingerprints from surfaces.

For additional assistance, please contact Bocci:

Vancouver
sales@bocci.com
www.bocci.com

Berlin
europe@bocci.com
www.bocci.com

Worldwide patents pending
EU Patent # 03611144 - 0005-0009

Made in Vancouver, Canada



LOW VOLTAGE LUMINAIRE
E476186

SHALLOW CANOPY

87.1

Design by Omer Arbel
PRODUCT INSTALLATION INSTRUCTIONS

© 2020, Bocci Design and Manufacturing Inc. All rights reserved. Any inquiries should be directed to: info@bocci.com

BOCCI

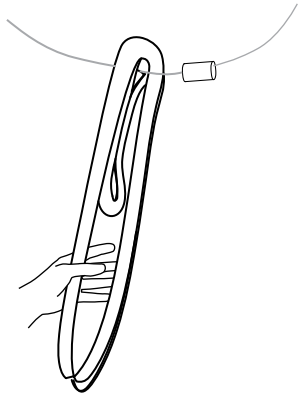

1

Lift glass off of lamp holder assembly and hold securely.

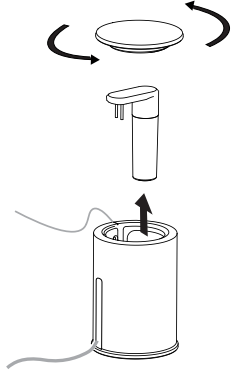

2

Unscrew cap at the aircraft cable end of the lamp holder assembly. Push coaxial cable through the slot in the silicone sheath, and remove lamp and lamp adapter.



3

Remove lamp from lamp adapter and replace with new bulb.

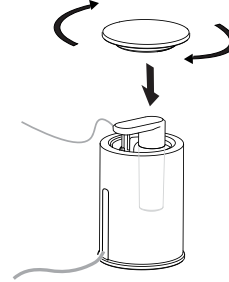

4

Screw cap back onto the lamp holder assembly.

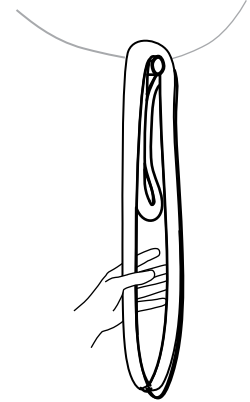

5

Gently rest pendant back onto lamp holder assembly.

Clean fingerprints from glass surfaces.

Turn power to fixture on.

For additional assistance,
please contact Bocci:

Vancouver
sales@bocci.com
www.bocci.com

Berlin
europe@bocci.com
www.bocci.com

Worldwide patents pending
EU Patent # 03611144 - 0005-0009

Made in Vancouver, Canada



LOW VOLTAGE LUMINAIRE
E476186

SHALLOW CANOPY

87.1

Design by Omer Arbel
LAMP REPLACEMENT INSTRUCTIONS

© 2020, Bocci Design and Manufacturing Inc. All rights reserved. Any inquiries should be directed to: info@bocci.com

BOCCI